

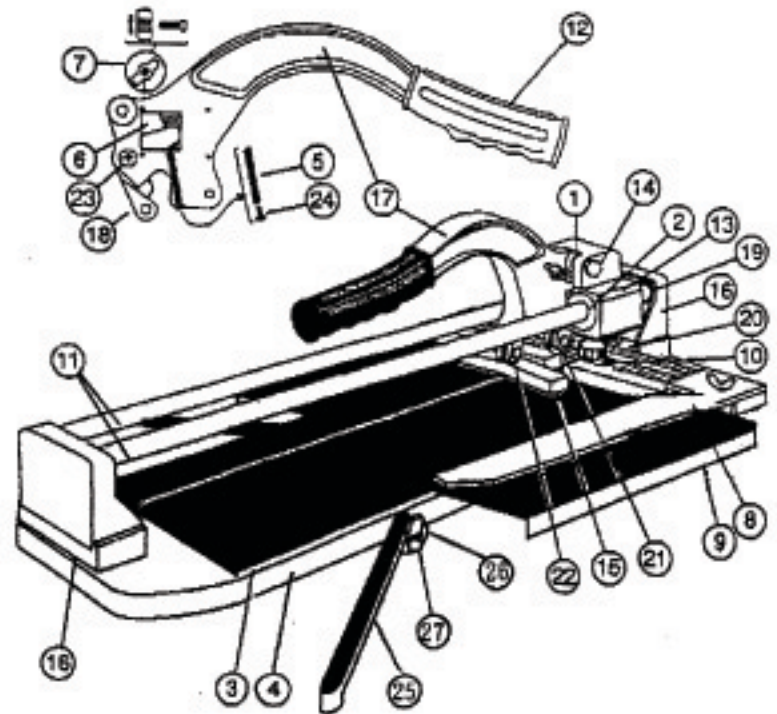

# No. 10700 28" Super Clinker Tile Cutter

## ORDER NO. DESCRIPTION

10700*	Box
10700-01	Pivot Arm Bearing
10700-02	Bearing Caps (2)
10700-03	Rubber Pads (2)
10700-04	Aluminum Base
10700-05	Wheel Holder Spring
10700-06	Adjustment Cam
10700-07	Cam Knob w/Washer & Screws
10700-08	300mm Wide Guide
10700-09	(150mm)6" x (300mm)12" Extentions (2pcs.)
10700-10	Wing Screw & Washer
10700-11	Rail Bars (2)
10700-12	Red Handle Grip
10700-13	Slide Assembly (Bearing Block)
10700-14	Bolt w/Bushing, Washer & Nut
10700-15	Breaker Bar
10700-16	Brackets
10700-17	Handle Assembly
10700-18	Wheel Holder
10700-19	Rubber Stoppers (2)
10700-20	Hex Bolt, Flat Washer, & Spring Washer
10700-21	6x25mm Hex. Bolt, 6mm Spring Washer, & Nut
10700-22	6x30mm Hex. Bolt, 6mm Spring Washer, & Nut
10700-23	6x16mm Flat Head Screw
10700-24	6x16mm Binding Head Screw
10700-25	(300mm)12" Long Aluminum Arms
10700-26	Aluminum Connector of Side Base
10700-27	White Round Head Screw
21119	7/8" Tungsten Carbide Ball Bearing Cutting Wheel



QEPParts.com  
888-634-4289

An iBuy Stores Company