

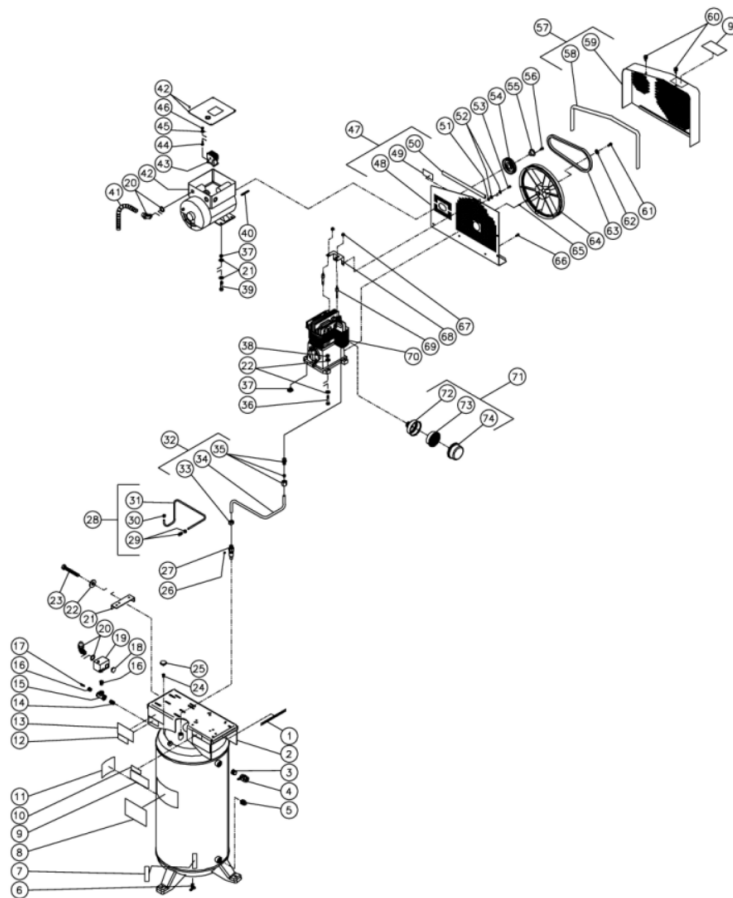

AC2-SE05-60M / AC2-SE05-60M (sn:20004966-99999999)

TANK ASSEMBLY



Id	Item #	Description	Quantity	Rev	Comments
1	N/A Sep.	DECAL- CHECK OIL TAPE (SEE 34-9016)	1		
2	12-0085A01	AIR TANK ASSEMBLY	1		
3	24-0200	NIPPLE	1		
4	22-0287	BALL VALVE	1		

Id	Item #	Description	Quantity	Rev	Comments
5	24-0219	PLUG	1		
6	23-0312	DRAIN VALVE	1		
7	N/A Sep.	DECAL- TANK DRAIN (SEE 34-9016)	3		
8	34-0814	DECAL- MI-T-M AIR COMPRESSOR	1		
9	N/A Sep.	DECAL- OPERATING INSTRUCTIONS (SEE 34-9016)	2		
10	N/A Sep.	DECAL- WARNING: HOT SURFACE (SEE 34-9016)	1		
11	N/A Sep.	DECAL- DANGER/WARNING/CAUTION (SEE 34-9016)	1		
12	N/A	DECAL- DATA PLATE	1		
13	N/A Sep.	DECAL- MAINTENANCE INSTRUCTIONS (SEE 34-9016)	1		
14	24-0174	NIPPLE	1		
15	24-0178	TEE	1		
16	23-0056	BUSHING	2		
17	22-0267	SAFETY RELIEF VALVE	1		
18	39-0014	PRESSURE SWITCH PLUG	1		
19	22-0277	PRESSURE SWITCH	1		
20	32-0254	CONDUIT ELBOW	2		
21	20-0461A01	BELT TENSIONER PLATE	1		
22	28-0023	WASHER	17		
23	27-0576	BOLT	1		
24	23-0111	BUSHING	1		
25	22-0271	PRESSURE GUAGE	1		
26	24-0082	PLUG	1		
27	22-0268	CHECK VALVE	1		
28	854-0042	TUBE ASSEMBLY (INCLUDES 29-31)	1		
29	23-0328	ADAPTER	1		
30	23-0315	COMPRESSION NUT	1		
31	54-0034	TUBE *(THREE FEET REQUIRED)	1		
32	854-0025	TUBE ASSEMBLY (INCLUDES 33-35)	1		
33	23-0347	COMPRESSION NUT	1		
34	54-0036	TUBE *(THREE FEET REQUIRED)	1		
35	23-0346	FITTING	1		
36	27-0122	BOLT	4		
37	N/A Sep.	RUBBER ISOLATOR (SEE 3-0174)	4		
38	30-0159	NUT	8		
39	27-0118	BOLT	4		
40	43-0078	KEY	1		
41	32-0253	CONDUIT FLEX *(TWO FEET REQUIRED)	1		
42	2-0101	MOTOR- 5.0 H.P.	1		
43	32-0563	CONTACTOR	1		

Id	Item #	Description	Quantity	Rev	Comments
44	27-9526	BOLT	2		
45	28-1009	WASHER	2		
46	30-6001	NUT	2		
47	854-0039	BELTGUARD BACK ASSEMBLY (INC. 48-50)	1		
48	N/A Sep.	BELTGUARD BACK (SEE 854-0039)	1		
49	N/A Sep.	DECAL- WARNING: BELTGUARD IN PLACE (SEE 34-9016)	1		
50	33-0020	EDGING *(THREE FEET REQUIRED)	1		
51	30-0157	LOCKNUT	2		
52	28-0003	WASHER	4		
53	27-0066	BOLT	2		
54	10-0120	DRIVE PULLEY	1		
55	9-0077	BUSHING	1		
56	27-0017	BOLT	3		
57	854-0026	BELTGUARD ASSEMBLY (INCLUDES 58, 59)	1		
58	33-0020	EDGING *(FIVE FEET REQUIRED)	1		
59	N/A Sep.	BELTGUARD COVER (SEE 854-0026)	1		
60	33-0197	FASTENER	2		
61	27-8433	BOLT W/COMPRESSOR	1		
62	28-1032	FLATWASHER FLYWHEEL W/COMPRESSOR	1		
63	11-0044	DRIVE BELT	1		
64	10-0095	FLYWHEEL W/COMPRESSOR	1		
65	43-0102	WOODRUF KEY W/COMPRESSOR	1		
66	27-9524	BOLT	3		
67	30-3030	FLANGE NUT	2		
68	20-0457A01	BELTGUARD BRACKET	1		
69	27-8921	STUD BOLT	2		
70	3-0174	COMPRESSOR	1		
71	19-0219	AIR FILTER ASSEMBLY (INC. 72-74)	1		
72	N/A Sep.	FILTER HOUSING (SEE 19-0219)	1		
73	19-0220	AIR FILTER ELEMENT	1		
74	N/A Sep.	FILTER HOUSING (SEE 19-0219)	1		
		SAFETY DECAL KIT (INC. 1, 7, 9-11, 13, 49)			
		*MUST ORDER IN ONE FOOT LENGTHS			



AC2-SE05-60M / AC2-SE05-60M (sn:20004966-99999999)

TWO STAGE COMPRESSOR

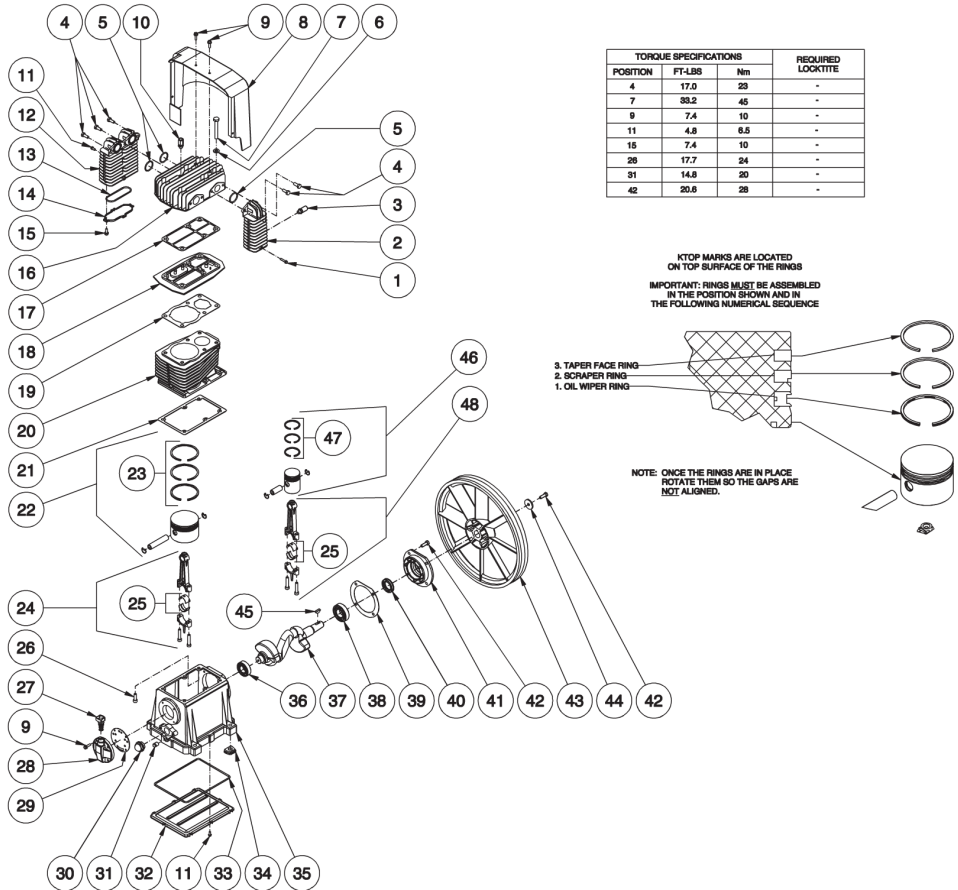

Id	Item #	Description	Quantity	Rev	Comments
1	27-8807	BOLT	1		
2	46-1156	AFTER COOLER	1		
3	22-0385	SAFETY VALVE	1		
4	27-8032	BOLT	5		
5	25-0439	O-RING	3		
6	28-1021	WASHER	6		
7	27-8934	BOLT	6		
8	N/A	AIR SHROUD	1		
9	27-8002	BOLT	6		
10	22-0386	SAFETY VALVE	1		
11	27-9575	SCREW	9		

Id	Item #	Description	Quantity	Rev	Comments
12	46-1157	INTER COOLER	1		
13	25-0440	O-RING	1		
14	46-0816	INTER COOLER COVER	1		
15	27-8906	SCREW	4		
16	46-1158	PUMP HEAD	1		
17	N/A Sep.	HEAD GASKET (SEE 70-0240)	1		
18	22-0283	VALVE PLATE ASSEMBLY	1		
19	N/A Sep.	CYLINDER GASKET (SEE 70-0240)	1		
20	46-0817	CYLINDER	1		
21	N/A Sep.	CRANKCASE GASKET (SEE 70-0240)	1		
22	N/A	COMPLETE PISTON	1		
23	70-0238	RING SET KIT	1		
24	N/A	CONNECTING ROD	1		
25	N/A	CONNECTING ROD BEARING	2		
26	27-8194	SCREW	6		
27	46-0818	CRANKCASE FILL HOLE PLUG W/ O-RING	1		
28	46-0819	OIL FILL END CAP	1		
29	N/A Sep.	OIL FILL END CAP GASKET (SEE 70-0240)	1		
30	46-0820	OIL LEVEL SIGHT GLASS W/ O-RING	1		
31	39-0106	OIL DRAIN PLUG	1		
32	N/A	OIL PAN	1		
33	N/A Sep.	OIL PAN O-RING (SEE 70-0240)	1		
34	46-0821	ISOLATOR	4		
35	N/A	CRANKCASE	1		
36	48-0060	BALL BEARING	1		
37	N/A	PISTON CRANKSHAFT	1		
38	48-0024	BALL BEARING	1		
39	N/A Sep.	FRONT END CAP GASKET (SEE 70-0240)	1		
40	26-0208	CRANKSHAFT SEAL	1		
41	46-0822	FRONT END CAP	1		
42	27-8033	BOLT	5		
43	10-0130	FLYWHEEL	1		
44	28-1032	WASHER	1		
45	43-0102	KEY	1		
46	N/A	COMPLETE PISTON	1		
47	70-0239	RING SET KIT	1		
48	N/A	CONNECTING ROD	1		
KIT	70-0240	GASKET KIT (INC. 5, 13, 17, 19, 21, 29, 33, 39)			



AC2-SE05-60M / AC2-SE05-60M (sn:20004966-99999999)

DUEL CONTROL OPTION

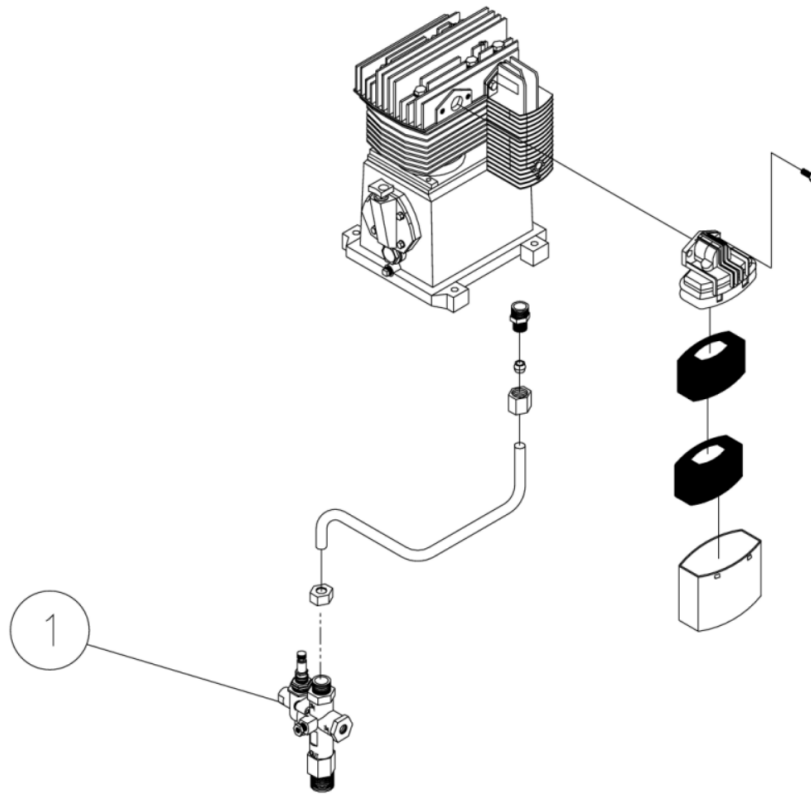

Id	Item #	Description	Quantity	Rev	Comments
1	22-0269	PILOT VALVE	1		

Id	Item #	Description	Quantity	Rev	Comments
4	N/A Sep.	PISTON ASSEMBLY-UNLOADER VALVE (SEE 70-0221)	1		
5	N/A Sep.	SPRING-UNLOADER VALVE (SEE 70-0221)	1		
6	N/A	SPRING SEAT-UNLOADER VALVE	1		
7	N/A	CAP	1		
8	N/A	DISCHARGE PORT FITTING	1		
9	N/A	SPRING SEAT ASSEMBLY	1		
10	N/A Sep.	SPRING-CHECK VALVE (SEE 70-0221)	1		
11	N/A Sep.	PISTON-CHECK VALVE (SEE 70-0221)	1		
12	N/A	MUFFLER	1		
13	N/A Sep.	STEM UNLOADER (SEE 70-0221)	1		
14	N/A Sep.	DIAPHRAM (SEE 70-0221)	1		
15	N/A Sep.	O-RING (SEE 70-0221)	1		
16	N/A Sep.	SCREEN (SEE 70-0221)	1		
17	N/A	SCREW W/WASHER	4		
18	N/A	PIPE PLUG	1		
19	N/A	PILOT BODY	1		
20	N/A Sep.	BALL (SEE 70-0221)	1		
21	N/A Sep.	O-RING (SEE 70-0221)	1		
22	N/A	DIFFERENTIAL ADJUSTING LOCKNUT	1		
23	N/A	DIFFERENTIAL ADJUSTING NUT	1		
24	N/A Sep.	STEM (SEE 70-0221)	1		
25	N/A Sep.	PILOT SPRING (SEE 70-0221)	1		
26	N/A	PRESSURE ADJUSTING LOCKNUT	1		
27	N/A	PRESSURE ADJUSTING SCREW ASSEMBLY	1		
KIT	70-0221	REPAIR KIT (INCLUDES 2, 4-5, 10-11, 13-16, 20-21, 24-25, AND 3 EACH 2)			