

Log Set Assembly

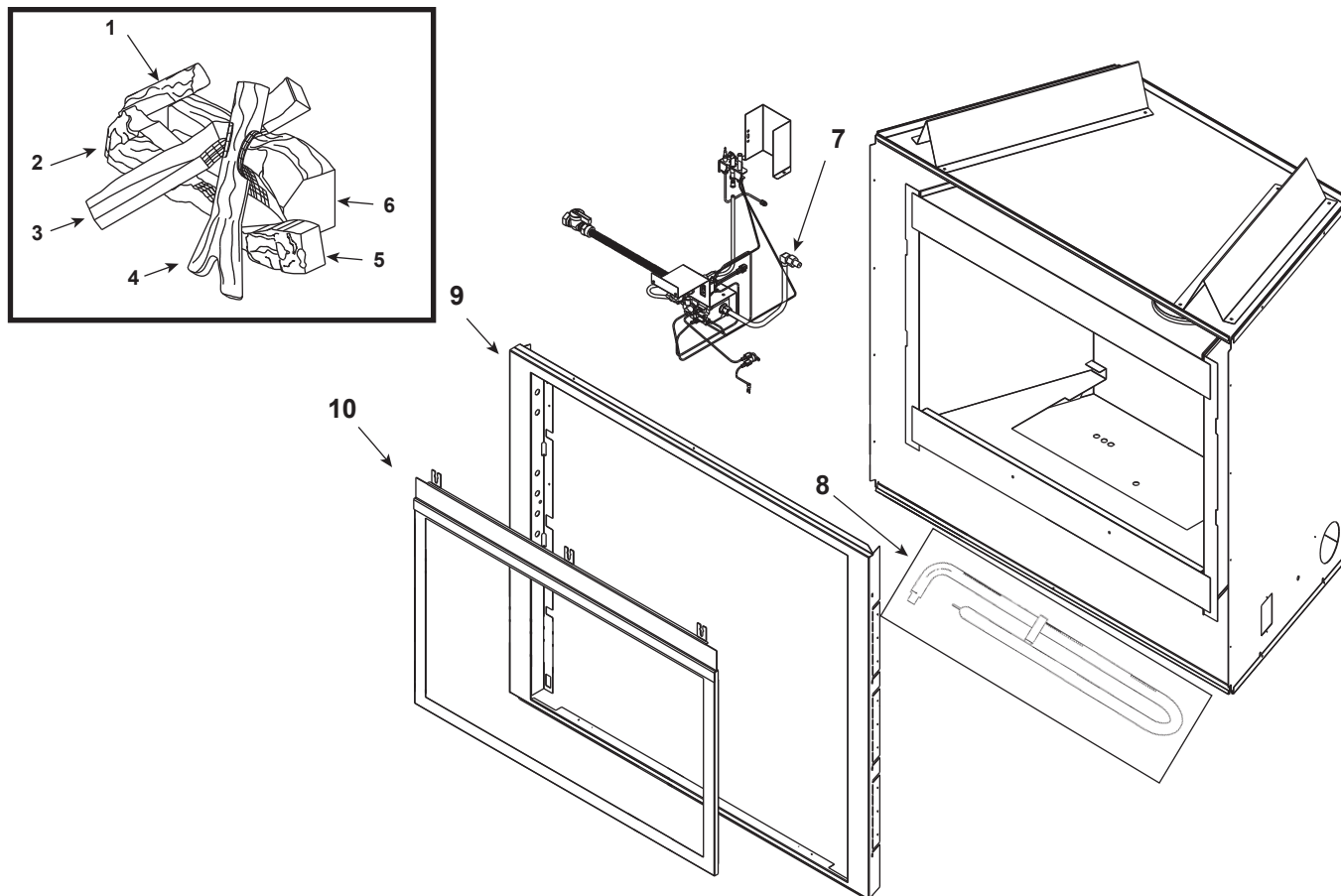

IMPORTANT: THIS IS DATED INFORMATION. Parts must be ordered from a dealer or distributor. **Hearth and Home Technologies does not sell directly to consumers.** Provide model number and serial number when requesting service parts from your dealer or distributor.



**Stocked
at Depot**

ITEM	DESCRIPTION	COMMENTS	PART NUMBER	
	Log Set Assembly	No longer available	LOGS-6CF	
1	Log 1	No longer available	SRV94-721	
2	Log 2	No longer available	SRV94-723	
3	Log 3	No longer available	SRV94-724	
4	Log 4	No longer available	SRV94-725	
5	Log 5	No longer available	SRV94-726	
6	Log 6	No longer available	SRV79-702	
7	Orifice NG (#39A)	No longer available	066-800	
	Orifice LP (#53A)		060-801	Y
8	Burner NG	No longer available	094-336A	
	Burner LP	No longer available	094-335A	
9	Surround	No longer available	094-221A	
10	Glass Assembly	No longer available	GLA-6CF	

No one builds a better fire

Beginning Manufacturing Date: Nov 1994
Ending Manufacturing Date: Jan 1997

IMPORTANT: THIS IS DATED INFORMATION. Parts must be ordered from a dealer or distributor. **Hearth and Home Technologies does not sell directly to consumers.** Provide model number and serial number when requesting service parts from your dealer or distributor.



Stocked at Depot

ITEM	DESCRIPTION	COMMENTS	PART NUMBER	
	Decorative Front		DF-36H	
	Gas Tube		477-301A	Y
	High Temp Limit		060-531	Y
	Junction Box		100-250A	Y
	On/Off Rocker Switch		SRV060-511	Y
	Piezo Ignitor		291-513	Y
	Pilot Assembly NG		446-512A	Y
	Pilot Assembly LP		446-513A	Y
	Thermopile		2103-512	Y
	Pilot Tube		SRV446-301	Y
	Touch Up Paint		TUPB-12	
	Valve NG		040-500	Y
	Valve LP		040-501	Y
	Valve Cover Plate	No longer available	SRV94-103	
	Conversion Kit NG	No longer available	NGK-6CF	
	Conversion Kit LP	No longer available	LPK-6CF	
	Pilot Orifice NG		SRV446-505	Y
	Pilot Orifice LP		SRV446-517	Y
	Regulator NG		SRV060-518	Y
	Regulator LP		060-519	Y