

## 1.0 Introduction

Thank you for selecting the Martin Yale Titan – THE Professional Padding Press. We recommend that you familiarize yourself with the Titan Padding Press by carefully reading these instructions. Thorough understanding of the information contained within these instructions will help to eliminate most operator associated errors and ensure years of trouble-free performance.

## 2.0 Assembly

### 2.1 Base Assembly

- 2.1.1 Refer to Parts List A and Diagram A. Locate Hardware Box and the large parts for the Base Assembly. Open Hardware Box, remove casters and bag A. Set bags B and C aside for now. Open bag A.
- 2.1.2 Attach Base Tray and Base Support to T-Frames as shown with “martin yale” decals facing outward using the six (6) medium-length bolts, (6) lock washers and (6) acorn nuts; tighten bolts.
- 2.1.3 Insert the four (4) short bolts through the four (4) middle holes in Drip Tray and Tilt Latch Assembly as shown, then install four (4) keps nuts; tighten bolts.
- 2.1.4 Note orientation of Drip Tray and Tilt Latch Assembly. Carefully slide Drip Tray/Tilt Latch Assembly over the T-Frames and align four (4) outer holes. Insert four (4) long bolts as shown, install (4) lock washers and (4) acorn nuts; tighten bolts.
- 2.1.5 Install casters as shown by carefully laying the base assembly on its side. Each T-Frame should have one (1) locking caster and one (1) non-locking caster.

### 2.2 Upper Assembly

- 2.2.1 Refer to Parts List B and Diagram B. Locate Bag B, the L-Frames and the Bottom Panel. Open parts bag B.

**ATTENTION! Note the orientation of the L-Frames in Diagram B. Failure to install the L-Frames in the proper orientation will cause the unit to not function properly.**

- 2.2.2 Install each L-Frame individually using shoulder bolt and nylon washer in the orientation shown; tighten shoulder bolt using hex-key wrench.
- 2.2.3 Position Bottom Panel in the orientation shown, noting the location of notches on front. Loosely install six (6) screws with six (6) keps nuts. Before tightening, position Upper Assembly upright and verify Tilt Latch locks into place. This will result in an audible click, and the assembly will no longer tilt. Tighten screws.

**ATTENTION! Be careful after removal of the L-Frame Shipping Braces to not bend or otherwise damage the L-Frames.**

- 2.2.4 Remove (2) screws securing each L-Frame Shipping Braces at top of each L-Frame. Discard screws and braces.
- 2.2.5 Carefully slide one (1) clamp onto each L-Frame as shown, ensuring clamp is installed onto front tube. **Do not bend L-Frames!**

# **Parts List A**

Item #	Part #	Qty.	Description
1	W-O243615	2	T-Frame
2	W-O243617	1	Base Support
3	W-O243619	1	Base Tray
4	W-O243621	1	Drip Tray
5	W-O243623	1	Tilt Latch Assembly
6	M-S001062	4	Short Bolt (1/4-20 X 5/8)
7	M-S001548	6	Mid-Length Bolt (1/4-20 X 1.25)
8	M-S001547	4	Long Bolt (1/4-20 X 2.25)
9	M-S008029	10	Lock Washer (1/4 Internal)
10	M-S007133	10	Acorn Nut (1/4-20)
11	M-S63251449	4	Keps Nut (1/4-20)
12	M-S034009	2	Swivel Caster
13	M-S034010	2	Locking Swivel Caster

# **Parts Diagram A**

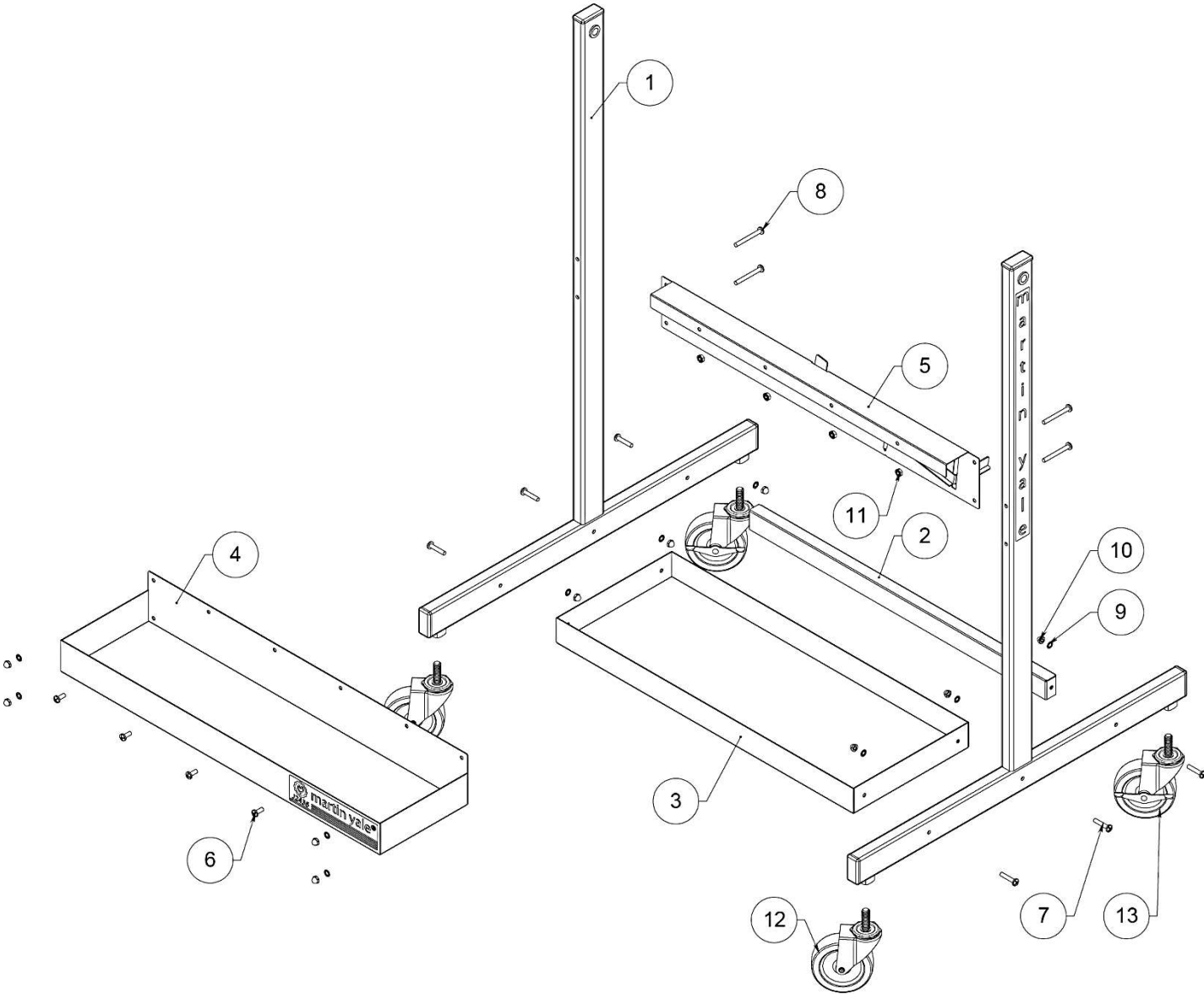

# Parts List B

Item #	Part #	Qty.	Description
1	W-O243637	1	Right L-Frame
2	W-O243639	1	Left L-Frame
3	W-O243657	1	Bottom Panel
4	M-S003140	2	Shoulder Bolt (.50 X 2.00)
5	M-S008100	2	Nylon Washer (.503 ID)
6	M-S001022	6	Screw (10-32 X 3/8)
7	M-S007008	6	Keps Nut (10-32)

# Parts Diagram B

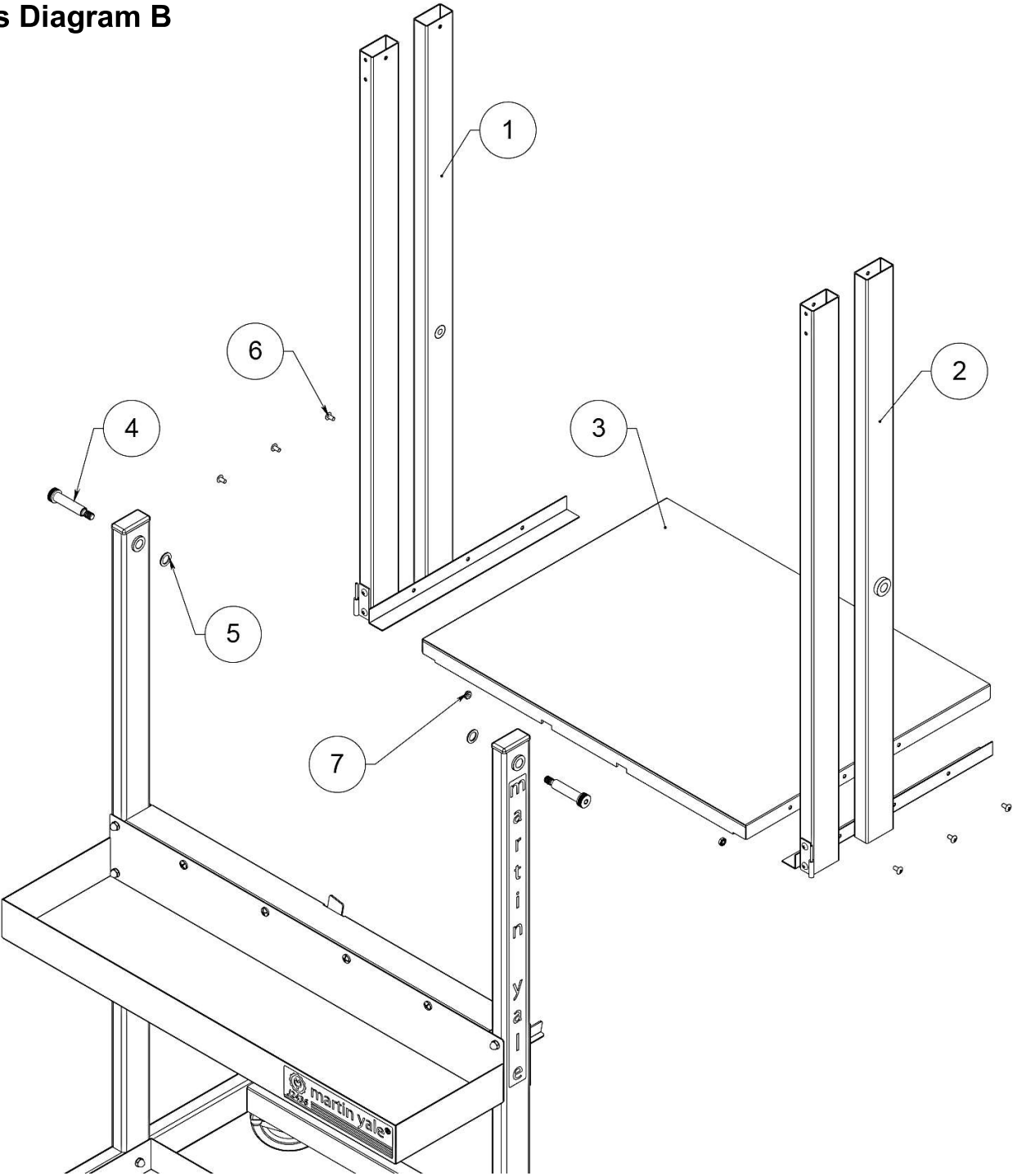

# Parts List C

Item #	Part #	Qty.	Description
1	W-O243649	2	Clamp
2	W-O243663	1	Top Panel Assembly
3	W-O243669	1	Right Door
4	W-O243669	1	Left Door
5	W-O243675	1	Clamp Bar
6	M-S036011	1	Right Hinge
7	M-S036010	1	Left Hinge
8	M-S001022	8	Screw (10-32 X 3/8)
9	M-S007008	8	Keps Nut (10-32)
10	M-S043744	4	End Cap

# Parts Diagram C

