

FMI Pueblo 32" B-Vent Single Burner Elec. Ign. Fireplace

MODELS: P324E

Part Number	Description
1	108769-03 Extension Deflector
2	109098-01 Wire Assembly Electric Harness
3	108864-01 Strain Relief 1/2" Bushing
4	108425-01 Air Rod Retainer
5	108423-01 Panel Closure
6	108863-01 24" Supply Connect Plug
7	14253 Flexi Line with Shutoff Valve
8	** Air Separator
9	11186 Screw, #8-32 x 1" PPH Zinc.
10	11109 Screw, #8-32 x 1/2" PPH Zinc.
11	11201 Nut, #8-32 Hex Zinc.
12	108428-03 Bottom Front Refractory,
13	108426-03 Bottom Rear Refractory
14	106683-01 Firebox Support Leg
15	24353 Box Assembly
16	108701-01 Screen Rod
17	110286-01 Ignition Module
18	11165 Screw, #10x5/8 Mod. Tr. Blk. Ox
19	106703-02 Damper Door Assembly
20	108416-01 4" Collar
21	108412-01 Smoke Deflector
22	108415-01 Starter Pipe Collar
23	109797-01 Grate Assembly
24	109107-02 Burner Assembly
24-1	107742-03 Burner Pan
24-2	109794-01 Burner Tube
24-3	107748-01 Burner Bracket
24-4	107985-01 Pilot Shield
24-5	109793-01 Divider Pan
24-6	11209 Nut, #10-24
24-7	11147 Screw, #10-24x1/2
24-8	901066-01 Brass Air Mixer (NG)
	901066-02 Brass Air Mixer (LP)
24-9	901064-12 Orifice (NG)
	901065-11 Orifice (LP)
24-10	108866-01 Pilot (Natural Gas)
24-11	108867-02 Pilot Orifice (NG)
24-12	11102 Screw, #8-32x3/8
25	14569 Electronic Gas Valve (NG)
	14570 Electronic Gas Valve (LP)
26	107741-02 Valve Bracket
27	14129 Transformer
28	108368-01 3/8" Flex Line
29	11107 Screw, #10-32 x 1/4 PPH
30	108005-05 Wire Harness
31	11418 Push-On Nut
32	108441-01 Screen
33	14123 Strain Relief
34	14574 Limit Switch
35	22912 Draft Diverter
36	106827-01 4" Gasket
37	20042 Air Kit Cover
38	20088 Door Stop
40	20090 Spring Clip
41	21171 Gas Knockout Cover
42	108652-01 Gas Conduit Assembly, Left
43	108654-01 Gas Conduit Assembly, Right
44	20280 Top Spacer

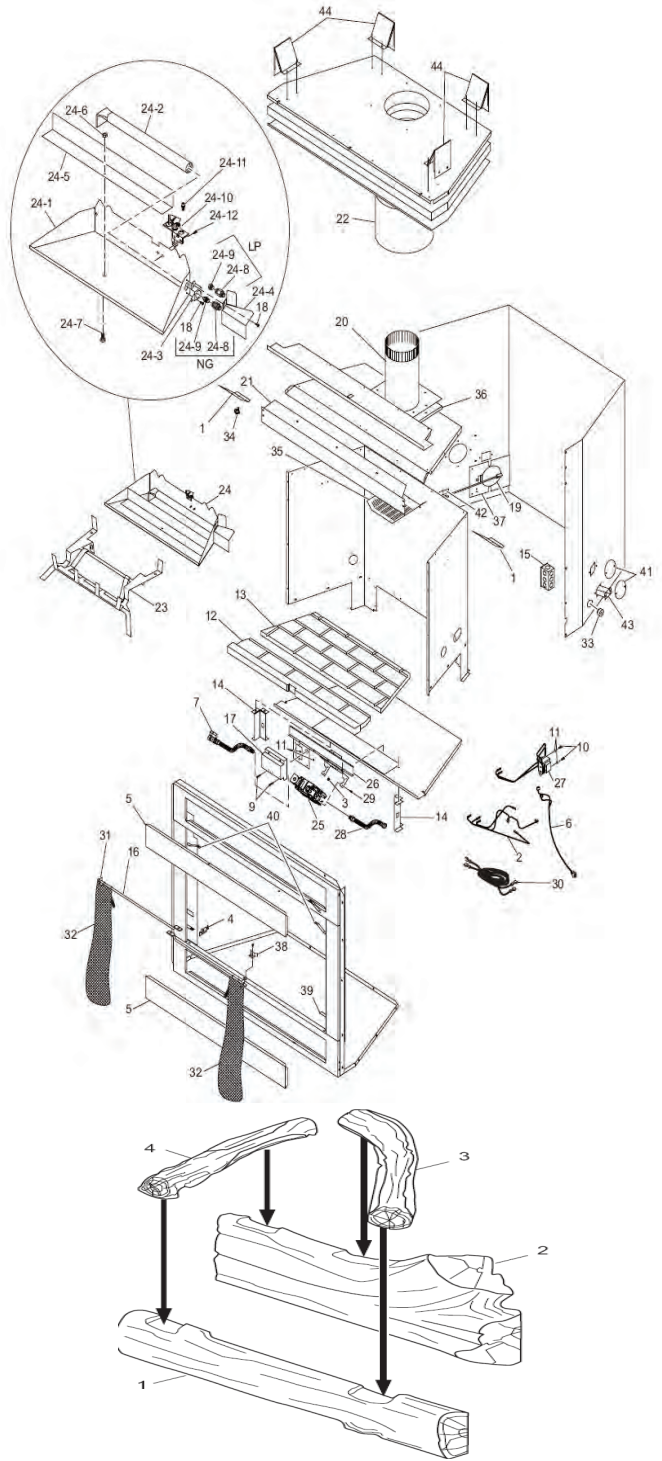

Part Number	Description
PARTS AVAILABLE NOT SHOWN	
901155-01	Vermiculite Bag
901156-01	Pan Material
901157-01	Lava Rock
LOGS	
-	109109-01 Log Set
1	105958-05 Front Log
2	105960-05 Rear Log
3	901100-02 Top Right Log
4	901102-02 Top Left Log

** Not Field Replaceable Part