

---

**MK-370 TILE SAW  
OWNERS MANUAL  
PARTS LIST &  
OPERATING INSTRUCTIONS**



Revision 201	02.2017
Manual Part# 156760	

**Caution:** Read all safety and operating instructions before using this equipment. This parts list **MUST** accompany the equipment at all times.

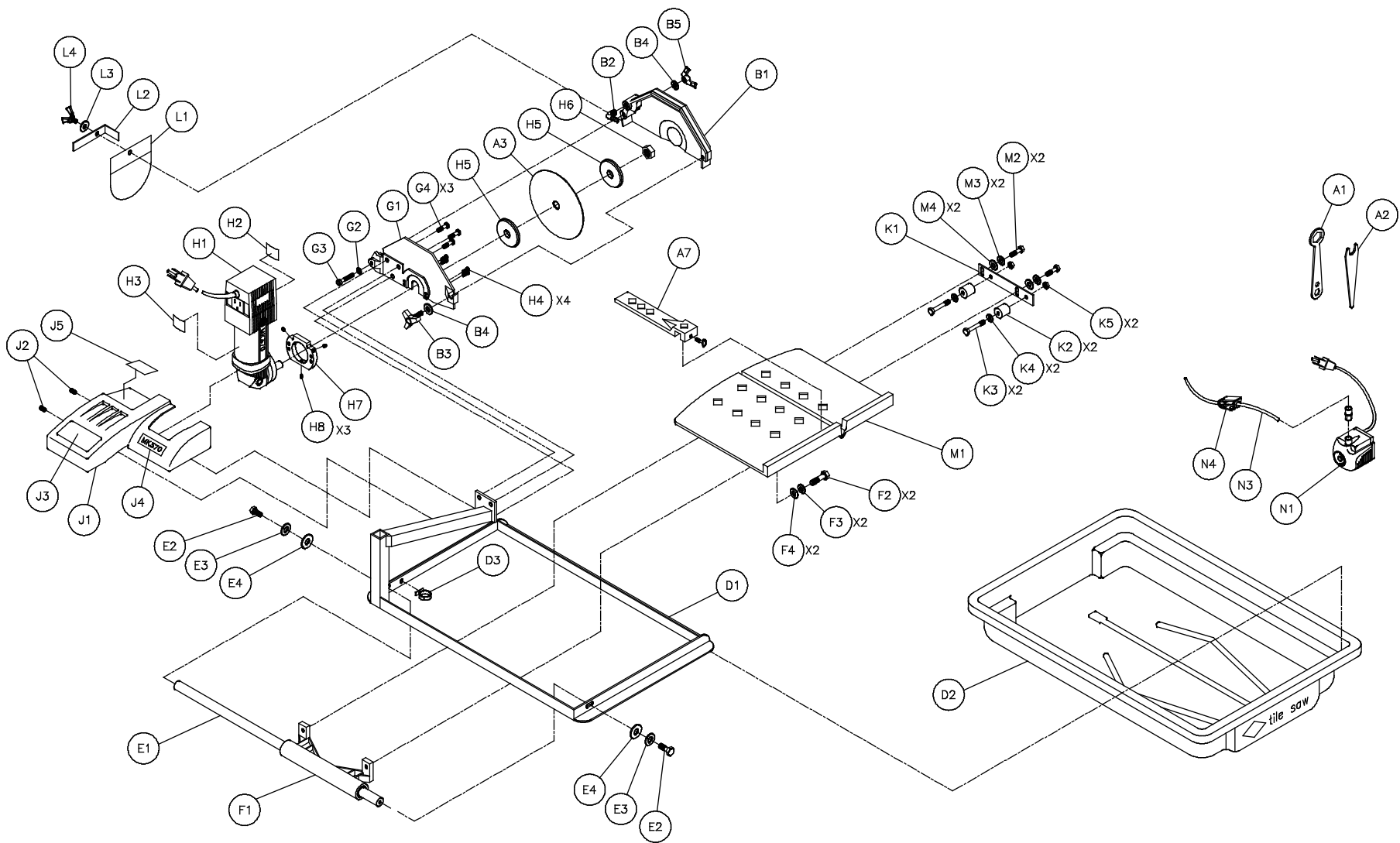

ITEM	DESCRIPTION	PART #	QTY
<b>A</b>	<b>Accessories</b>	<b>n/a</b>	<b>-</b>
A1	Wrench, Blade Nut, 15/16 Boxed End	134684	1
A2	Wrench, Blade Shaft, 11/16 Open End	153450	1
A3	Blade, 7 Dia X 5/8 arbor	153441	1
A4	Owner's Manual, 370	156760	1
A5	Warranty Card	155037	1
A6	Tag, Saw Hang, 370	156750	1
A7	Assembly, Rip Guide	134551-MK	1
<b>B</b>	<b>Assembly, Blade Guard, 7"</b>	<b>154811-MK</b>	<b>1</b>
B1	Guard, 7" Blade	154811	1
B2	Elbow, 1/8 MNPT X 1/4 BARB 90° Brass	154652	1
B3	Knob, Davies	151681	1
B4	Washer, 5/16 SAE Flat	151754	2
B5	Wingnut, 5/16-18 Nylock	151746	1
<b>D</b>	<b>Frames</b>	<b>n/a</b>	<b>-</b>
D1	Frame	155792	1
D2	Pan, Water	155791	1
D2A	Pan, Water, Deep	157210	1
D3	Cord Clip, 1/4 Push Mount	157259	1
<b>E</b>	<b>Assembly, 5/8 Guide Bar</b>	<b>151739-MK</b>	<b>1</b>
E1	Bar, Guide, 5/8 Dia	151739	1
E1A	Bar, Guide, 5/8 Dia, Extended	157486	1
E2	Screw, 5/16-18 X 1 Hex Head Cap	151743	2
E3	Washer, 5/16 Split Lock	151747	2
E4	Washer, 5/16 SAE Flat	151754	2
<b>F</b>	<b>Linear Bearing</b>	<b>n/a</b>	<b>-</b>
F1	Bearing, Linear, 5/8 Dia (comp)	157126	1
	F1A Bearing, Multilube	151781	2
F2	Screw, 5/16-18 X 1 Hex Head Cap	151743	2
F3	Washer, 5/16 Split Lock	151747	2
F4	Washer, 5/16 SAE Flat	151754	2
<b>G</b>	<b>Assembly, Motor Mount</b>	<b>155811-MK</b>	<b>1</b>
G1	Motor Mount	157403	1
G2	Washer, 5/16 Split Lock	151747	1
G3	Screw, 5/16-18 X 2 1/2 Hex Head Cap, Full Thread	151748	1
G4	Screw, 1/4-20 X 1/2 Flat Head Phillips Cap	155812	3
<b>H</b>	<b>Motors</b>	<b>n/a</b>	<b>-</b>
H1	Motor, 120v/7.4a, 370	156428-R	1
H2	Label, Caution, GFCI, 1 X 2 1/8	155678	1
H3	Label, Caution, Receptacle, 1 X 2 1/8	154822	1
H4	Screw, 10-32 X 5/8 Flat Head Phillips Cap,	157554	4
H5	Flange, Blade	135830	2
H6	Nut, 5/8-18 UNF	135848	1
H7	Adapter, Motor, 370	156703	1
H8	Screw, 10-32 X 1/4 Socket Head Set, Cup Point	156715	3

ITEM	DESCRIPTION	PART #	QTY
H9	Label, 370 Model	156692	1
H10	Plug, CEE 7/7 16a 240v	153687	1
<b>J</b>	<b>Post Cover</b>	<b>n/a</b>	<b>-</b>
J1	Casting, Cover, Post, 370	156748	1
J2	Screw, 10-24 X 3/8 Socket Head Set, Cup Point	156715	2
J3	Label, Warning, Read Owner's Manual	155806	1
J4	Label, 370 Model	156692	1
J5	Label, Serial Number, UL/CSA Mark	157249-04	1
<b>K</b>	<b>Assembly, Roller Wheel, Double</b>	<b>156586</b>	<b>1</b>
K1	Bracket, Roller Wheel	156522	1
K2	Wheel, Roller	151799	2
K3	Screw, 1/4-20 X 1 1/2 Hex Head Cap	151914	2
K4	Washer, 1/4 SAE Flat	151915	2
K5	Nut, 1/4-20 Hex	151893	2
<b>L</b>	<b>Assembly, Splash Curtain</b>	<b>155901-MK</b>	<b>1</b>
L1	Curtain, Splash	134841	1
L2	Bracket, Splash Curtain	155901	1
L3	Washer, 1/4 SAE Flat	151915	1
L4	Wingscrew, 1/4-20 X 1/2	151888	1
<b>M</b>	<b>Table</b>	<b>n/a</b>	<b>-</b>
M1	Table, Composite, 370/470	156536	1
M2	Screw, 5/16-18 X 1 Hex Head Cap	151743	2
M3	Washer, 5/16 Split Lock	151747	2
M4	Washer, 5/16 SAE Flat	151754	2
<b>N</b>	<b>Assembly, PES-100 120v Water Pump</b>	<b>155987-MK</b>	<b>1</b>
N1	Pump, Water, PES-100 120v	155987	1
N1A	Pump, Water, 100v	154812	1
N1B	Pump, Water, 230v	156181	1
N3	Hose, Vinyl, 1/4 ID	132951	2'
N4	Clamp, Flow, 1/4-1/2	154394	1
N5	Owner's Manual, Water Pump	155745	1