



INSTALLATION AND OPERATING INSTRUCTIONS

STANDARD SERIES



Unvented Gas Log Room Heaters
P/N 903623 REV. M 12/2007

MODELS

- | | |
|---------------------|----------------------|
| VFGL-18VSN-4 Series | VFGL-18MSN-4 Series* |
| VFGL-18VSP-4 Series | VFGL-18MSP-4 Series* |
| VFGL-24VSN-4 Series | VFGL-24MSN-4 Series* |
| VFGL-24VSP-4 Series | VFGL-24MSP-4 Series* |
| VFGL-28VSN-4 Series | VFGL-28MSN-4 Series* |
| VFGL-28VSP-4 Series | VFGL-28MSP-4 Series* |

INSTALLER: Leave this manual with the appliance.
CONSUMER: Retain this manual for future reference.



We suggest that our gas hearth products be installed and serviced by professionals who are certified in the U.S. by the National Fireplace Institute® (NFI) as NFI Gas Specialists.

Tested & Listed By



Beaverton Oregon USA

OMNI-Test Laboratories, Inc.

WARNING: IMPROPER INSTALLATION, ADJUSTMENT, ALTERATION, SERVICE OR MAINTENANCE CAN CAUSE INJURY OR PROPERTY DAMAGE. REFER TO THIS MANUAL. FOR ASSISTANCE OR ADDITIONAL INFORMATION CONSULT A QUALIFIED INSTALLER, SERVICE AGENCY OR THE GAS SUPPLIER.

FOR USE ONLY WITH DECORATIVE TYPE UNVENTED ROOM HEATERS.

WARNING: DO NOT BUILD A WOOD FIRE. DO NOT BURN WOOD OR OTHER MATERIAL IN THESE APPLIANCES.

WARNING: IF THE INFORMATION IN THIS MANUAL IS NOT FOLLOWED EXACTLY, A FIRE OR EXPLOSION MAY RESULT CAUSING PROPERTY DAMAGE, PERSONAL INJURY OR LOSS OF LIFE.

CAREFULLY REVIEW THE INSTRUCTIONS SUPPLIED WITH THE DECORATIVE TYPE UNVENTED ROOM HEATER FOR THE MINIMUM FIREPLACE SIZE REQUIREMENT.

DO NOT INSTALL THE APPLIANCE IN THIS FIREBOX, UNLESS THIS FIREBOX MEETS THE MINIMUM DIMENSIONS REQUIRED FOR THE INSTALLATIONS.

FOR YOUR SAFETY: Do not store or use gasoline or other flammable vapors or liquids in the vicinity of this or any other appliance.

This is an unvented gas-fired heater. It uses air (oxygen) from the room in which it is installed. Provisions for adequate combustion and ventilation air must be provided. Refer to Combustion and Ventilation Air Section, Page 3.

FOR YOUR SAFETY: What to do if you smell gas:

- DO NOT light any appliance.
 - DO NOT touch any electrical switches.
 - DO NOT use any phone in your building.
 - Immediately call your gas supplier from a neighbor's phone.
- Follow your gas suppliers instructions.
- If your gas supplier cannot be reached, call the fire department.

Due to high temperatures, the appliance should be located out of traffic and away from furniture or draperies.

Do not place clothing or other materials on or near this appliance.

IMPORTANT: READ AND UNDERSTAND THESE INSTRUCTIONS COMPLETELY BEFORE INSTALLING YOUR UNVENTED ROOM HEATER.

Installation and service must be performed by a qualified installer, service agency or the gas supplier.

**Note: Manual control models are also design certified for use as vented gas log sets.*

REPLACEMENT PARTS LIST

No.	Description	18N/18P Part No.	24N/24P Part No.	28N/28P Part No.
1.	Valve - Manual (Natural)	110331	110331	110331
	Valve - Manual (Propane, L.P.G.)	110331	110331	110331
2.	Valve, Millivolt (Natural)	903489	903489	903489
	Valve, Millivolt (Propane, L.P.G.)	901917	901917	901917
3.	Pilot (Natural)	110345	110345	110345
	Pilot (Propane, L.P.G.)	110341	110341	110341
4.	Pilot, Millivolt (Natural)	110344	110344	110344
	Pilot, Millivolt (Propane, L.P.G.)	901915	901915	901915
5.	Regulator (Natural)	110351	110351	110351
	Regulator (Propane, L.P.G.)	110352	110352	110352
6.	Front Burner	110281	110282	110282
7.	Rear Burner (Natural)	113301	110302	110302
	Rear Burner (Propane, L.P.G.)	113301	110302	110302
8.	Crossover Burner	110321	110321	110321
9.	Piezo	111061	111061	111061
10.	Piezo Wire	110361	110361	110361
11.	Log Assembly – Split Oak	100104	100105	100106
12.	Control Knob - Manual	110401	110401	110401
13.	Injector, Burner (Natural)	110381	110383	110383
	Injector, Burner (Propane, L.P.G.)	110382	110384	110384
14.	Injector, Crossover Burner (Natural)	110387	110387	110387
	Injector, Crossover Burner (Propane, L.P.G.)	110388	110388	110388

REPLACEMENT PARTS

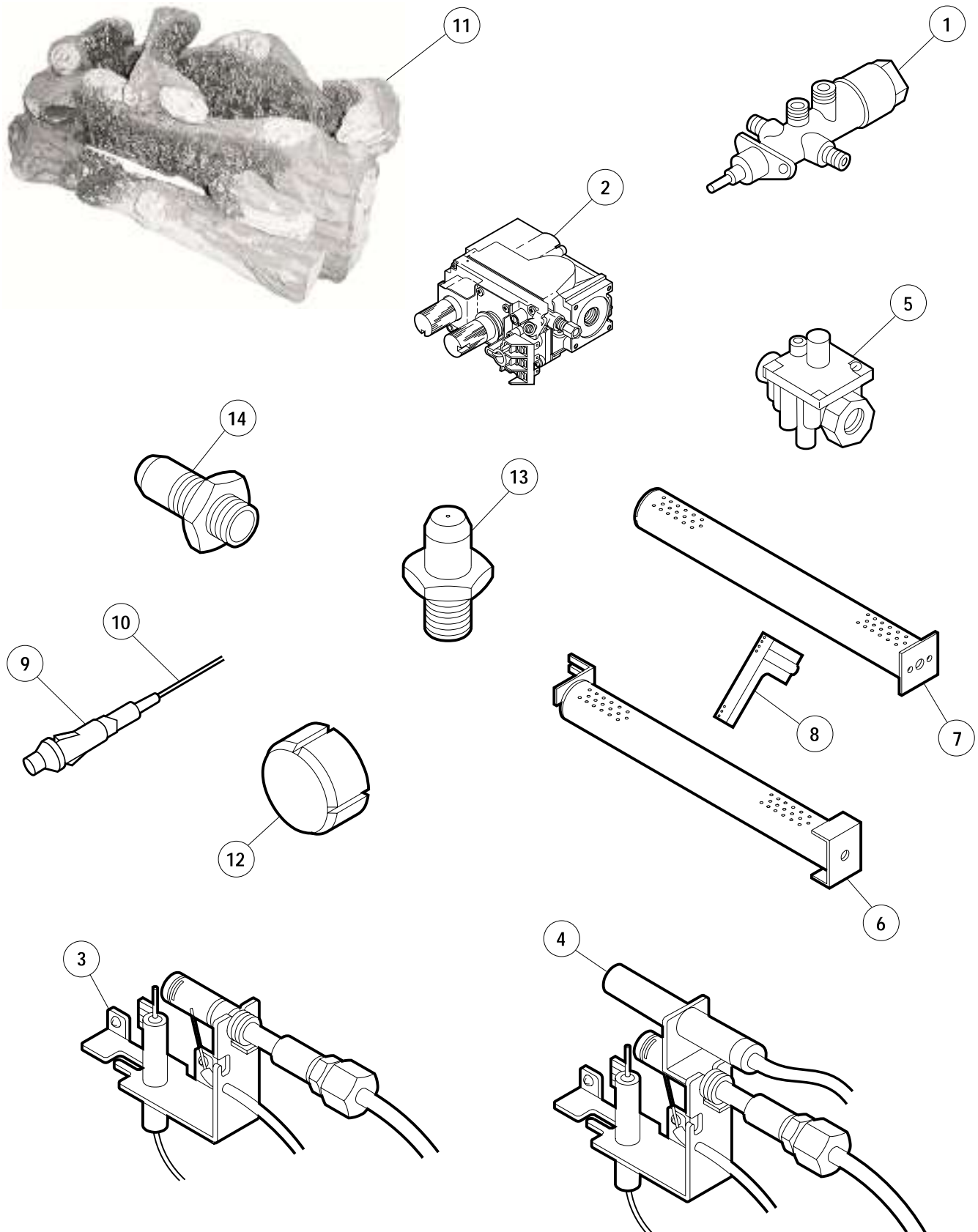

NOTE: DIAGRAMS & ILLUSTRATION NOT TO SCALE.