



**FREESTANDING  
AND INSERT  
PELLET FIRED  
STOVES**



[www.nficertified.org](http://www.nficertified.org)

We suggest that our pellet hearth products be installed and serviced by professionals who are certified in the U.S. by the National Fireplace Institute® (NFI) as NFI Pellet Specialists or who are certified in Canada by Wood Energy Technical Training (WETT).



**RETAIN THESE  
INSTRUCTIONS  
FOR FUTURE  
REFERENCE**



# INSTALLATION AND OPERATION MANUAL



**Freestanding Model  
Advantage® Optima™ 2 FS \***



**Freestanding Model  
Advantage® Optima™ 3 FS \***

Insert Model, Advantage Optima™ 3 INS not shown  
\* Shown with Decorative Log Option

These appliances must be properly installed and operated in order to prevent the possibility of a house fire. Please read this entire owner's manual before installing and using your pellet stove. Failure to follow these instructions could result in property damage, bodily injury or even death. Contact your local building or fire officials to obtain a permit and information on any installation requirements and inspection requirements in your area.

## REPLACEMENT PARTS LIST

### Door Parts & Body Components

Item #	Part No. / Cat. No.	Description	Stove Model
2	14650460	Door Assembly, Cast Iron Firebox	Optima 2 FS
2	14750458	Door Assembly, Cast Iron Firebox	Optima 3 FS & INS
	15051547	Gasket Kit, Door, ¾" Rope, (8 Ft.)	Optima 2 FS
	61051000	Gasket Kit, Door, 1" Rope, (7 Ft.)	Optima 3 FS & INS
	61057202	Gasket Kit, Glass (5/8" x 1/16" x 10 Ft.)	All
	H0257	• Glass, Front	Optima 2 FS
	H0258	• Glass, Side (order 2 if set is needed)	Optima 2 FS
	H0254	• Glass, Front	Optima 3 FS & INS
	H0255	• Glass, Side (order 2 if set is needed)	Optima 3 FS & INS
3	14750406	Knob Kit, Door (includes latch, 3 washers, nut and door latch receiver)	All
4	14750405	Opener, Door Handle	All
5	14650446	Hinge Bracket	Optima 2 FS
6	14750700	Hinge Bracket	Optima 3 FS & INS
7	14650450	Panel, Left Side	Optima 2 FS
8	14650451	Panel, Right Side	Optima 2 FS
9	14750449	Panel, Left Side	Optima 3 FS
10	14750448	Panel, Right Side	Optima 3 FS
11	14650456	Panel, Rear	Optima 2 FS
12	14750465	Panel, Rear	Optima 3 FS
13	14750612	Panel, Left Side	Optima 3 INS
14	14750613	Panel, Right Side	Optima 3 INS
15	14750617	Panel, Top (hopper lid)	Optima 3 INS
16	14650455	Panel, Top (hopper lid)	Optima 2 FS
16	14750455	Panel, Top (hopper lid)	Optima 3 FS
	12051409	Knob, Control Panel Door (6 per package w/studs)	Optima 3 INS

• Includes gasket.

### Electrical Parts

Item #	Part #	Description	Stove Model
17	12046300	Auger Motor	All
27	12050011	Blower Assembly, Exhaust	All
	12056011	Blower Motor, Exhaust	All
28	12146109	* Blower, Room air, Hard Washer	All
18	16053941	Control Board	Optima 2 FS
18	16052112	Control Board	Optima 3 FS & INS
19	12147705	Disc, High Limit, 250 DG (L250-30F,60T21) Set of 3	All
	18150150	Fuse, Control Board, 5 Amp, 250 volt, Fast blow, 12 pk.	All
	12055908	Fuse, Igniter, 6 Amp, 125 volt, Fast blow, 12 pk.	All
20	12150213	Igniter Assembly, Replacement, 380 Watts, 3.3 Amp.'s, 1 each (includes fuse holder w/fuse)	All
22	14750404	Photoeye Kit, Replacement	All
23	12058820	Power Cord, 8 feet	All
25	16050001	Pressure Switch	All
24	16050205	Thermostat, Wall (wire not included)	All
26	12050815	Wiring Harness	All

# REPLACEMENT PARTS LIST

## Firebox Parts

Item #	Part #	Description	Stove Model
29	13640028	Clips, Brick	Optima 2 FS
30	11750011	Clips, Brick	Optima 3 FS & INS
31	14650011	Firebrick Set, 1 pc.	Optima 2 FS
32	14750015	Firebrick Set, 3 pc.	Optima 3 FS & INS
33	14650428	Housing, Igniter Tube	Optima 2 FS
34	14750421	Housing, Igniter Tube	Optima 3 FS & INS
35	12158905	UltraGrate™	All

## Auger System Components

Item #	Part #	Description	Stove Model
37	12041300	Collar & Screw Set, Auger (Set of 3)	All
38	20950088	Flange, Auger	All
39	17150009	Scraper Rod Assembly	Optima 2 FS
39	14750410	Scraper Rod Assembly	Optima 3 FS & INS
40	11756300	Shaft, Auger	All

## Misc.

Item #	Part #	Description	Stove Model
	14650408	Ash Pan	Optima 2 FS
	14750409	Ash Pan	Optima 3 FS
	14750603	Ash Pan	Optima 3 INS
	12151308	Plate, Damper	Optima 2 FS & Optima 3 FS
41	15050058	Filter, Photoeye	All
	14650060	Gasket, Photoeye	Optima 2 FS
	14750060	Gasket, Photoeye	Optima 3 FS & INS
42	61050003	Gasket, Auger Flange, 5pc.	All
43	61050005	Gasket, Exhaust blower, 5pc.	All
44	61057203	Gasket, Room air blower, 5pc.	All
45	61050016	Gasket, Quick Disconnect 5pc.	All
	12151307	Setscrew, Damper Rod (Set of 6)	Optima 2 FS & Optima 3 FS
46	12055500	Tool, Grate Scraper	All
47	12050093	Quick Disconnect 3" Vent Side	All

\* Includes gasket and four nuts.

2

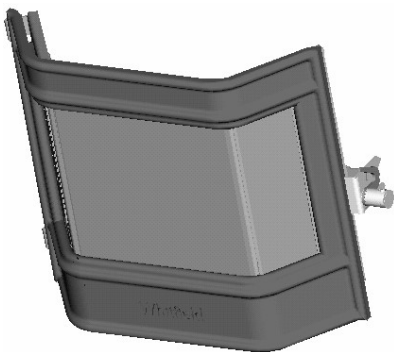

3

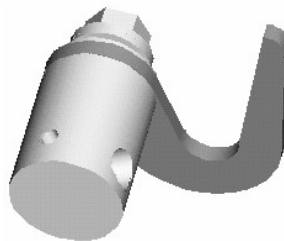

4

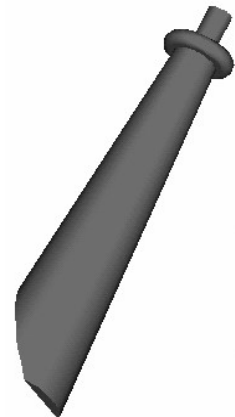

# REPLACEMENT PARTS DIAGRAMS

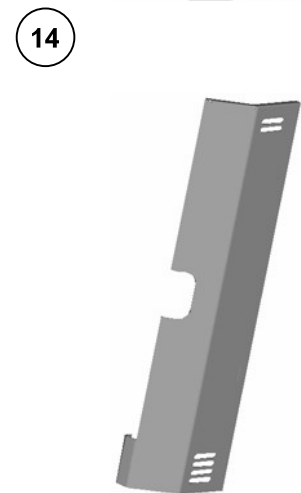
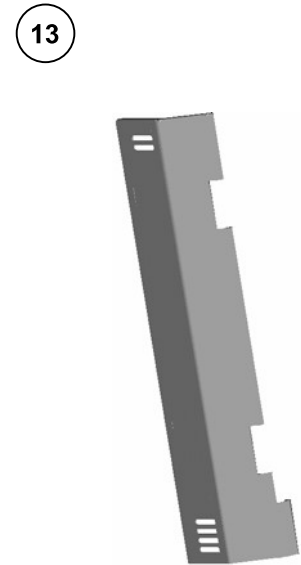
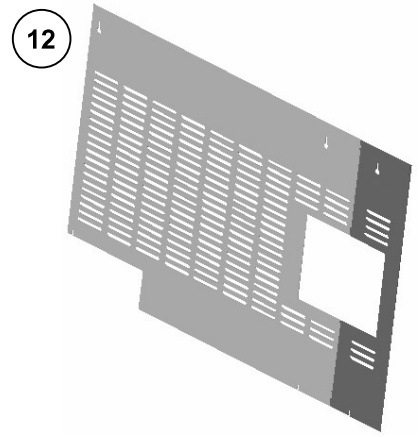
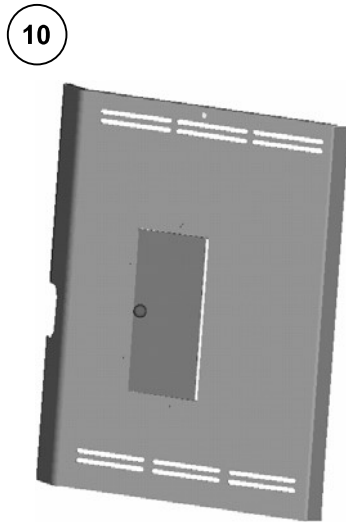
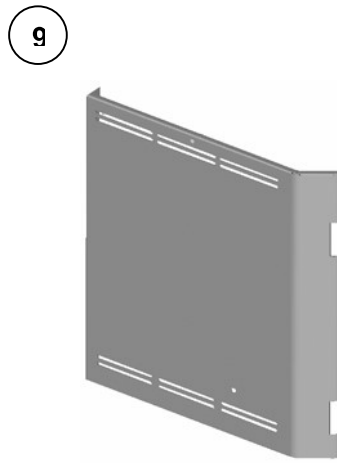
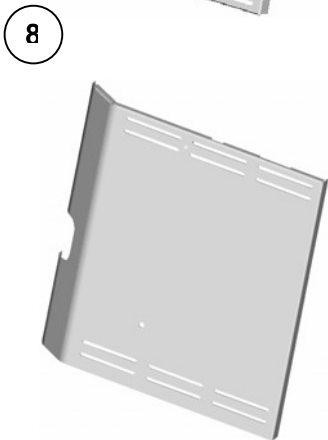
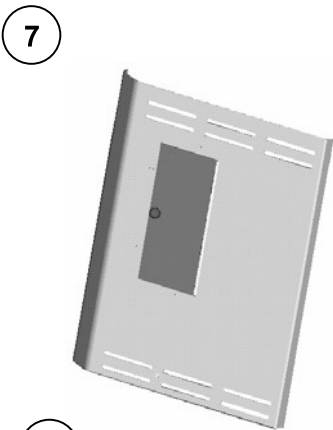
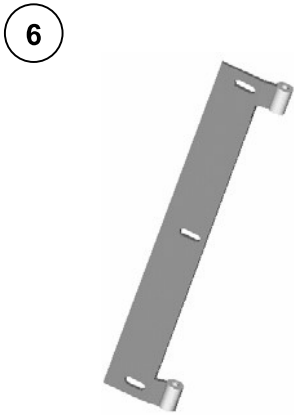
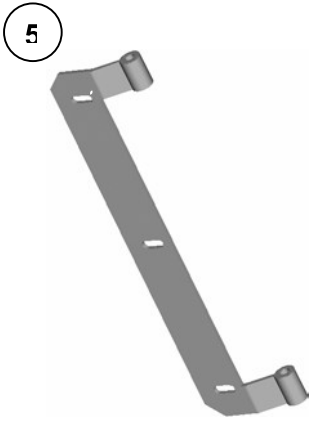

# REPLACEMENT PARTS DIAGRAMS

15

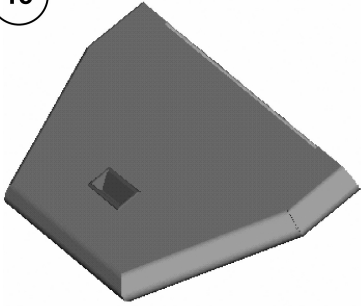

16

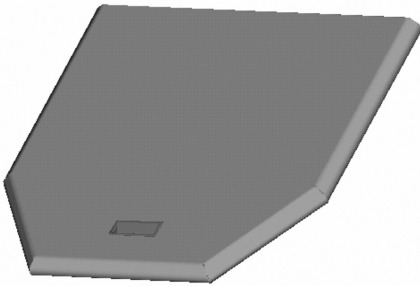

17

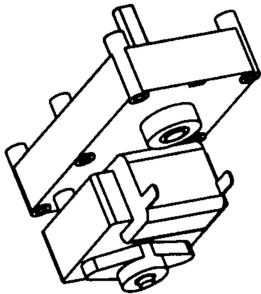

18

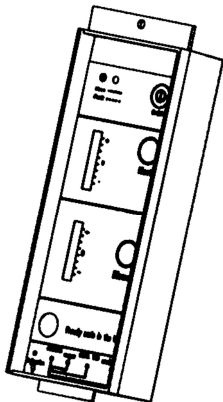

19

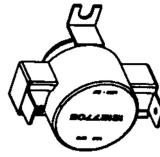

20

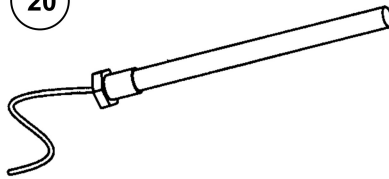

22

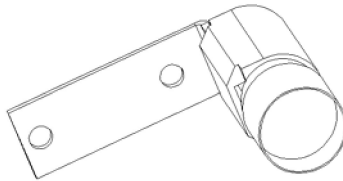

23

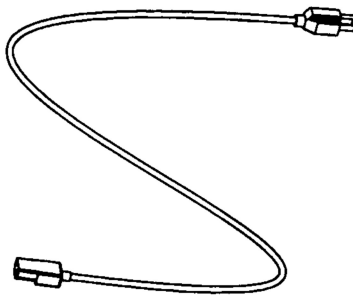

24

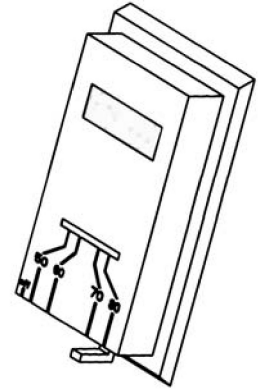

25

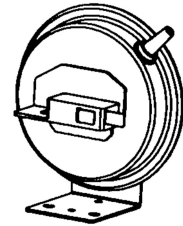

26

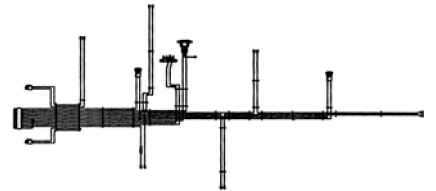

27

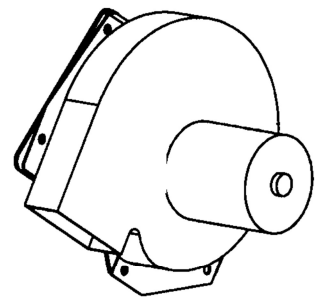

# REPLACEMENT PARTS DIAGRAMS

28

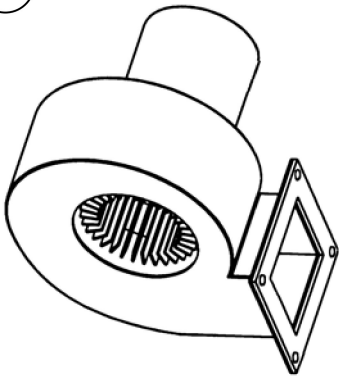

29

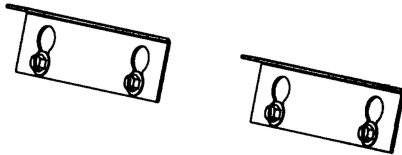

30

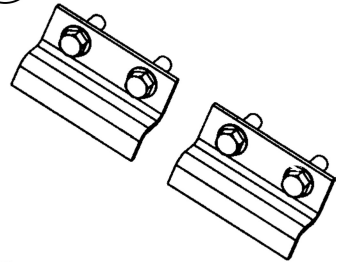

31

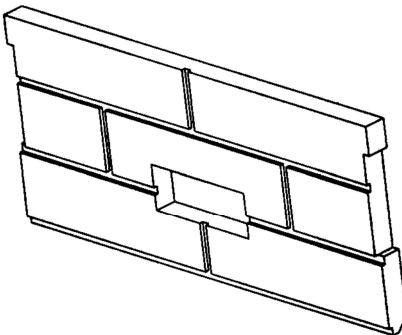

32

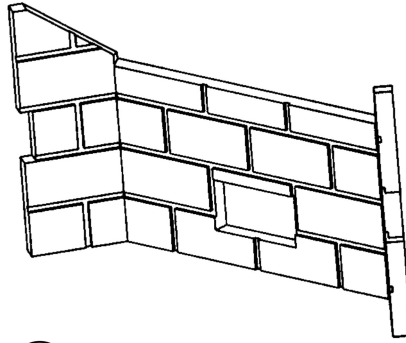

33

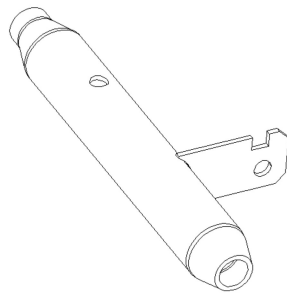

34

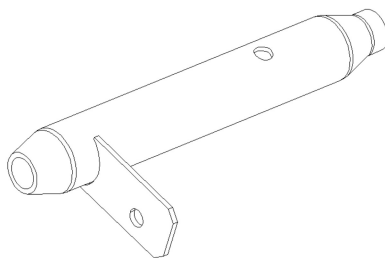

35

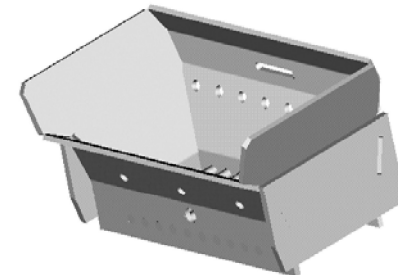

37

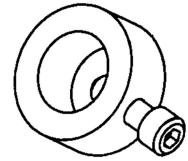

38

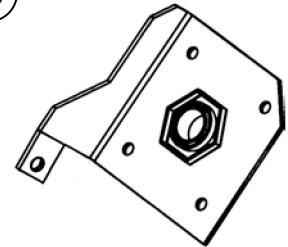

39

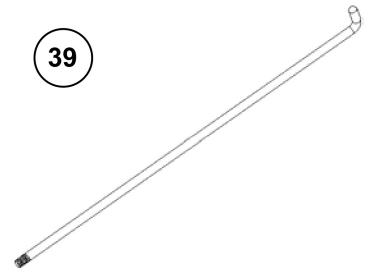

40

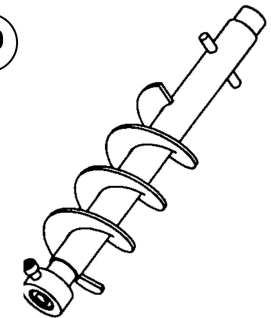

41

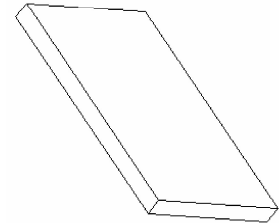

# REPLACEMENT PARTS DIAGRAMS

42

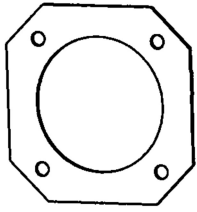

44

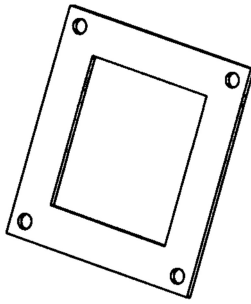

46

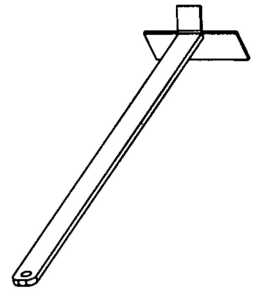

43

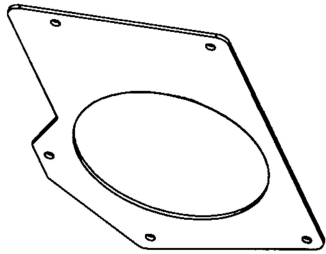

45

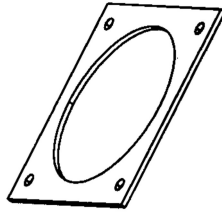

47

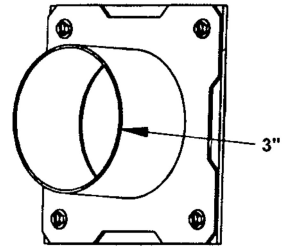

# OPTIONAL ACCESSORIES DIAGRAMS

## Optional Accessories

Item #	Part #	Model	Description	Stove Model
1	H0448	TKAO2-G	Trim Kit, AO2 Gold	Optima 2 FS
1	H0449	TKAO2-N	Trim Kit, AO2 Nickel	Optima 2 FS
1	H0450	TKAO3-G	Trim Kit, AO3 Gold	Optima 3 FS & INS
1	H0451	TKAO3-N	Trim Kit, AO3 Nickel	Optima 3 FS & INS
2	14M81	QDPC-4	Quick Disconnect Pipe Connector, 4"	All
	70K99	TSPK-B	Touch-up Spray Paint Kit, Black	All
3	H0442	SKSAO3	Surround Kit, Small, 30 1/2" x 40 3/4", Black	Optima 3 INS
3	H0443	SKMAO3	Surround Kit, Medium, 34" x 44", Black	Optima 3 INS
3	H0444	SKLAO3	Surround Kit, Large, 38 x 48", Black	Optima 3 INS
4	H0445	STKSAO3	Surround Trim Kit, Small, 30 1/2" x 40 3/4", Gold	Optima 3 INS
4	H0446	STKMAO3	Surround Trim Kit, Medium, 34" x 44", Gold	Optima 3 INS
4	H0447	STKLAO3	Surround Trim Kit, Large, 38 x 48", Gold	Optima 3 INS
5	H0244	DLS-P	Decorative Log Set, Pellet	Optima 2 FS
6	H0464	DLS-AO3	Decorative Log Set	Optima 3 Series
7	H0432	HEK-AO3	Hearth Extension Kit	Optima 3 INS
	H0416	ZCK-PI	Zero Clearance Kit (for installing insert as a built-in)	Optima 3 INS

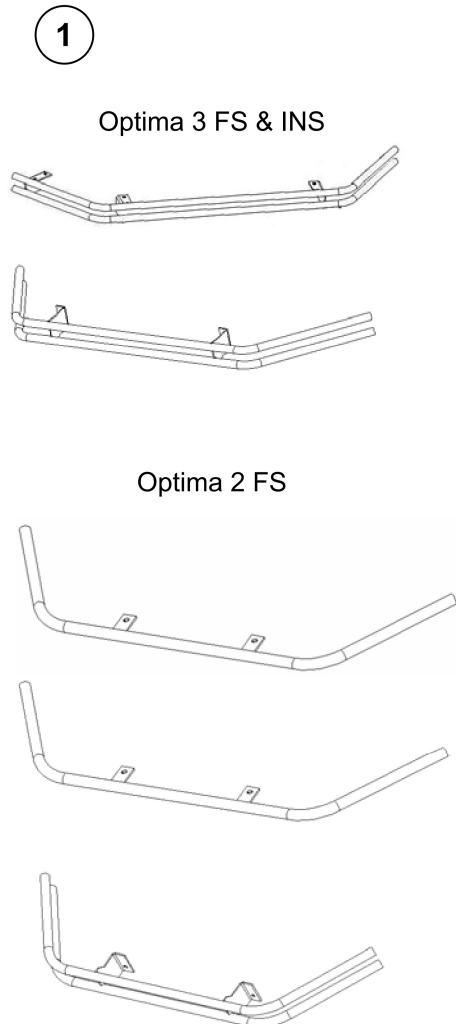

Converts from standard 3" outlet to 4"

