

VIII. ASSEMBLY INSTRUCTIONS, SPECIFICATIONS AND PARTS SELECTION

Model 156

1. Connect one end of hose to adapter at torch inlet. Tighten securely.
2. Connect other end of hose to adapter at regulator. Tighten securely.

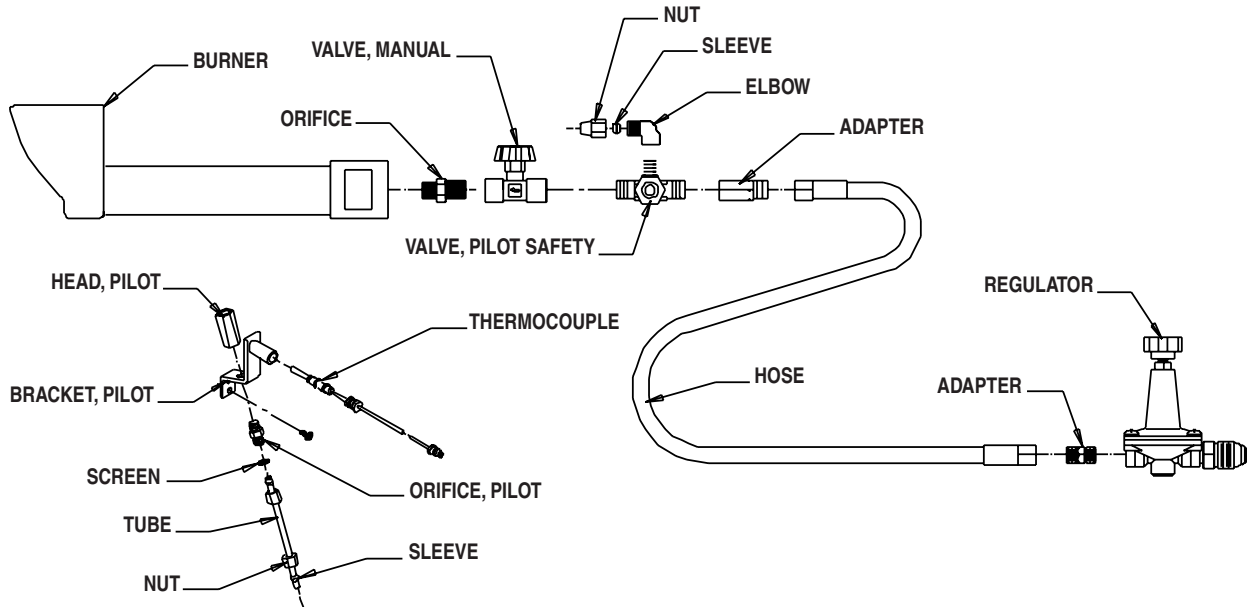

Specifications and Part Numbers

Model	Heat Output	Operating Pressure/Fuel	Torch	Pilot Head	Pilot Orifice	Screen	Sleeve	Nut
156	250,000 BTUH	25 PSIG LP Vapor	Cast Iron 320-03989	400-01079	310-01230	130-01722	130-02543	130-02542

Pilot Bracket	Burner Orifice	Pilot Tube	Thermocouple	Manual Valve	Pilot Safety Valve	Adapter	Hose	Adapter	Regulator
400-03202	310-01329	410-20529	120-05864	130-20229	130-07966	310-07970	550-20703 1/4 in. ID x 10 ft.	310-01098	550-21788

Model 162

1. Connect one end of hose adapter at inlet of needle valve. Tighten securely.
2. Connect other end of hose to adapter at regulator outlet. Secure tightly.

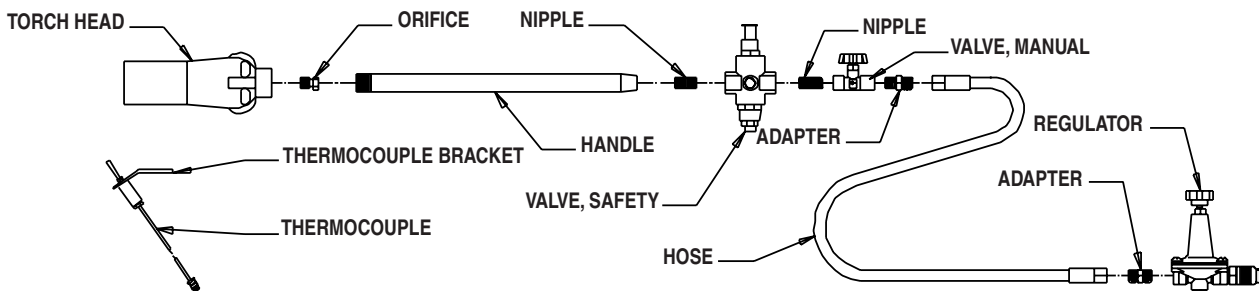

Specifications and Part Numbers

Model	Heat Output	Operating Pressure/Fuel	Torch Head	Handle	Orifice	Nipple	Manual Valve	Hose Adapter	Hose	Regulator	Safety Valve	Thermocouple	Thermocouple Bracket
162	400,000 BTUH	25 PSIG LP Vapor	Cast Iron, 320-03432 2 3/8 in. OD x 7 in.	330-05169 11 in.	310-03416	130-01142	130-20229	310-01098	550-20703 1/4 in. x 10 ft.	550-21788 25 PSIG	130-01108	30 in. 120-01020	400-01094

Models 163

1. Connect one end of hose adapter at inlet of needle valve. Tighten securely.
2. Connect other end of hose to adapter at regulator outlet. Secure tightly.

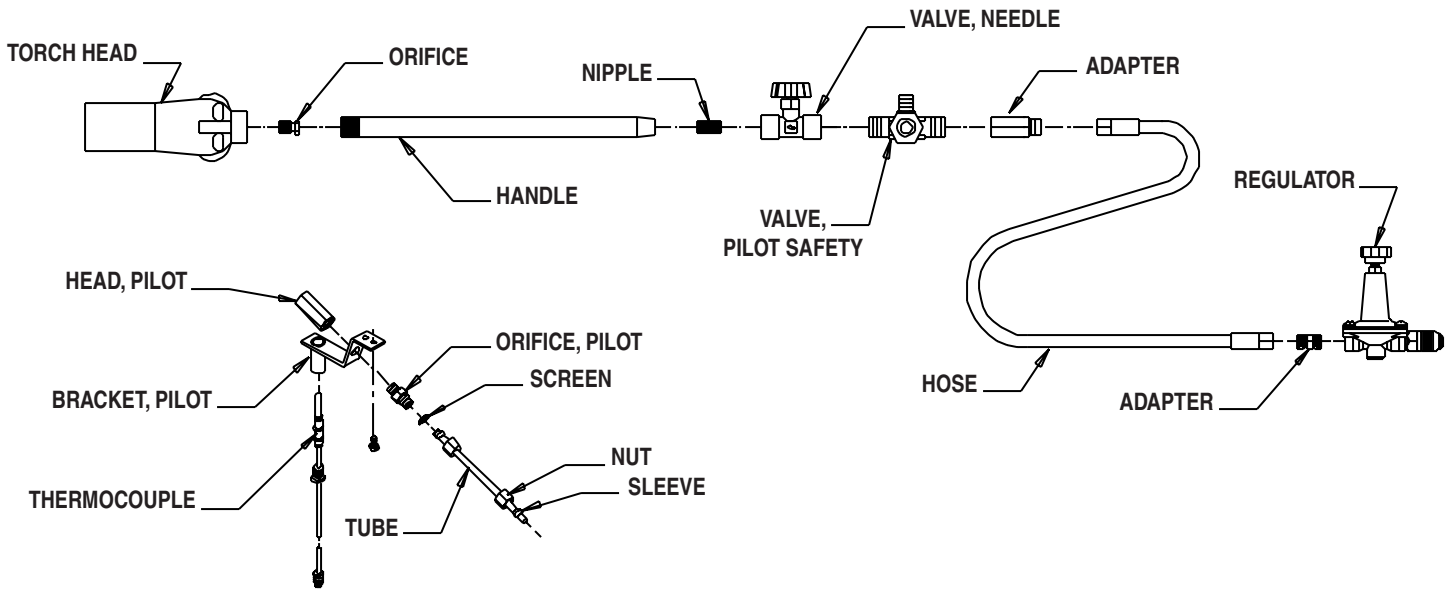

Specifications and Part Numbers

Model	Heat Output	Operating Pressure/Fuel	Torch Head	Handle	Orifice	Nipple	Manual Valve	Hose Adapter (at Regulator)	Hose Adapter (at Pilot Valve)
163	400,000 BTUH	25 PSIG LP Vapor	Cast Iron 320-03432 2 3/8 in. OD x 7 in.	330-01018 13 in.	310-03416	130-01142	130-20229	310-01098	310-07970

Hose	Regulator	Pilot Safety Valve	Thermocouple	Bracket, Pilot	Head, Pilot	Orifice, Pilot	Screen	Tube	Nut	Elbow	Sleeve
550-20703 1/4 in. x 10 ft.	550-21788 25 PSIG	130-07966	30 in. 120-01020	400-03202	400-01079	310-01230	130-01722	130-02550	130-02542	130-07968	130-02543

Models 169 and 171

1. Connect handle coupling onto handle of torch head. Tighten securely.
2. Connect handle into coupling. Tighten securely.
3. Thread hose adapter into inlet of needle valve. Note gas flow arrow on valve body. Tighten securely.
4. Connect manual valve to handle on torch. Note gas flow arrow on valve body. Tighten securely.
5. Attach hose onto hose adapter at needle valve.
6. Connect other end of hose onto POL fitting and tighten securely.

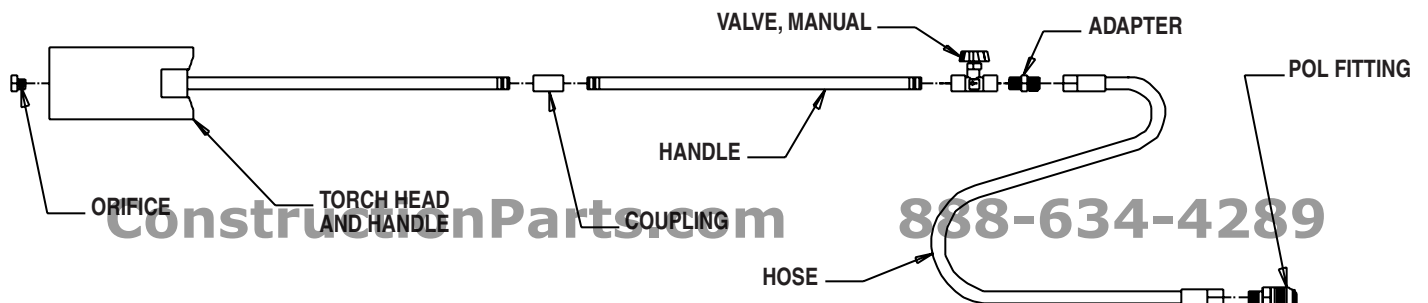

Specifications and Part Numbers

Model	Heat Output	Operating Pressure/Fuel	Torch Head and Handle	Orifice	Handle	Manual Valve	Hose	Hose Adapter	Coupling	P.O.L. Fitting
169	200,000 BTUH	Tank Pressure	420-06383 Tubular Steel 3 in. OD x 6 in.*	310-05166	410-05161 14 in.	130-20229	550-20703 1/4 in. OD x 10 ft.	310-01098	130-02954	130-05170
171	500,000 BTUH	LP Vapor	420-06164 Tubular Steel 3 in. OD x 6 in.*	310-05168						

* Torch head dimension only. Handle welded to head is 14 in. length.

Models 166 (BIG BERTHA) and 168 (LITTLE BERTHA)

1. Connect nipple into handle of torch. Tighten securely.
2. Connect manual valve to nipple. Note gas flow arrow on valve body. Tighten securely.
3. Connect hose adapter to inlet of manual valve. Tighten securely.
4. Connect hose to adapters at needle valve and regulator outlet. Tighten securely.

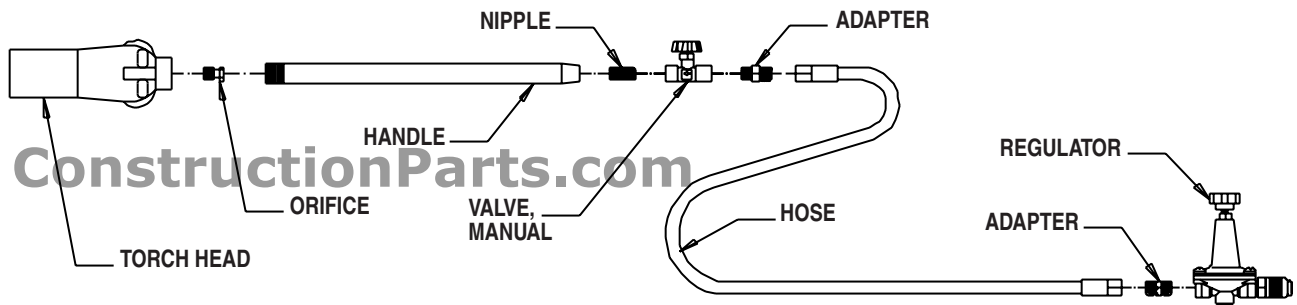

Specifications and Part Numbers

Model	Heat Output	Operating Pressure/Fuel	Torch Head with Orifice	Orifice	Handle	Nipple	Manual Valve	Hose Adapter	Hose	Regulator
166	500,000 BTUH	25 PSIG	320-02856 Cast Iron 2 3/8 in. OD x 8 in.	310-01016	330-05169 11 in.	130-01142	130-20229	310-01098	550-20703 1/4 in. OD x 10 ft.	550-21788 25 PSI
168	200,000 BTUH	LP Vapor	320-02854 Cast Iron 2 in. OD x 7 in.	310-10132						

Model 164

ConstructionParts.com

888-634-4289

This torch is completely assembled and tested by the factory prior to shipment. Assembly is not required.

IMPORTANT

The Model 164 natural gas torch requires a maximum of 15 PSIG and a minimum of 10 PSIG at the inlet of the regulator to achieve the 7 PSIG outlet pressure necessary to obtain rated heat output.

Make sure your natural gas utility is capable of supplying this pressure to the inlet of the regulator.

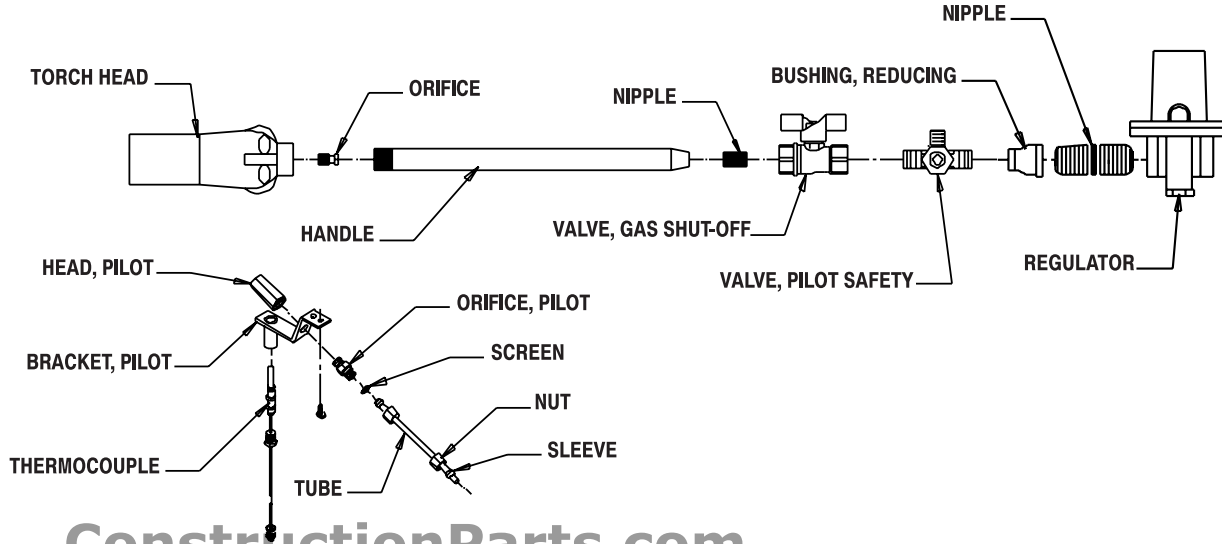

ConstructionParts.com

Specifications and Part Numbers

Model	BTUH	Operating Pressure/Fuel	Torch Head	Handle	Orifice	Manual Valve	Hose*	Regulator
164	365,000 BTUH	Inlet Max. 15 PSIG Inlet Min. 10 PSIG Outlet 7 PSIG Natural Gas	Cast Iron 320-01014 2 1/3 in. OD x 8 in.	330-01018 13 in.	310-01081	130-09698	550-20704 1/2 in. ID x 10 ft.	550-01104 7 PSIG

* Hose is ordered as an accessory and does not ship as standard with the torch.

Pilot Safety Valve	Thermocouple	Bracket, Pilot	Head, Pilot	Orifice, Pilot	Tube, Pilot	Nut	Sleeve
130-07966	36 in. 120-03066	400-03202	400-01079	310-01520	550-07079	130-02542	130-02543

ConstructionParts.com

888-634-4289