



**SPE**<sup>™</sup>  
Surface Preparation Equipment<sup>™</sup>  
BEF 275

# **BEF275-1**

## **Operating Manual**

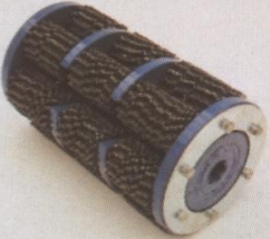

## ACCESSORIES

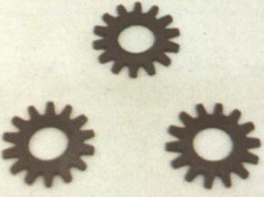
| Part No   | Description  | Application   |  |
|---|--------------|---|--|
|    | <b>27501</b> | Heavy duty drum complete with T.C.T cutters and spacers.                  | For all concrete texturing, scabbling planing and grooving applications. Removal of bridge deck and car park membranes, heavy industrial contamination, epoxy coatings and road markings, reducing concrete. Use on heavy applications for longer life with higher output. |
|   | <b>27502</b> | Heavy duty drum complete with beam flails.                                | For the removal of paint, laitence and coatings from floors. De-rusting and de-scaling ship decks. Also used for removing build up of grease, dirt and ice deposits. Keying of concrete when a fine textured surface is required   |
|  | <b>27504</b> | Heavy duty drum complete with milling cutters and spacers                 | For removal of thermoplastic road/runway markings. Very efficient and cost effective with none of the problems associated with burning off thermoplastics. Also for the removal of bituminous and rubber deposits.   |
|  | <b>60600</b> | T.C.T Cutter: 6 point hardened steel cutter with tungsten carbide inserts | For all concrete texturing, scabbling planing and grooving applications. Removal of bridge deck and car park membranes, heavy industrial contamination, epoxy coatings and road markings, reducing concrete. Use on heavy applications for longer life with higher output. |
|  | <b>60120</b> | Beam cutter: Heat treated steel cutter                                    | For the removal of paint, laitence and coatings from floors. De-rusting and de-scaling ship decks. Also used for removing build up of grease, dirt and ice deposits. Keying of concrete when a fine textured surface is required.  |

## BEF275-1 ACCESSORIES

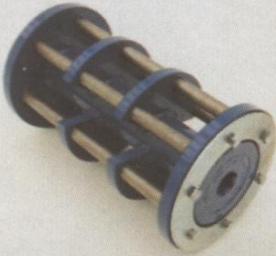
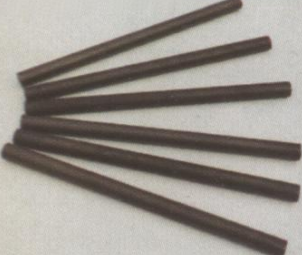
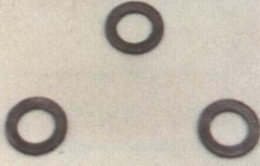
|   |                     |  |  |
|---|---------------------|--|--|
|    | <p><b>60620</b></p> | <p>Milling Cutter: Tipped with Tungsten carbide.</p> | <p>For the removal of thermoplastic road/runway markings, rubber based deposits and cold plastic coatings from asphalt and concrete.</p> |
|    | <p><b>27500</b></p> | <p>Heavy duty drum complete with flail shafts.</p>   | <p>For use with various cutter configurations.</p>   |
|   | <p><b>27518</b></p> | <p>Heavy duty flail shaft.</p>                       | <p>Hardened cutter shaft.</p>  |
|  | <p><b>40240</b></p> | <p>Spacing washer.</p>                               | <p>Hardened spacing washer.</p>  |

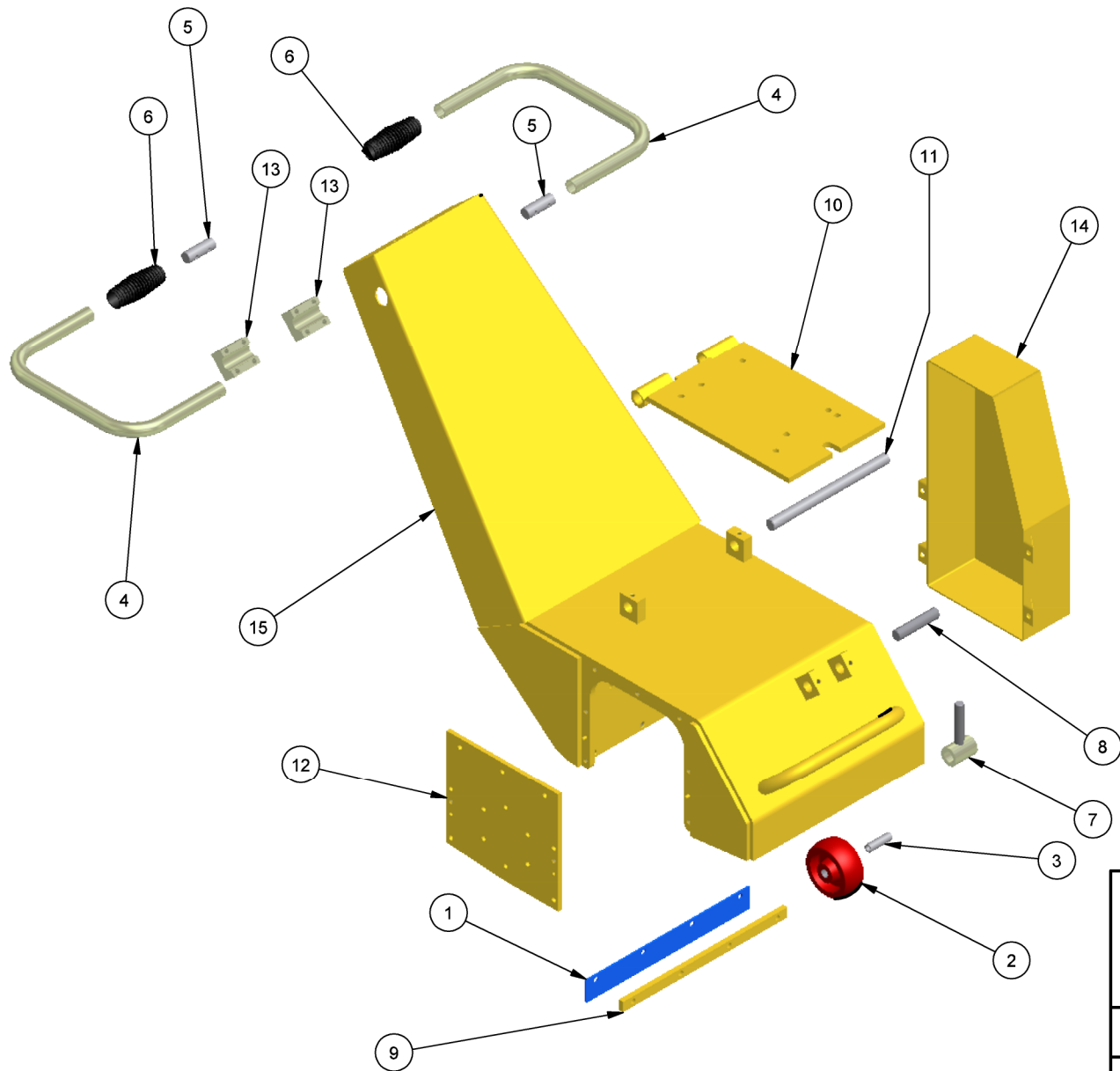

| Parts List |     |                 |                     |
|------------|-----|-----------------|---------------------|
| ITEM       | QTY | SPE PART NUMBER | DESCRIPTION         |
| 1          | 1   | 2005            | Dust Strip          |
| 2          | 1   | 2008            | Front Wheel         |
| 3          | 1   | 2007            | Front Axle          |
| 4          | 2   | 7107B           | Half Handle         |
| 5          | 2   | 7107A           | Handle Connector    |
| 6          | 2   | 9104            | Handlebar Grip      |
| 7          | 1   | 3017            | T-Bar               |
| 8          | 1   | 3018            | Swivel Pin (T-Bar)  |
| 9          | 1   | 2006            | Dust Strip Retainer |
| 10         | 1   | 2036            | Motor Mount         |
| 11         | 1   | 2037            | Motor Pivot         |
| 12         | 1   | 2145            | Side Plate          |
| 13         | 2   | 2038            | Handle Clamp Block  |
| 14         | 1   | 2021            | Belt Guard          |
| 15         | 1   | 2001            | Chassis             |



**SPE**  
Surface Preparation Equipment™

SPE International Limited  
Honeyholes Lane, Dunholme  
Lincoln. LN2 3SU, England  
Tel: +44 (0) 1673 860 709  
or +44 (0) 1673 860 330  
Fax: +44 (0) 1673 861 119  
Web Site: <http://www.spe-int.com>  
E-mail: [sales@spe-int.com](mailto:sales@spe-int.com)

**THIS DRAWING IS THE CONFIDENTIAL COPYRIGHT PROPERTY OF SPE INTERNATIONAL LIMITED**

|         |                |                 |
|---------|----------------|-----------------|
| Drawn   | TITLE          | Body Components |
| D.G.A.  |                |                 |
| Checked | Drawing No.    | MACHINE         |
| P.A.    | BEF-275_Bdy-01 | BEF 275-1       |

*This drawing should not be used, copied, shown or handed to a third party without the prior written consent of SPE International Ltd.*

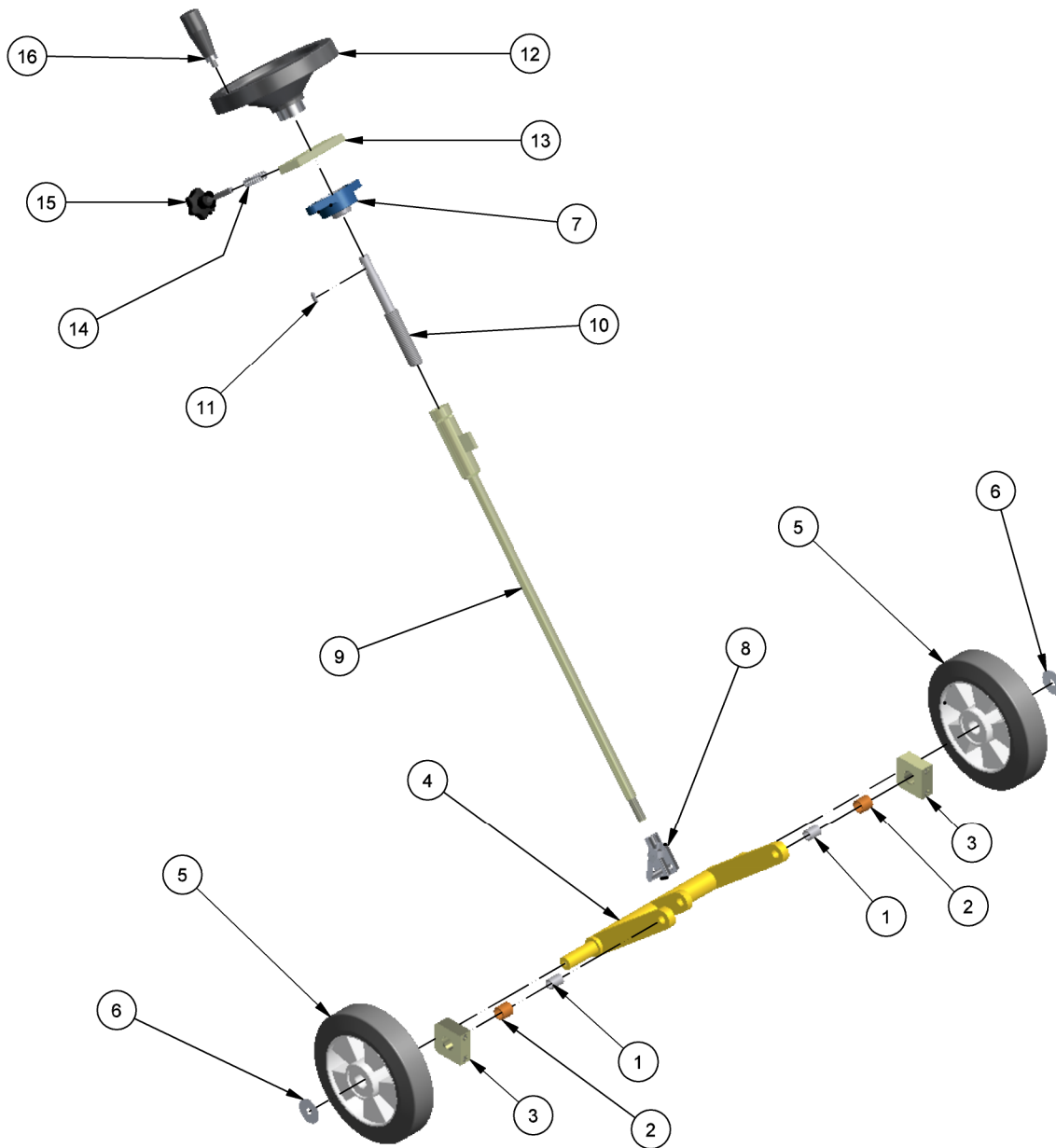

| Parts List |     |                 |                      |
|------------|-----|-----------------|----------------------|
| ITEM       | QTY | SPE PART NUMBER | DESCRIPTION          |
| 1          | 2   | 2009            | Pivot Sleeve         |
| 2          | 2   | 2010            | Oilite Bush          |
| 3          | 2   | 2011            | Swing Arm Support    |
| 4          | 1   | 2012            | Swinging Arm         |
| 5          | 2   | 2013            | Rear Wheel           |
| 6          | 2   | WASH001         | M10x40 Repair Washer |
| 7          | 1   | 9134            | Bearing              |
| 8          | 1   | 9122            | Clevis Assembly      |
| 9          | 1   | 2015            | Height Tube          |
| 10         | 1   | 2016            | Height Screw         |
| 11         | 1   | 9113A           | 4x16 Parallel Key    |
| 12         | 1   | 2020            | Hand Wheel           |
| 13         | 1   | 9155            | Anit-Vibration Plate |
| 14         | 1   | 2124            | Spring               |
| 15         | 1   | 2019            | Tri-Screw            |
| 16         | 1   | 2020B           | Revolving Handle     |

**SPE**  
 Surface Preparation Equipment™

SPE International Limited  
 Honeyholes Lane, Dunholme  
 Lincoln. LN2 3SU, England  
 Tel: +44 (0) 1673 860 709  
 or +44 (0) 1673 860 330  
 Fax: +44 (0) 1673 861 119  
 Web Site: <http://www.spe-int.com>  
 E-mail: [sales@spe-int.com](mailto:sales@spe-int.com)

**THIS DRAWING IS THE CONFIDENTIAL COPYRIGHT PROPERTY OF SPE INTERNATIONAL LIMITED**

|         |                                |           |
|---------|--------------------------------|-----------|
| Drawn   | TITLE Undercarriage Components |           |
| D.G.A.  |                                |           |
| Checked | Drawing No.                    | MACHINE   |
| P.A.    | BEF-275_Unc-01                 | BEF 275-1 |

*This drawing should not be used, copied, shown or handed to a third party without the prior written consent of SPE International Ltd.*

| Parts List |     |                 |                      |
|------------|-----|-----------------|----------------------|
| ITEM       | QTY | SPE PART NUMBER | DESCRIPTION          |
| 1          | 1   | 2024            | Bottom Pulley        |
| 2          | 1   | 2026            | D/S Bearing Housing  |
| 3          | 1   | 2025            | D/S Shaft Support    |
| 4          | 1   | 2031            | Drive Shaft          |
| 5          | 2   | 2136            | Bearing              |
| 6          | 2   | 2134            | Int. Circlip         |
| 7          | 1   | 2027            | Bearing Spacer       |
| 8          | 1   | 2135            | Ext. Circlip         |
| 9          | 1   | 2033            | S/S Bearing Housing  |
| 10         | 1   | 2034            | S/S Spacer           |
| 11         | 1   | 2137            | Bearing              |
| 12         | 1   | 2032            | S/S Shaft Support    |
| 13         | 1   | 2138            | Ext. Circlip         |
| 14         | 1   | 2143            | Honda Petrol Engine  |
| 15         | 1   | 2029            | Petrol Engine Pulley |
| 16         | 4   | 2022            | Drive Belt           |
| 17         | 1   | 2028            | Drum Spacer          |

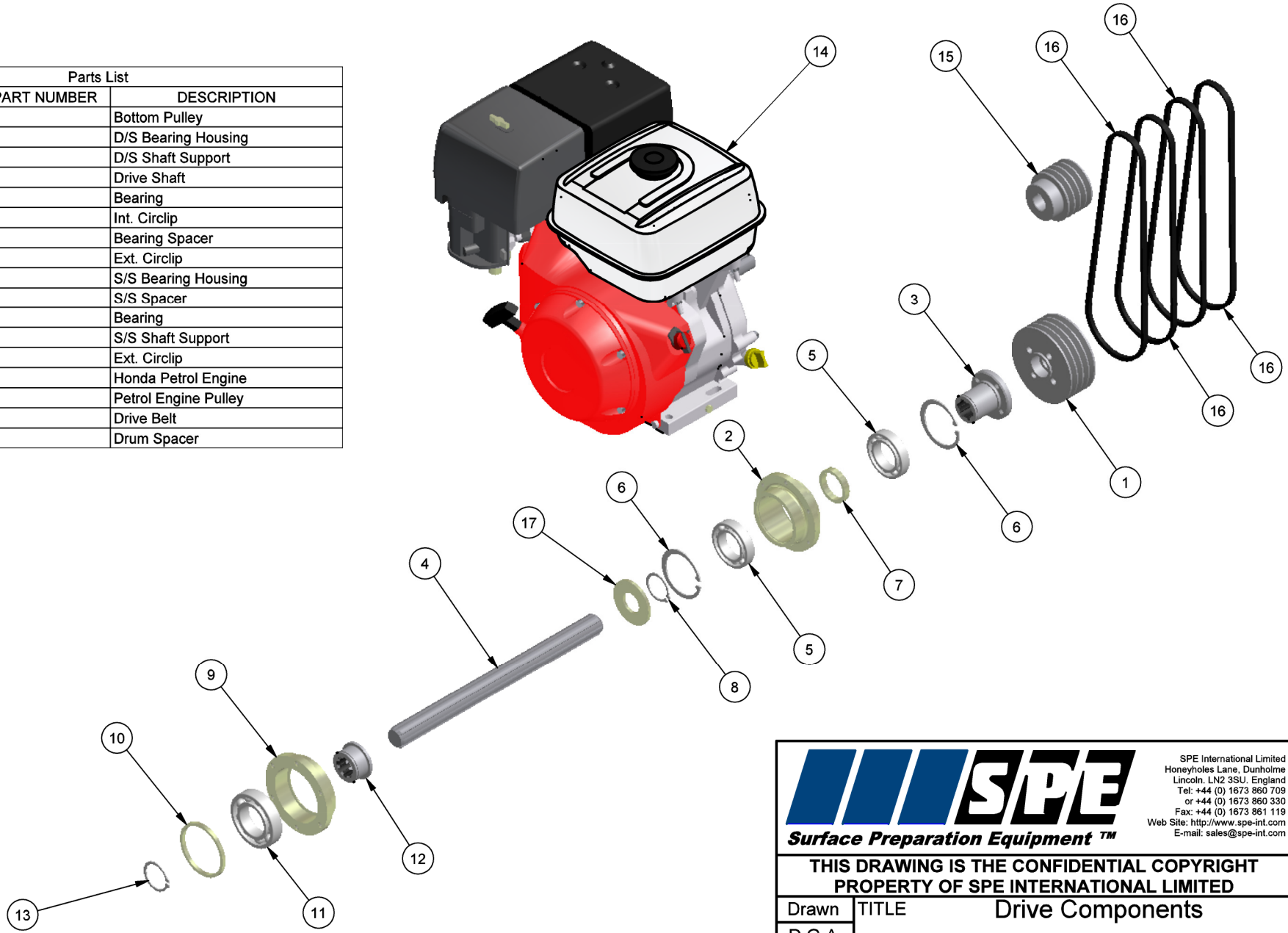

**SPE**  
Surface Preparation Equipment™

SPE International Limited  
Honeyholes Lane, Dunholme  
Lincoln. LN2 3SU, England  
Tel: +44 (0) 1673 860 709  
or +44 (0) 1673 860 330  
Fax: +44 (0) 1673 861 119  
Web Site: <http://www.spe-int.com>  
E-mail: [sales@spe-int.com](mailto:sales@spe-int.com)

|   |                |                  |
|---|----------------|------------------|
| THIS DRAWING IS THE CONFIDENTIAL COPYRIGHT<br>PROPERTY OF SPE INTERNATIONAL LIMITED |                |                  |
| Drawn   | TITLE          | Drive Components |
| D.G.A.  |                |                  |
| Checked   | Drawing No.    | MACHINE          |
| P.A.  | BEF-275_Drv-01 | BEF 275-1        |

This drawing should not be used, copied, shown or handed to a third party without the prior written consent of SPE International Ltd.

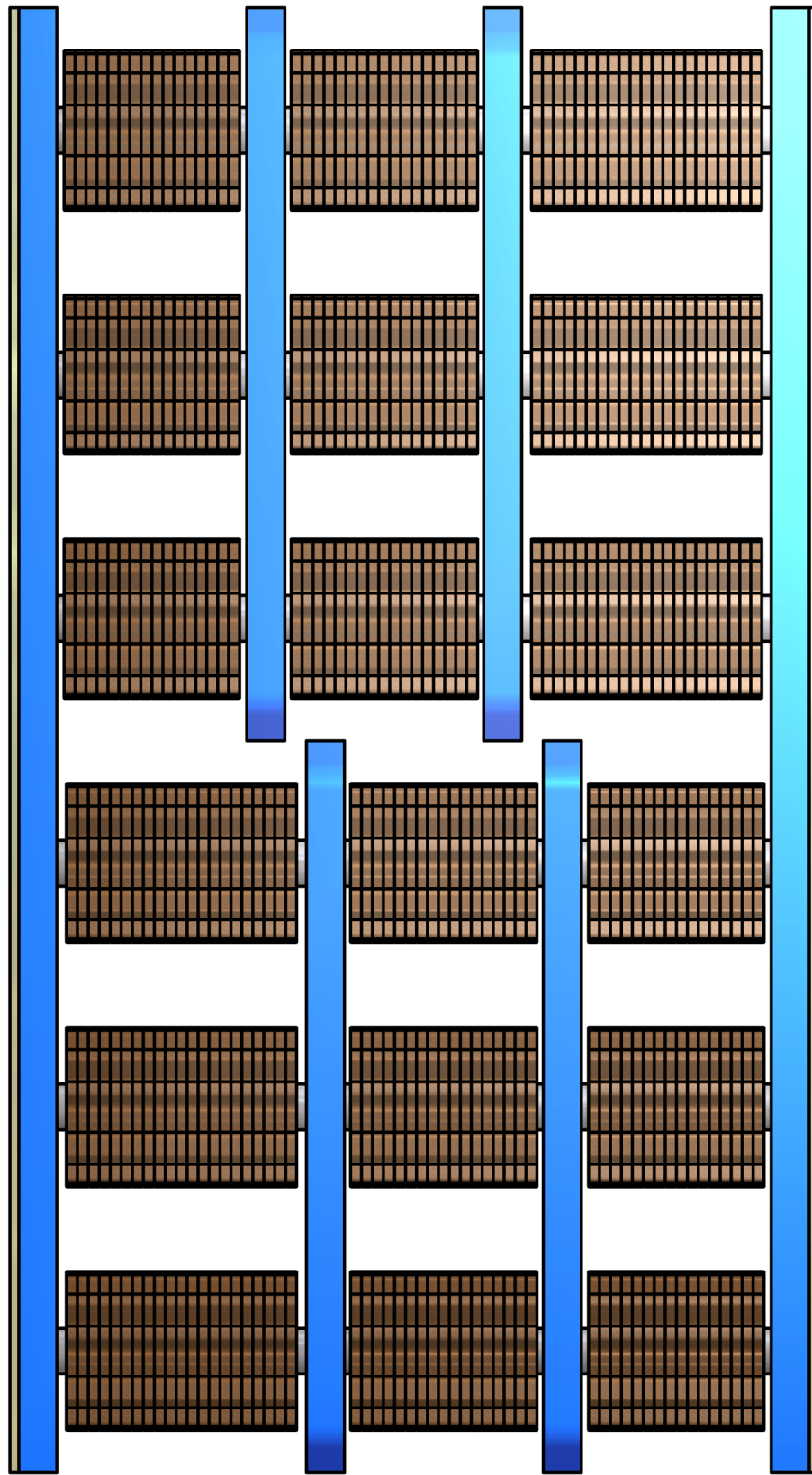

| Parts List |             |             |
|------------|-------------|-------------|
| QTY        | PART NUMBER | DESCRIPTION |
| 324        | 60120       | Beam Flail  |

*This drawing should not be used, copied, shown or handed to a third party without the prior written consent of SPE International Ltd.*



SPE International Limited  
 Honeyholes Lane, Dunholme  
 Lincoln, LN2 3SU, England  
 Tel: +44 (0) 1673 860 709  
 or +44 (0) 1673 860 330  
 Fax: +44 (0) 1673 861 119  
 Web Site: <http://www.spe-int.com>  
 E-mail: [sales@spe-int.com](mailto:sales@spe-int.com)

**THIS DRAWING IS THE CONFIDENTIAL COPYRIGHT  
 PROPERTY OF SPE INTERNATIONAL LIMITED**

|         |                            |         |
|---------|----------------------------|---------|
| Drawn   | TITLE Drum c/w Beam Flails |         |
| D.G.A.  |                            |         |
| Checked | Drawing No.                | MACHINE |
| P.A.    | BEF-275_Drum-BF            | BEF 275 |

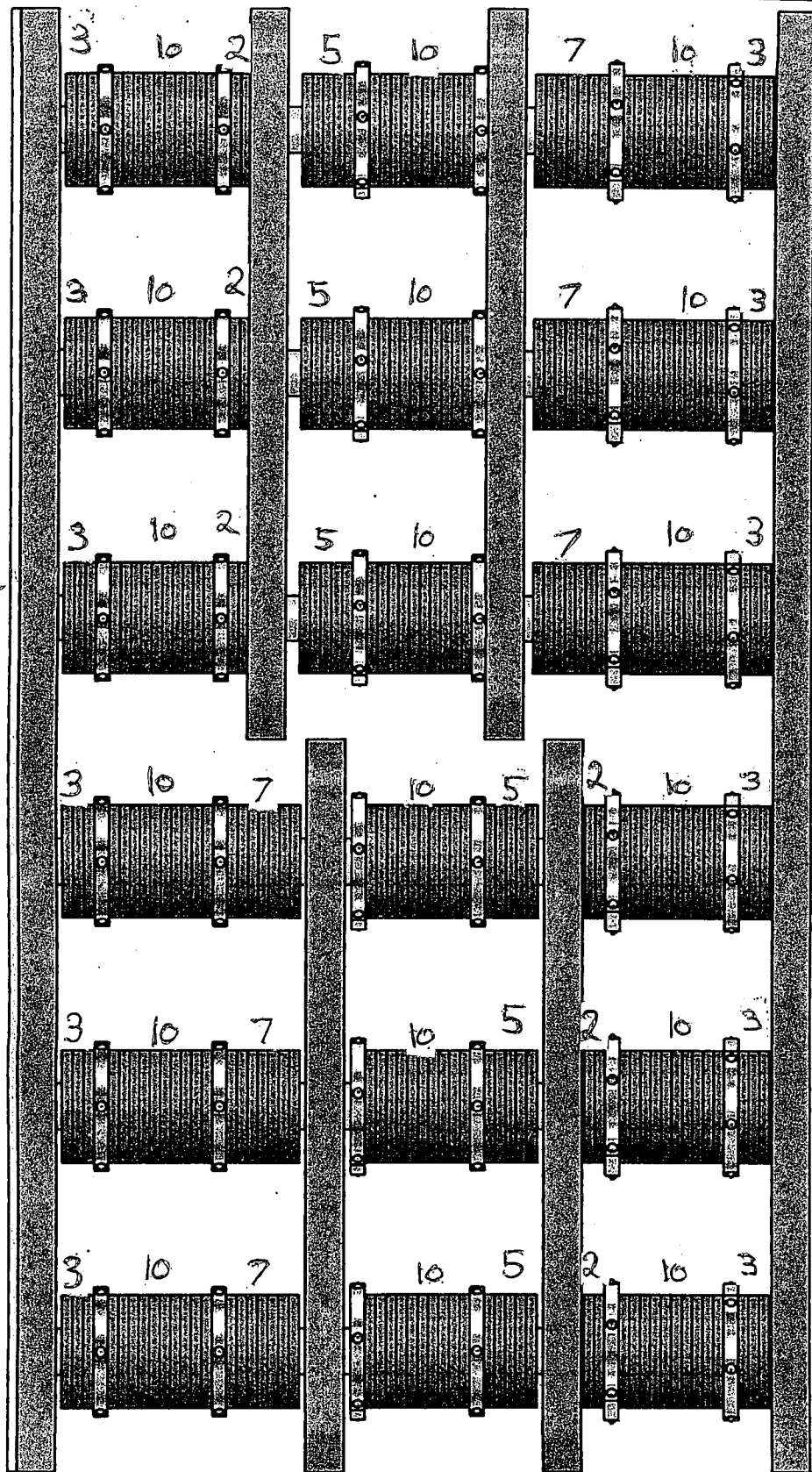

| Parts List |                 |             |
|------------|-----------------|-------------|
| QTY        | SPE PART NUMBER | DESCRIPTION |
| 300        | 40240           | Spacer      |
| 36         | 60600           | TCT         |

*This drawing should not be used, copied, shown or handed to a third party without the prior written consent of SPE International Ltd.*



SPE International Limited  
 Honeyholes Lane, Dunholme  
 Lincoln, LN2 3SU, England  
 Tel: +44 (0) 1673 860 709  
 or +44 (0) 1673 880 330  
 Fax: +44 (0) 1673 861 119  
 Web Site: <http://www.spe-int.com>  
 E-mail: [sales@spe-int.com](mailto:sales@spe-int.com)

|   |                                   |         |
|---|-----------------------------------|---------|
| <b>THIS DRAWING IS THE CONFIDENTIAL COPYRIGHT PROPERTY OF SPE INTERNATIONAL LIMITED</b> |                                   |         |
| Drawn   | TITLE 50mm Grooving Drum c/w TCTs |         |
| D.G.A.  |                                   |         |
| Checked   | Drawing No.                       | MACHINE |
| R.C.  | BEF-275_Drum-50G                  | BEF 275 |

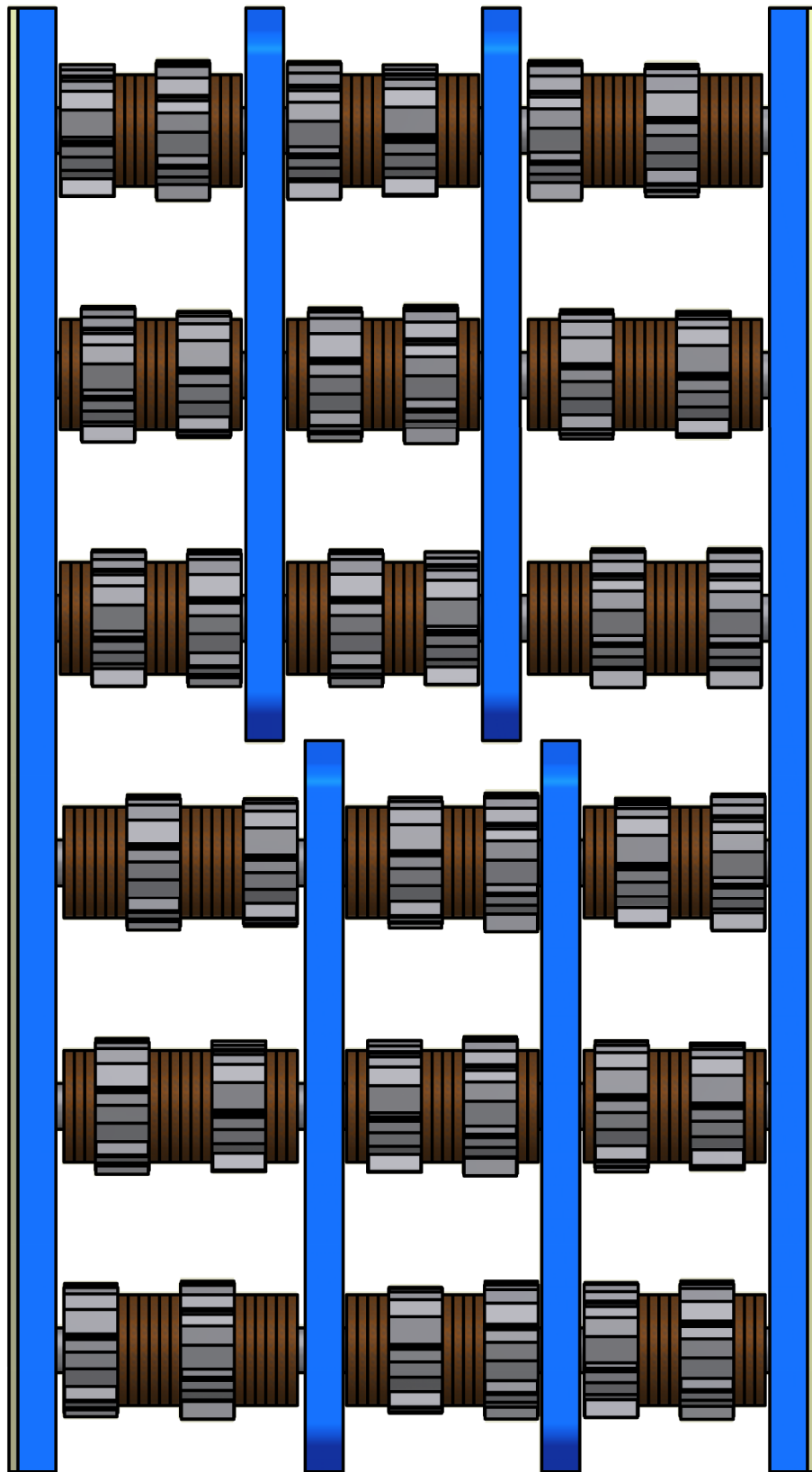

Parts List

| QTY | SPE PART NUMBER | DESCRIPTION    |
|-----|-----------------|----------------|
| 36  | 60602           | Milling Cutter |
| 162 | 40240           | Spacer         |

*This drawing should not be used, copied, shown or handed to a third party without the prior written consent of SPE International Ltd.*



SPE International Limited  
 Honeyholes Lane, Dunholme  
 Lincoln, LN2 3SU, England  
 Tel: +44 (0) 1673 860 709  
 or +44 (0) 1673 860 330  
 Fax: +44 (0) 1673 861 119  
 Web Site: <http://www.spe-int.com>  
 E-mail: [sales@spe-int.com](mailto:sales@spe-int.com)

**THIS DRAWING IS THE CONFIDENTIAL COPYRIGHT PROPERTY OF SPE INTERNATIONAL LIMITED**

|         |                                   |         |
|---------|-----------------------------------|---------|
| Drawn   | TITLE<br>Drum c/w Milling Cutters |         |
| D.G.A.  |                                   |         |
| Checked | Drawing No.                       | MACHINE |
| P.A.    | BEF-275_Drum-MC                   | BEF 275 |

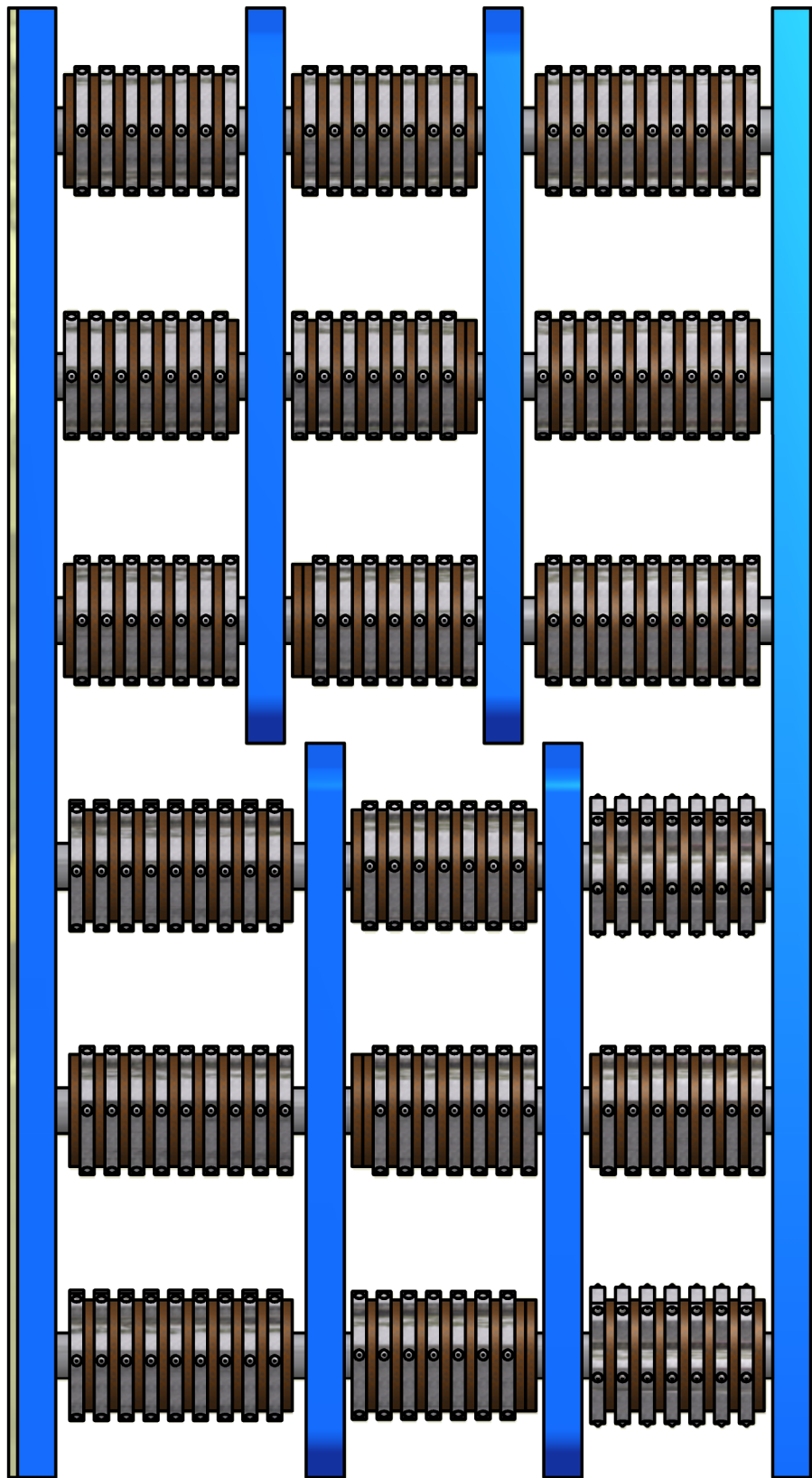

| Parts List |             |             |
|------------|-------------|-------------|
| QTY        | PART NUMBER | DESCRIPTION |
| 144        | 40240       | Spacer      |
| 138        | 60600       | TCT         |

*This drawing should not be used, copied, shown or handed to a third party without the prior written consent of SPE International Ltd.*



SPE International Limited  
 Honeyholes Lane, Dunholme  
 Lincoln, LN2 3SU, England  
 Tel: +44 (0) 1673 860 709  
 or +44 (0) 1673 860 330  
 Fax: +44 (0) 1673 861 119  
 Web Site: <http://www.spe-int.com>  
 E-mail: [sales@spe-int.com](mailto:sales@spe-int.com)

**THIS DRAWING IS THE CONFIDENTIAL COPYRIGHT PROPERTY OF SPE INTERNATIONAL LIMITED**

|         |                                      |         |
|---------|--------------------------------------|---------|
| Drawn   | TITLE Drum c/w Tungsten Carbide Tips |         |
| D.G.A.  |                                      |         |
| Checked | Drawing No.                          | MACHINE |
| P.A.    | BEF-275_Drum-TCT                     | BEF 275 |