



HEARTH PRODUCTS

HOMEOWNER'S CARE AND OPERATION INSTRUCTIONS

ELITE™ SERIES

41" Wood Burning Fireplaces
P/N 504,218M REV. D 04/2007

MODELS

LA41CF

LA41TCF

The information contained in this manual applies to all model fireplaces identified on this page. This information will help you obtain safe and dependable service from your Lennox fireplace system. Keep this document in a safe place for future reference.

Before you start your first fire, read this Care and Operations Manual carefully to be sure you understand your fireplace system completely. Failure to follow these suggestions could result in hazardous operation or fireplace malfunction, creating a serious potential for personal injury and/or property damage.

If you have any questions regarding the safe use or operation of your fireplace, contact your local Lennox Dealer or your contractor/builder.

**RETAIN THESE INSTRUCTIONS
FOR FUTURE REFERENCE**



WH Report No. J20017261-231

REPLACEMENT PARTS

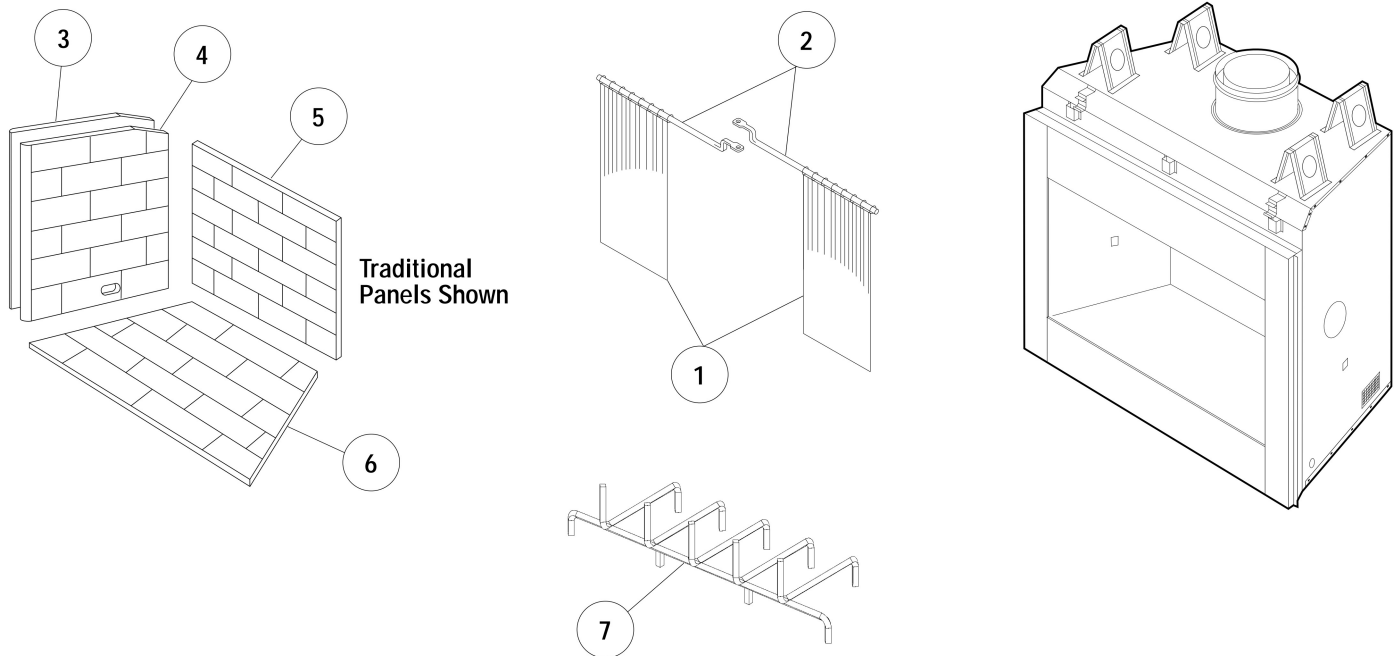

No.	DESCRIPTION	Model LA41	
		Part No.	Qty.
	Fireplace Assembly	-	-
1.	Firescreen	52L52	2
2.	Rod, Screen	88L89	2
3.	Refractory, Side, Right (Traditional)	52L50	1
	Refractory, Side, Right (Tudor)	52L55	1
4.	Refractory, Side, Left (Traditional)	52L50	1
	Refractory, Side, Left (Tudor)	52L59	1
5.	Refractory, Rear (Traditional)	52L49	1
	Refractory, Rear (Tudor)	52L54	1
6.	Refractory Base	52L53	1
7.	Grate	92L91	1

NOTE: DIAGRAMS & ILLUSTRATIONS NOT TO SCALE.

Lennox Hearth Products reserves the right to make changes at any time, without notice, in design, materials, specifications, prices and also to discontinue colors, styles and products. Consult your local distributor for fireplace code information.

LENNOX™

HEARTH PRODUCTS

1110 West Taft Avenue
Orange, CA 92865