

Parts Identification

Infraconic I-17 M
Model I-17C

888-634-4289

PARTS SCHEMATIC

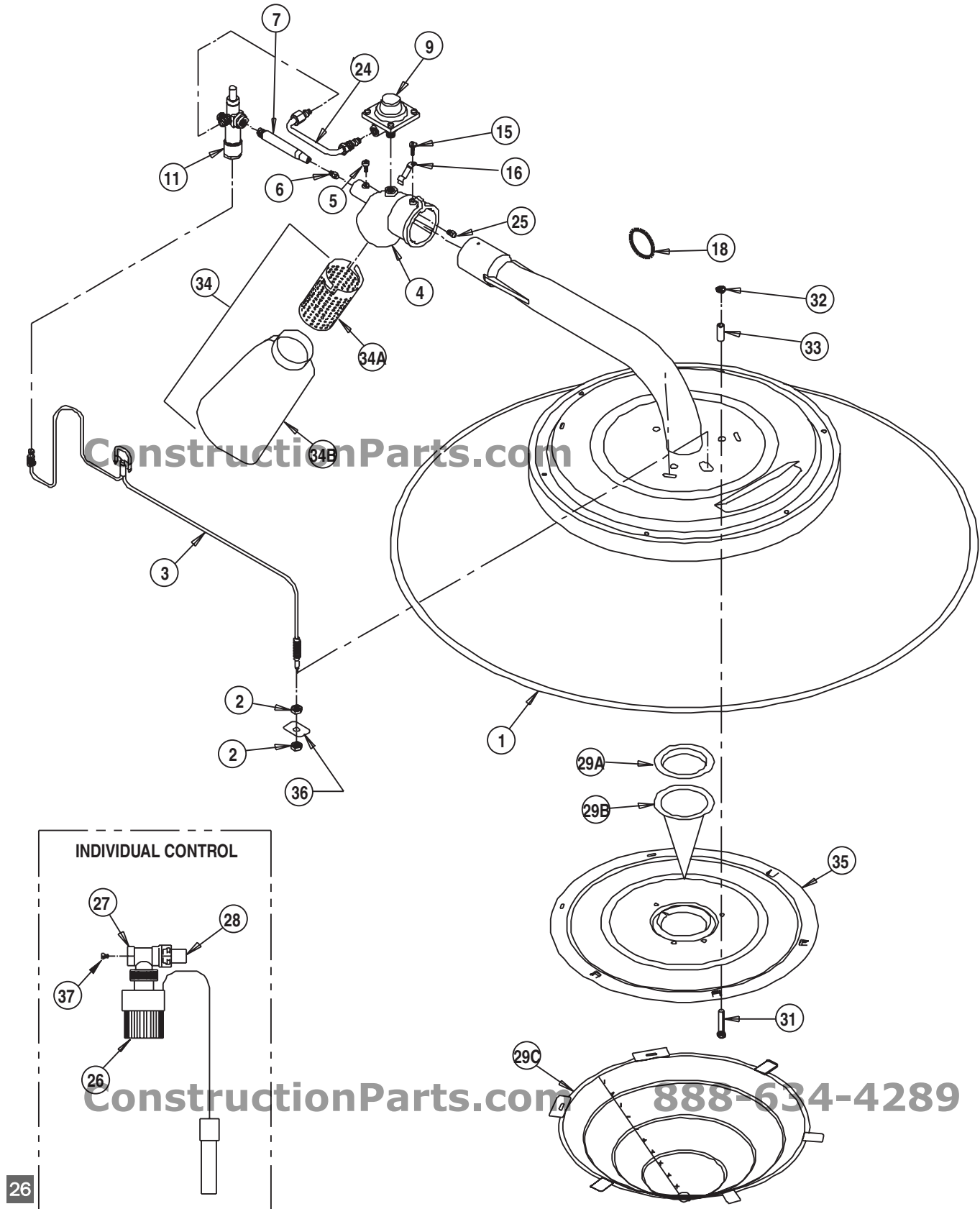

ConstructionParts.com

ConstructionParts.com

888-634-4289

PARTS LIST

Item	Description	Part No.
1	Venturi Tube and Burner Assembly	09639
2	Thermocouple Retaining Nut	09576
3	Thermocouple with Fusible Link	09574
4	Injector Casting with Air Register Plate	Propane Gas 09591 Natural Gas 09774
5	Retaining Screw for Injector Tube	09572
6	Primary Burner Orifice (Low Heat)	Propane Gas 09594 Natural Gas 09773
7	Injector Tube	09597
9	Pressure Valve	09861
11	Safety Control Valve	Zone Control Heaters 22285 Individual Control Heaters 22286
15	Retaining Screw for Control Assembly and Thermocouple	09575
16	Thermocouple Fuse Clip	09565
18	Keyring	09620
24	Tubing, Pilot Safety Valve to Pressure Valve	09590
25	Secondary Orifice (High Heat)	Propane Gas 09593 Natural Gas 09772
26	Thermostatic Head with Sensor, Individual Control	09415
27	Valve, Modulating	Propane Gas 09750 Natural Gas 09751
28	Sleeve, Adapter	09682
29	Kit, Combustion Cones and Gasket Consisting of:	21087
29A	Gasket	09586-A
29B	Inner Cone	09585
29C	Outer Cone	09588
31	Screw, 10-32 x 1 1/2	23636
32	Nut, 10-32	09578
33	Spacer	09568
34	Filter Kit	20427
34A	Filter Sleeve	20321
34B	Filter	20361
35	Burner Plate	21953-01
36	Cover Plate, Thermocouple	23315
37	Orifice, Bypass (Individual Control)	Propane Gas 09746 Natural Gas 09745

OPTIONS (Not Illustrated):

Description	Part No.
Coupling, Quick Disconnect, Kit Consisting Of:	21335
Shut-Off Valve	05548
Nipple, 1/4 in. Close	01142
Coupling, Quick Disconnect	21328
Bushing, 1/2 x 1/4	01519
Hoses 1/4 in. x 6 ft., Rigid x Swivel, Poultry	20495
1/4 in. x 10 ft., Rigid x Swivel, Poultry	20496
1/4 in. x 12 ft., Rigid x Swivel, Poultry	20497
1/4 in. x 6 ft., Swivel Both Ends, Swine	20499
1/4 in. x 10 ft., Swivel Both Ends, Swine	20242
1/4 in. x 15 ft., Swivel Both Ends, Swine	20500
Kit, 1/8 NPT Fitting (Not Illustrated)	23406