



# CARE AND OPERATION INSTRUCTIONS

## WOOD-BURNING FIREPLACES MODELS BC36MH & BCD36MH



36" Wood-Burning Fireplaces  
P/N 725042M Rev. B 10/2011

### MODELS

**BC36MH**

**BCD36MH**

The information contained in this manual applies to all model fireplaces identified on this page. This information will help you obtain safe and dependable service from your fireplace system. Keep this document in a safe place for future reference.

Before you start your first fire, read this Care and Operations Manual carefully to be sure you understand your fireplace system completely. Failure to follow these suggestions could result in hazardous operation or fireplace malfunction, creating a serious potential for personal injury and/or property damage.

If you have any questions regarding the safe use or operation of your fireplace, contact your local distributor or your contractor/builder.

Most chimney systems will require onsite completion after placement of the manufactured home.



We recommend that our woodburning hearth products be installed and serviced by professionals who are certified in the U.S. by the National Fireplace Institute® (NFI) as NFI Woodburning Specialists or who are certified in Canada by Wood Energy Technical Training (WETT).



### RETAIN THESE INSTRUCTIONS FOR FUTURE REFERENCE



OTL Report No. 116-F-43-2

## REPLACEMENT PARTS - MODELS BCD36MH & BC36MH

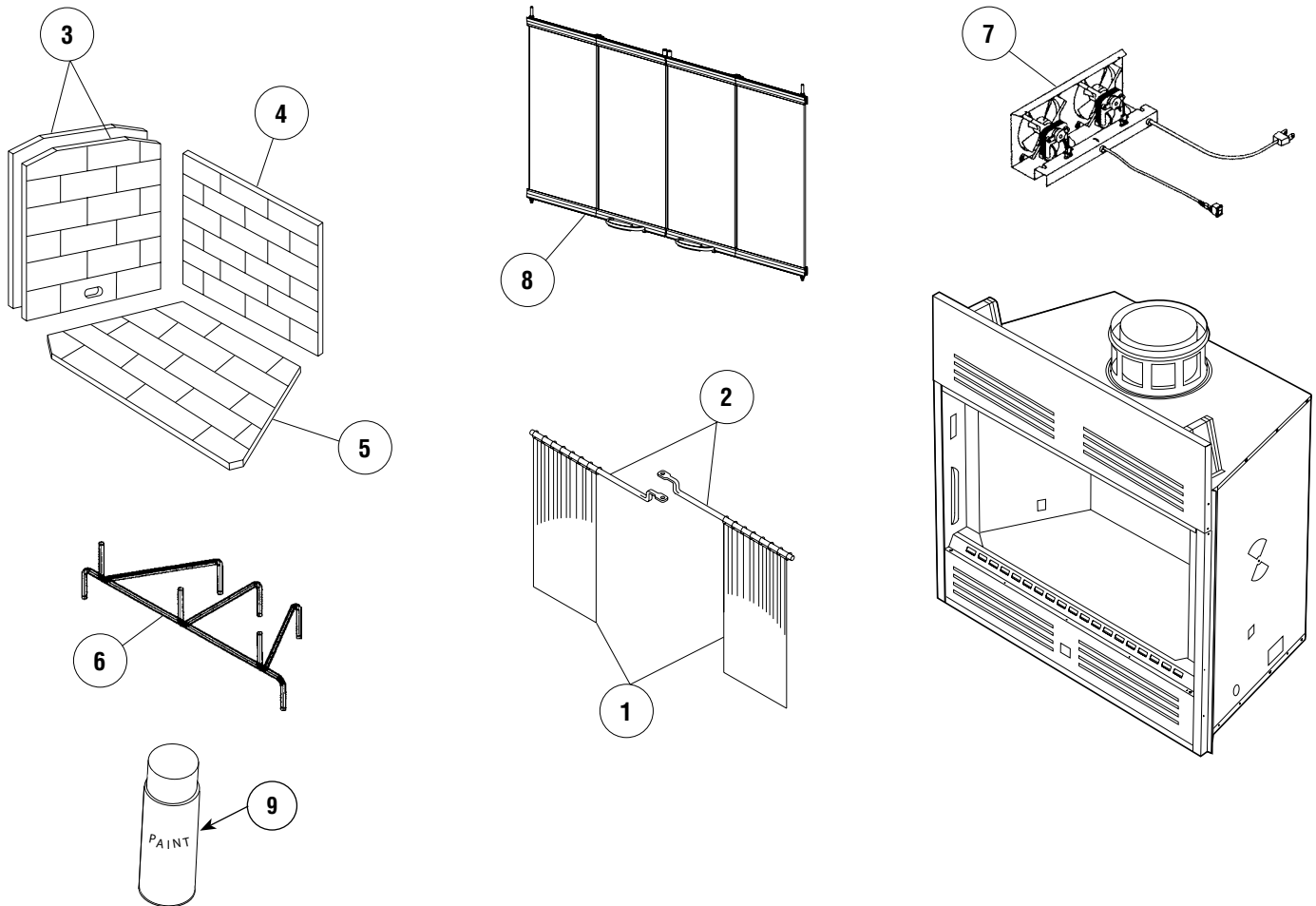

No	Description	Part No.	Qty.
	<b>Fireplace Assembly</b>	-	-
1.	<b>Firescreen</b>	36L98	2
2.	<b>Rod, Screen</b>	88L95	2
3.	<b>Refractory, Side</b>	LB-96795	2
4.	<b>Refractory, Rear</b>	LB-96796	1
5.	<b>Refractory, Bottom</b>	LB-96794	1
6.	<b>Grate</b>	87L20	1
7.	<b>Fan Kit (standard on BCD36MH only)</b>	36L32	1
8.	<b>Bi-Fold Door Set</b>	86L26	1
9.	<b>Paint, Touchup, Black, FTPK-B</b>	H4353	1

NOTE: DIAGRAMS & ILLUSTRATIONS NOT TO SCALE.

The manufacturer reserves the right to make changes at any time, without notice, in design, materials, specifications, and prices, and also to discontinue colors, styles, and products. Consult your local distributor for fireplace code information.