

ITEM	PART NUMBER	PART DESCRIPTION	QTY
1	WS420120	DRIVESHAFT, LOWER (PUCKSHAFT)	1
2	WS110111	BEARING, 6203-2RS	3
3	WS420110	SPACER	1
4	WS420130	WEIGHT, ECCENTRIC	1
5	WS174205	WASHER, DISC SPRING	1
6	WS148520	SET SCREW	1
7	WS420140	WEIGHT, ADJUSTABLE	1
8	WS420200	BUSHING, RUBBER 80 DURO	4
9	WS420040	COUPLING RUBBER	1
10	W095514	BEARING, BALL 3500	2
11	WS174432	WASHER, NYLON 1/4"	2
12	WS247009	CAP, 1/2" RUBBER	2
13	WS201112	DECAL, HALF THROTTLE	1
14	WS420201	SLEEVE, ISOLATOR	1
15	WS420075	CLIP, KICKSTAND	1
16	WS421972	POWERHEAD, UPPER	1
17	WS421982	BAR, ASSEMBLED	1
18	WS421960	CLAMP, HALF	4
19	WS138095	RET. RING, INTERNAL 1-1/8"	1
20	WS138096	RET. RING, INTERNAL 1.563"	1
21	WS138097	RET. RING, EXTERNAL 1/2"	1
22	WS138098	RET. RING, EXTERNAL 0.669"	1
23	WS226502	BOLT, 7/16 x 3.0 GR8	2
24	WS174993	WASHER, 7/16	4
25	WS227840	NUT, 7/16 - 14	2
26	WS227812	NUT, 1/4 NYLON LOCKING	1
27	WS225765	BOLT, 1/4 x 1-1/2 GR2	1
28	WS226000	BOLT, 5/16 x 1-1/2 GR8	2
29	WS227821	LOCKNUT, 5/16 NYLON	2
30	WS201110	DECAL, SCREED KING	1
31	WS162831	SCREW, 8-18 x 3/4	1
32	WS202251	ENGINE, GX35 HONDA	1
33	WS201234	DECAL, FUEL TANK	1
34	WS420190	BRACKET, KILL SWITCH	1
35	WS220152	LEVER, THROTTLE	1
36	WS220185	CABLE, THROTTLE - HONDA	1
37	WS421968	CAP, 4.5" ID - VENTED	1
38	WS421969	GRIP, HANDLE - 1" RUBBER	2
39	WS421989	LEVER, 7/16 FEMALE ADJUSTABLE	2
40	WS421986	W.A. PLATE, BOLSTER	2
41	WS226505	BOLT, 7/16 x 2.75 GR5	2
42	WS421992	ASSY, BOTTOM W/SLEEVE	1
43	WS420091	SHAFT, DRIVE - HONDA	1
44	WS226210	BOLT, HEX HD PL 3/8-24 UNF GR8	4
45	WS227814	NUT, HEX LOCK PL 3/8-24 UNF NYLON LOCKING	4
46	WS422002	W.A. BRACKET, SCREED MOUNT	2
47	WS201132	DECAL, SCREED KING	1
48	WS421998	BRACKET, CLEAT	1
49	WS421951	ENDCAP, LHS	1
50	WS421952	ENDCAP, RHS	1
51	WS201130	DECAL, MAGFLOW	1
52	WS421987	LEVER, 7/16 MALE ADJUSTABLE	2
53	WS176550	WASHER, 7/16 LOCK	2
54	WS201133	DECAL, CENTER OF MAGFLO	1
55	WS422007	RUBBER BACKING, SCREED BRKT	2
56	WS227845	NUT, 7/16 NYLON LOCKING	2
57	WS420191	PAN HEAD SCREW, M5-.8 x 10mm	1
58	WS420192	SPRING LOCK WASHER	1
59	WS421938	H35, TOP CASTING COMPLETE (ITEMS 10,16,19,21,43)	1
60	WS421937	H35, TOP CASTING SHAFT ASSY (ITEMS 10, 21, 43)	1
61	WS420026	ECCENTRIC SHAFT ASSY (ITEMS 1,2,3,22)	1
62	WS420193	FLAT WASHER, M5	1
63	WS421939	H35, BTM. CASTING COMPLETE (ITEMS 1,2,3,4,5,6,7,20,22,37,42,65)	1
64	WS621521	HANDLE BAR KIT (ITEMS 11,12,13,15,17,26,27,28,29,31,38)	1
65	WS225985	BUTTON HEAD SCREW, 5/16-18 x 1/2"	1
66	WS163070	SCREW, 7/16-14 UNC x 1.0XD RECOIL	2
67	WS201235	STICKER, STORE UPRIGHT	1
68	WS220186	LEADER SLEEVE	1
69	WS220153	PAN HEAD SCREW, 10-32 x 1-1/4"	1
*70	W000082	ACTIVATOR; ADHESIVE; QUICK-TAC 4	0.15 OZ
*71	W000083	ADHESIVE, TS 2400	0.1 OZ
*72	W000081	ADHESIVE/THREAD LOCKER	0.15 OZ

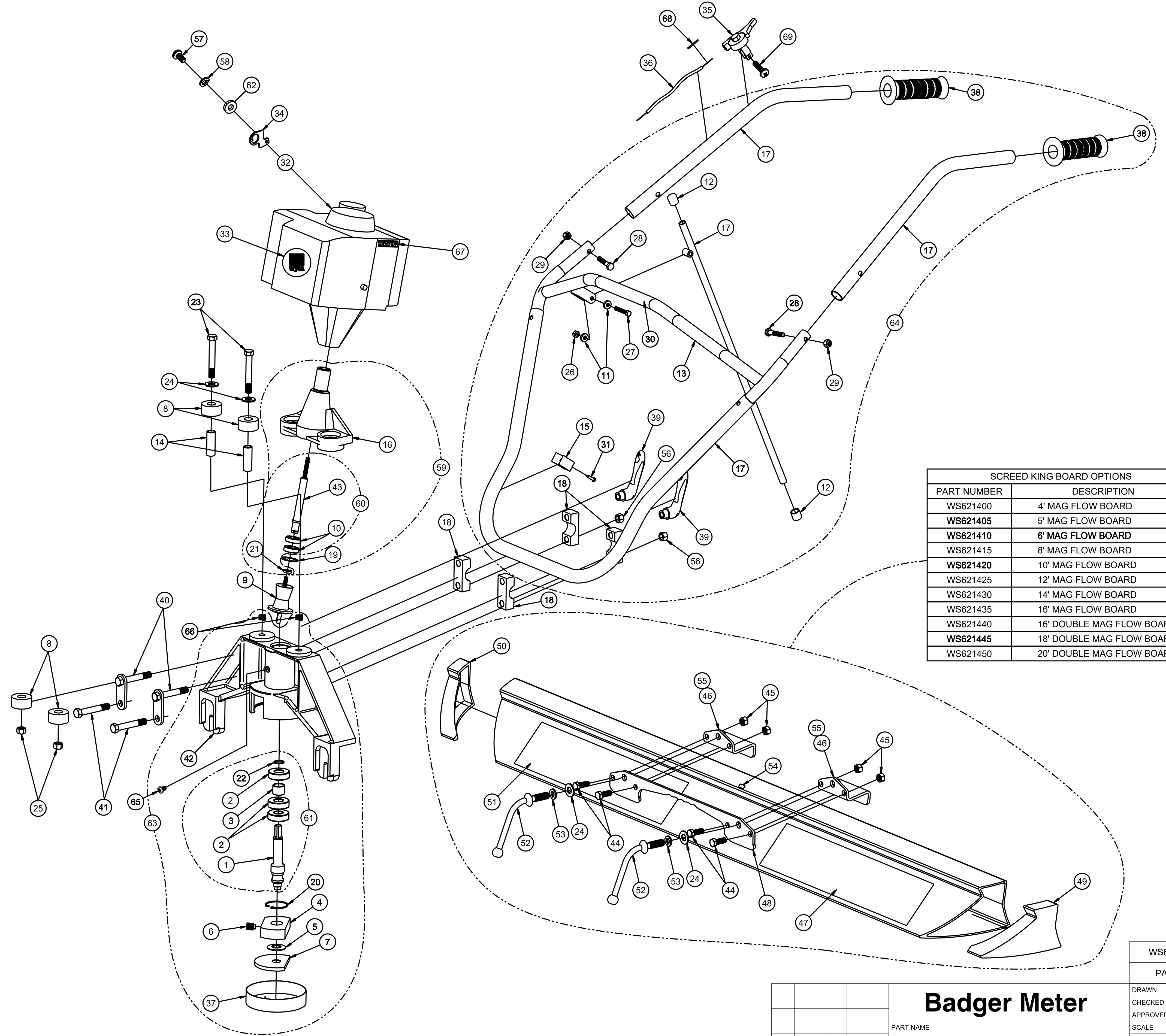

SCREED KING BOARD OPTIONS	
PART NUMBER	DESCRIPTION
WS621400	4' MAG FLOW BOARD
WS621405	5' MAG FLOW BOARD
WS621410	6' MAG FLOW BOARD
WS621415	8' MAG FLOW BOARD
WS621420	10' MAG FLOW BOARD
WS621425	12' MAG FLOW BOARD
WS621430	14' MAG FLOW BOARD
WS621435	16' MAG FLOW BOARD
WS621440	16' DOUBLE MAG FLOW BOARD
WS621445	18' DOUBLE MAG FLOW BOARD
WS621450	20' DOUBLE MAG FLOW BOARD

CONFIDENTIAL

UNLESS OTHERWISE SPECIFIED
ALL DIMENSIONS ARE IN INCHES (MM)
DRAWING AND TOLERANCES PER ANSI Y14.1-2004 & Y14.5-2009
THIS DRAWING TO BE USED WITH CAD MODEL, WHEN SUPPLIED BY
BADGER METER, FOR COMPLETE PRODUCT DEFINITION PER ANSI Y14.41-2003

TOLERANCE ON 4 PLACE DIMENSIONS ± .0025 [0.0635]
TOLERANCE ON 3 PLACE DIMENSIONS ± .005 [0.127]
TOLERANCE ON 2 PLACE DIMENSIONS ± .01 [0.25]
TOLERANCE ON ANGULAR DIMENSIONS ± 0.5°

REMOVE ALL BURRS R.005 MAX OR .005 x 45°
MACHINED SURFACES FINISH - 125 μINCHES OR BETTER

VENDOR NOTE
IMPORTED ITEMS REQUIRE COUNTRY OF ORIGIN MARKING IN COMPLIANCE WITH 19 U.S.C. 1304

WS621505		2
PART #	REV	
DRAWN S. BENOIT		
CHECKED		
APPROVED		
SCALE NONE		
SHEET 1 OF 1		
SHEET SIZE D		
DRAWING #		ISSUE
WS621505		G

Badger Meter			
PART NAME			
SCREED KING; ASSEMBLY			
MATERIAL		CAGE #	
SEE PARTS LIST			
PRODUCT LINE	EST WEIGHT	VOLUME	
WYCO			
ISSUE	CHANGE	BY	DATE
G	25891	SB	10/22/19
F	24137	SB	5/6/19