



**HEARTH PRODUCTS**

# INSTALLATION AND OPERATING INSTRUCTIONS

## MERIT® PLUS SERIES

27" Electric Fireplace  
P/N 850,035M REV. D 06/2008

### MODELS

*MPE-27*



This manual will enable you to obtain a safe, efficient and dependable installation of your electric fireplace. Please read and understand these instructions before beginning your installation.

Do not alter or modify the fireplace or its components under any circumstances. Any modification or alteration of the fireplace system, including but not limited to the fireplace and accessories, may void the warranty, listings and approvals of this system and could result in an unsafe and potentially dangerous installation.

### FOR YOUR SAFETY

**DO NOT STORE OR USE GASOLINE OR OTHER FLAMMABLE VAPORS AND LIQUIDS IN THE VICINITY OF THIS OR ANY OTHER APPLIANCE**

**LENNOX™ ELECTRIC FIREPLACES ARE DESIGNED FOR USE AS A DECORATIVE APPLIANCE AND/OR AS A SUPPLEMENTAL HEATER. THEY ARE NOT INTENDED FOR CONTINUOUS USE AS A PRIMARY HEAT SOURCE.**

**INSTALLER: Leave this manual with the appliance.  
CONSUMER: Retain this manual for future reference.**

A French manual is available upon request. Order Form Number 850,035CF.

Ce manuel d'installation est disponible en français, simplement en faire la demande. Numéro de la pièce 850,035CF.



CSA Report No. 46-M198

## REPLACEMENT PARTS

Item No.	DESCRIPTION	MPE-27	
		Catalog No.	Qty.
1.	Bulb Kit, (10 Each, 35W halogen)	H1623	1
2.	Circuit Board and Remote Control Sensor	H3863	1
3.	Glass Mirror	H3864	1
4a.	Blower, Heating Element, and Access Panel Assembly	H3865	1
4b.	Fuse Plate Assembly (5 each)	H5043	1
5.	Flame Cylinder Assembly	H3866	1
6.	Flame Motor	H3867	1
7.	Log Assembly and Ember Bed	H3868	1
8.	Switch, Toggle (1 Each)	H3869	1
9.	Wire Harness	H3870	1
10.	Remote Control	H3871	1
11.	Panel, Flame Cover	H3872	1
12.	Panel Glass	H3873	1

## REPLACEMENT PARTS COMPONENT DIAGRAM

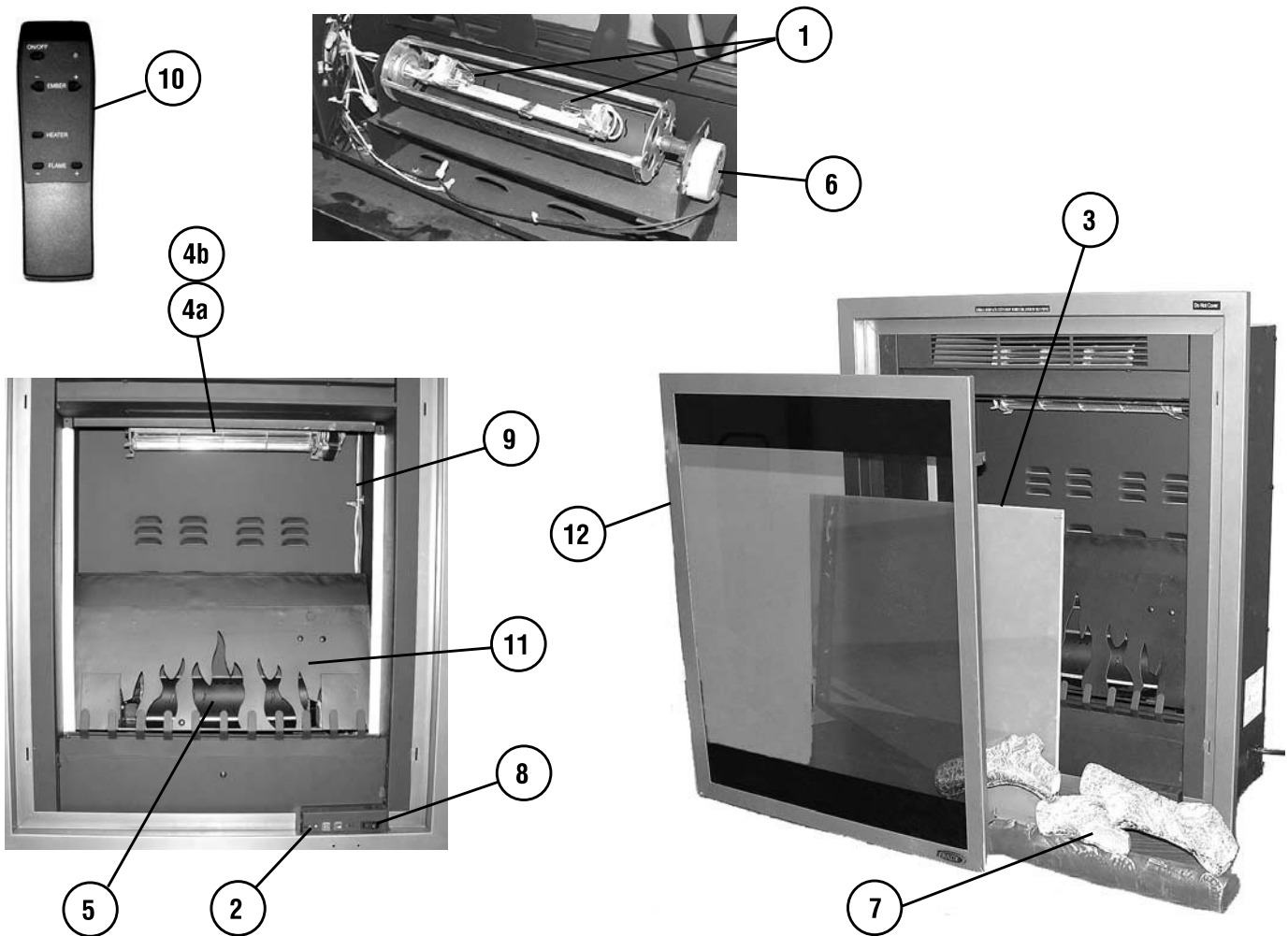

NOTE: DIAGRAMS & ILLUSTRATIONS NOT TO SCALE.