

# ROLAIR

SCHEMATIC FOR MODELS

7722HK28/20

8230HK30

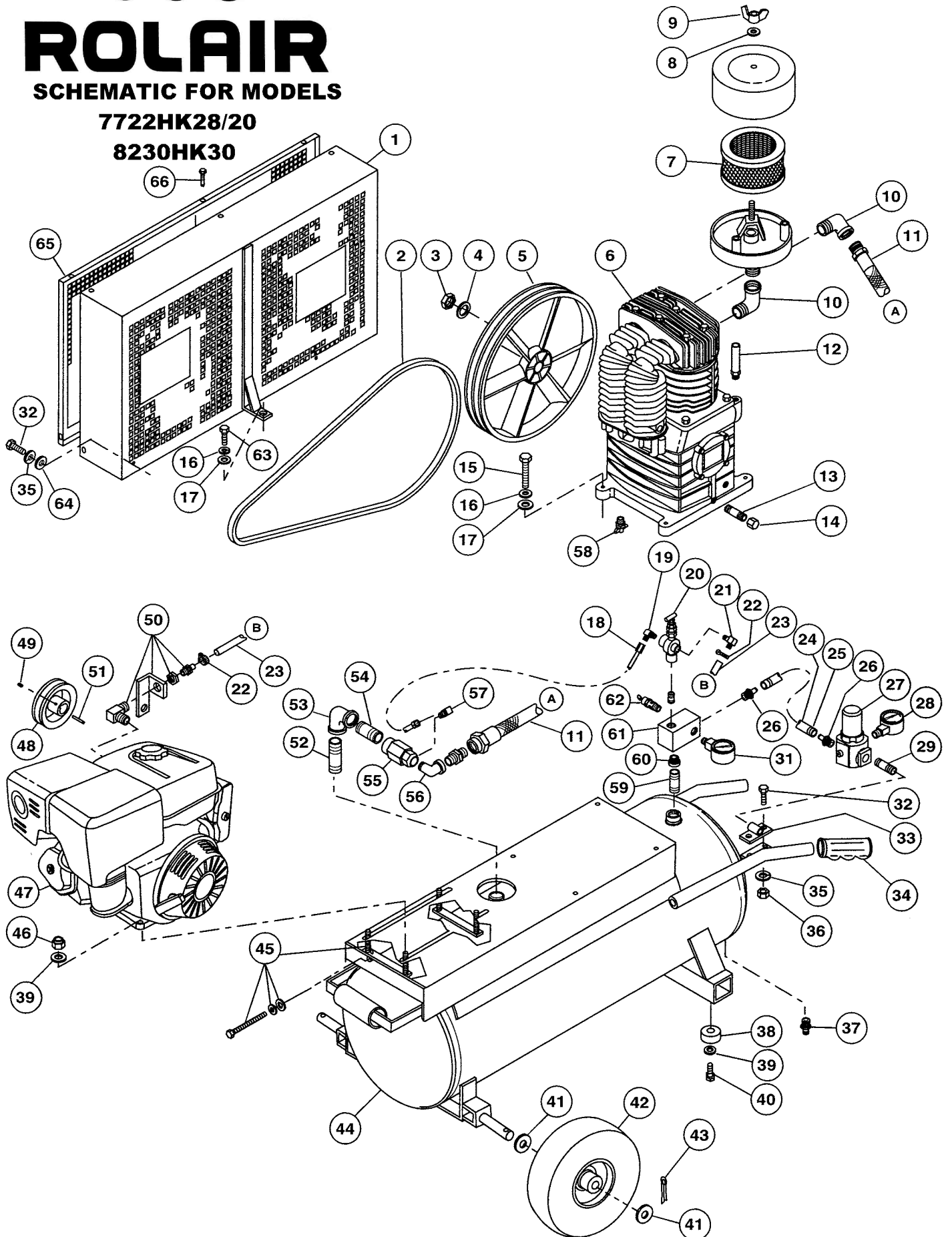

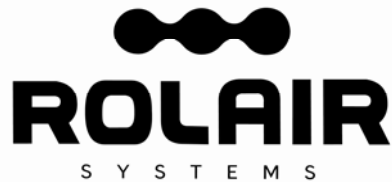

**PARTS LIST FOR MODELS  
7722HK28/20  
8230HK30**

Schem. #	Description	Part #	Qty.	Schem. #	Description	Part #	Qty.
1	Belt Guard Assembly	BG8422K30ASSY	1	35	Lock Washer	MIS10099	4
2	Belt	BTA63	2	36	Nut	MIS10020	2
3	Nut	37403780CH	1	37	Drain Valve	132BV	1
4	Washer	37502450CH	1	38	Rubber Foot	219	4
5	Flywheel	31003040CH	1	39	Washer	MIS10102	8
6	II Stage Pump w/ Flywheel-MDL 7722HK28/20	PMP22K28CH	1	40	Screw	MIS10008	4
	II Stage Pump less Flywheel- MDL 7722HK28/20	PMP22K28CHLF	1	41	Washer	MIS10104	6
	II Stage Pump w/ Flywheel- MDL 8230HK30	PMP22K30CH	1	42	Fully-Pneumatic Tire w/Sealant	WLS30SEAL	2
	II Stage Pump w/ Flywheel- MDL 8230HK30	PMP22K30CHLF	1	43	Cotter Pin	181B	2
7	Filter Element	431	1	44	20 Gallon Tank Assembly- ASME	TNKASY8230A	1
8	Washer	FSWASHER	1	45	Belt Tightener / Mounting Kit	SBT8HPH0&KAK30- ANGLE*	1
9	Wing Nut	FSNUT	1	46	Lock Nut	MIS10020B	4
10	Elbow	BLEL0750X90S	2	47	Honda Engine	ENG08H01	1
11	Braided Discharge Tube	145C	1		Std Oil Drain Extension Elbow	BREL0250X90	1
12	3/8" Breather/Oil Fill Plug	36507050CH	1		Nipple	BLNP0250X5000	1
13	Nipple	BLNP0250X1500	1		Cap	BLCA0250	1
14	Cap	BLCA0250	1		Optional Flexible Oil Drain Assy	HDE8	1
15	Bolt-MDL 7722HK28/20	MIS10043	1	48	Engine Pulley-MDL 7722HK28/20	PU2AK54X1000	1
	(7722HK28/20 pump mount bolts not shown)	MIS10027	3		Engine Pulley-MDL 8230HK30	PU2AK46X1000	1
	Bolt-MDL 8230HK30	MIS10043	4				
16	Lock Washer	MIS10100	8	49	Setscrew	MIS10020C	1
17	Washer	MIS10103	8	50	Throttle Control Assembly	192EGX240QA	1
18	1/4" Nylon Tubing - 30"	178D	2.5'	51	1/4" Keystock	MIS10096C	1
	Brass Nut	BRNT0250	2	52	Nipple-MDL 7722HK28/20	BLNP0500X2000	1
	Brass Ring	BRRG0250	2		Nipple-MDL 8230HK30	BLNP0500X4000	1
	Brass Sleeve	BRSLO250	2	53	Elbow	BLEL0500X90	1
19	Brass Elbow	BREL0250X025039	1	54	Nipple	BLNP0500X2000	1
20	Pilot Unloader Valve	131BIG	1	55	Check Valve	CV4X4L1	1
21	Brass Elbow	BREL0250X0125H16	1	56	Elbow	BREL0500X90S	1
22	Hose Clamp	177B	2	57	Brass Elbow	BREL0250X012539	1
23	1/4" Rubber Hose - 30"	178	2.5'	58	Drain Valve	132	1
24	3/8" Rubber Hose - 12"	178A	1'	59	Nipple	BLNP0375X2500	1
25	Hose Clamp	177A	2	60	Bushing	BLBS0500X0375	1
26	Brass Coupler	BRCPO375X0375H12	2	61	Aluminum Block Manifold	154	1
27	Regulator	REG0375	1				
28	Gauge	GA0250200GC	1	62	Safety Relief Valve	SRV0250A175	1
29	Nipple	BLNP0375X1500	1	63	Bolt	MIS10041	1
31	Gauge	GA0250300GC	1	64	Washer	MIS10108	2
32	Bolt	MIS10022	4	65	Belt Guard Cover	BG8423	1
33	Accessory Bracket	210	1	66	Bolt	MIS10094	5
34	Handle Grip	328	2				

For units built prior to February 2005, order SBT8HPH0 & KAK30-SQUARE.



# ROLAIR

## SCHEMATIC FOR PMP22K28

**PRODUCTION STARTING 2/00**

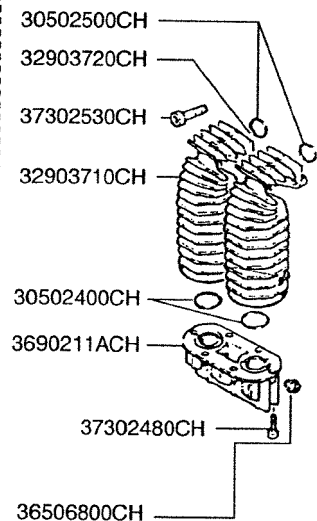

31004620CH  
37500730CH  
37400720CH

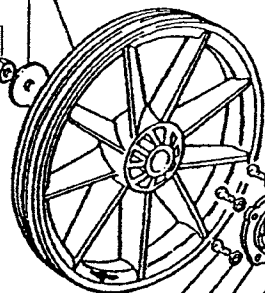

37301140CH  
37508130CH  
30400860CH  
30500050CH  
30300040CH  
30300030CH

37308060CH  
37502320CH  
31302700CH  
30502330CH  
37302530CH  
32902710CH  
32902720CH  
30502340CH  
36902110CH  
37302480CH  
31204700CH  
31204710CH  
31204720CH  
31206180CH  
31204670CH  
31102250CH  
37300250CH  
37500310CH  
37400220CH  
30204610CH  
33104600CH

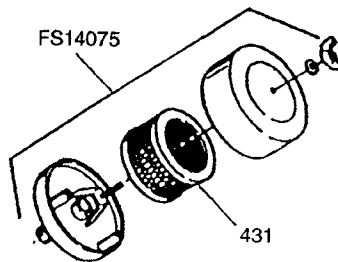

30502330CH

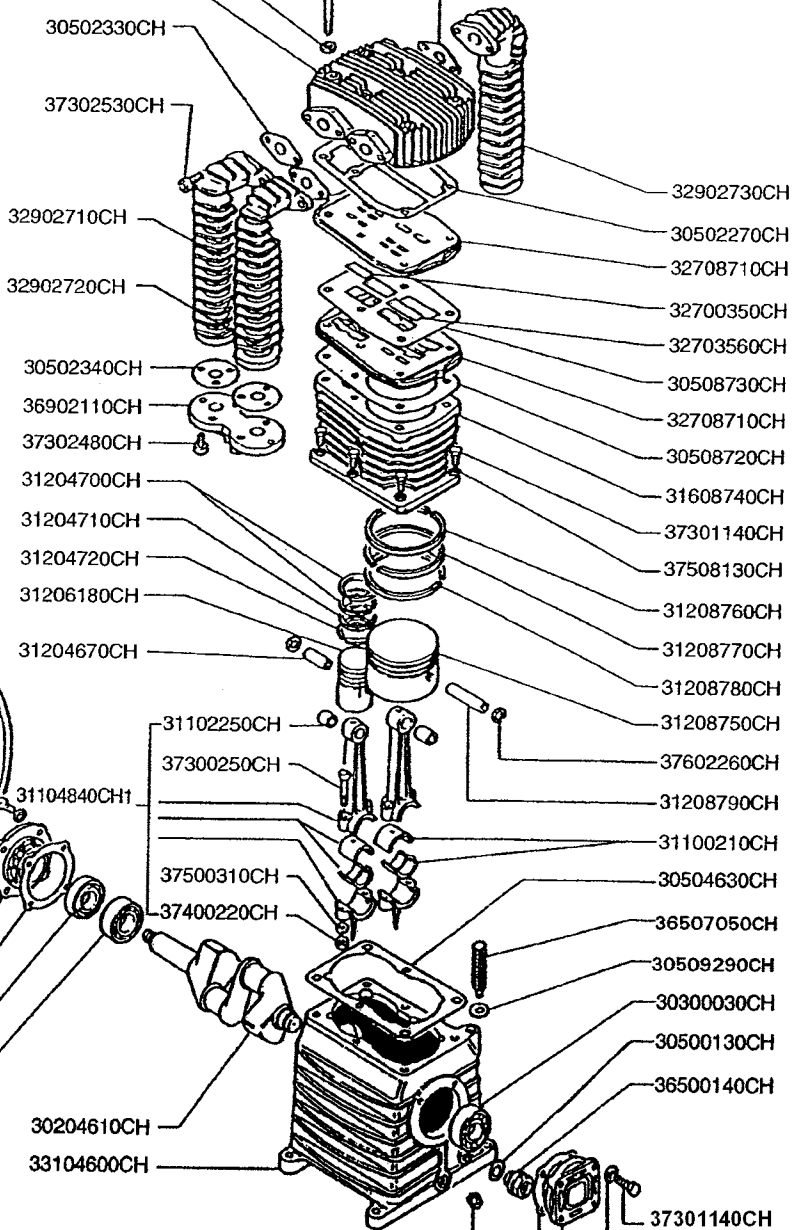

BLSQPL0250

37301140CH  
37508130CH  
30400830CH  
30500150CH

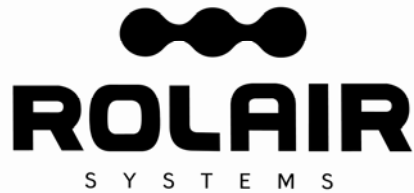

## PARTS LIST FOR PMP22K28

Description	Part #	Qty.	Description	Part #	Qty.
Crankshaft	30204610CH	1	Valve Plate	32708710CH	2
Bearing	30300030CH	2	Left Intercooler	32902710CH	1
Oil Seal	30300040CH	1	Right Intercooler	32902720CH	1
Bearing Carrier	30400830CH	1	Aftercooler	32902730CH	1
Bearing Carrier	30400860CH	1	Crankcase	33104600CH	1
Gasket	30500050CH	1	Sight Gauge	36500140CH	1
Gasket	30500130CH	1	3/8" Breather/Oil Fill Plug	36507050CH	1
Gasket	30500150CH	1	Connector	3690211ACH	1
O-Ring	30509290CH	1	Bolt	37300250CH	4
Gasket	30502270CH	1	Bolt	37301140CH	14
Gasket	30502330CH	3	Bolt	37302480CH	6
Gasket	30502340CH	2	Bolt	37302530CH	6
Gasket	30504630CH	1	Bolt	37308060CH	6
Gasket	30508720CH	1	Nut	37400220CH	4
Gasket	30508730CH	1	Nut	37400720CH	1
Flywheel	31004620CH	1	Washer	37500310CH	4
Bearing Shell	31100210CH	2	Washer	37500730CH	1
Bushing*	31102250CH	2	Washer	37508130CH	14
Connecting Rod Assembly	31104840CH1	2	Snap Ring	37602260CH	4
Piston Pin - HP	31204670CH	1	Plug	BLSQPL0250	1
Ring - HP	31204700CH	2	Silencer/Filter Assembly	FS14075	1
Ring - HP	31204710CH	1	Filter Element	431	1
Ring - HP	31204720CH	1	Ring Set	K28RINGS	1
Piston - HP	31206180CH	1	Gasket Set	K28GASKETS	1
Piston - LP	31208750CH	1	Valve Plate Assembly	2800VK28	1
Ring - LP	31208760CH	1	<b>INTERCOOLER/AFTERCOOLER PARTS STARTING 12/99</b>		
Ring - LP	31208770CH	1	O-Ring - Connector	30502400CH	2
Ring - LP	31208780CH	1	Plug	36506800CH	1
Piston Pin - LP	31208790CH	1	Connector	3690211ACH	1
Head	31302700CH	1	Bolt	37302480CH	6
Cylinder	31608740CH	1	Bolt	37302530CH	6
Valve - HP	32700350CH	2	O-Ring - Head	30502500CH	2
Valve - LP	32703560CH	4			

\*Bushing is not machined to fit piston pin if ordered separate from connecting rod.