

# BALL TRANSFER UNITS

PAGE

## "SPM" SERIES – HEAVY DUTY TYPE WITH FLANGE

9-10



Hardened machined steel housing with flange, turned steel cover, felt seal\*, drain hole on the bottom. Available in steel, zinc plated steel, stainless steel. Balls in chrome steel, stainless steel AISI 420, plastic material.

\* Except SPM 12, 15 and versions with plastic ball.

## "SPM" SERIES – HEAVY DUTY TYPE WITH FLANGE – SEEGER GROOVE ACCORDING TO DIN 471

11



Hardened machined steel housing with flange, groove for fixing ring, turned steel cover, felt seal\*, drain hole on the bottom. Available in steel, zinc plated steel, stainless steel. Balls in chrome steel, stainless steel AISI 420, plastic material.

\* Except SPM 15 and versions with plastic ball.

## "SBM" SERIES – HEAVY DUTY TYPE WITHOUT FLANGE

12



Hardened machined steel housing without flange, turned steel cover, felt seal\*. Available in steel, zinc plated steel, stainless steel. Balls in chrome steel, stainless steel AISI420 C, plastic material.

\* Except SBM 8, 12, 15 and versions with plastic ball.

## "SPM CARGO" SERIES - FOR AIRPORT USE, DEPOSITS, FREIGHT FORWARDERS FOOTBOARDS

13



Hardened machined steel housing with flange, turned steel cover, without felt seal to ensure better smoothness and less friction. Stainless steel plate with several holes on the bottom to facilitate the escape of liquids, condensation and impurities. Available in zinc plated steel with sealing coating to increase corrosion resistance, and in stainless steel. Balls in stainless steel AISI 420.

# "SPM" SERIES – HEAVY DUTY TYPE WITH FLANGE

SPM

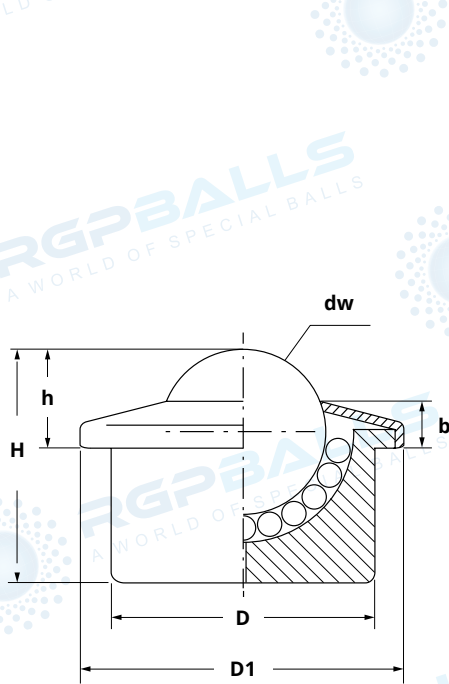

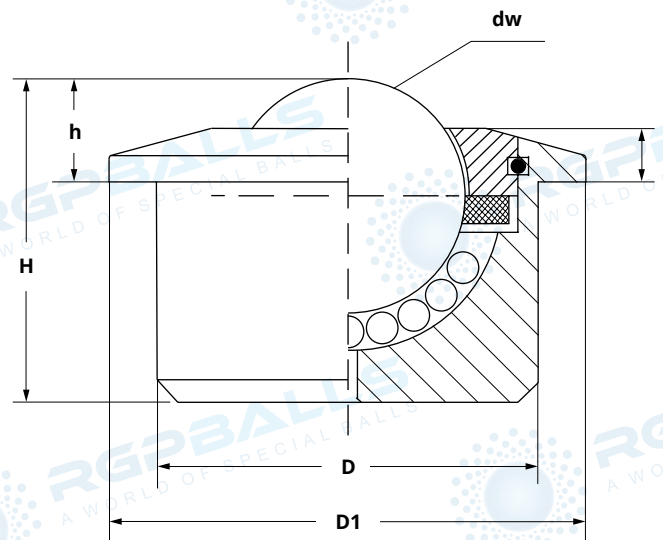

SPM 12



SPM 15/22/30/45

- Hardened housing with flange machined from bar, in order to guarantee high flow rates and a greater resistance to stress.
- reinforced cover in turned steel.
- felt seal (except for SPM 12 and 15).
- drain hole on the bottom.

ITEM	TYPE	VERSION	DIMENSIONS						LOAD (Kg)		WEIGHT (Kg)
			dw	D	D1	h	H	b			
SPM01200A	SPM 12 A	steel housing, balls made of chrome steel	12	22 ± 0,08	27	8 ± 0,2	16,75	5	20	15	0,035
SPM01500A	SPM 15 A		15	24 ± 0,08	31	9,5 ± 0,2	21	5,5	50	35	0,060
SPM02200A	SPM 22 A		22	36 ± 0,08	45	9,8 ± 0,2	30,5	4,5	180	125	0,185
SPM03000A	SPM 30 A		30	45 ± 0,08	55	13,8 ± 0,3	36,8	8	350	250	0,355
SPM04500A	SPM 45 A		45	62 ± 0,1	75	19 ± 0,4	53,5	10	600	420	0,990
SPM01200B	SPM 12 B	zinc plated steel housing, balls made of chrome steel	12	22 ± 0,08	27	8 ± 0,2	16,75	5	20	15	0,035
SPM01500B	SPM 15 B		15	24 ± 0,08	31	9,5 ± 0,2	21	5,5	50	35	0,060
SPM02200B	SPM 22 B		22	36 ± 0,08	45	9,8 ± 0,2	30,5	4,5	180	125	0,185
SPM03000B	SPM 30 B		30	45 ± 0,08	55	13,8 ± 0,3	36,8	8	350	250	0,355
SPM04500B	SPM 45 B		45	62 ± 0,1	75	19 ± 0,4	53,5	10	600	420	0,990
SPM01200C	SPM 12 C	zinc plated steel housing, balls made of stainless steel AISI 420	12	22 ± 0,08	27	8 ± 0,2	16,75	5	15	10	0,035
SPM01500C	SPM 15 C		15	24 ± 0,08	31	9,5 ± 0,2	21	5,5	40	25	0,060
SPM02200C	SPM 22 C		22	36 ± 0,08	45	9,8 ± 0,2	30,5	4,5	130	90	0,185
SPM03000C	SPM 30 C		30	45 ± 0,08	55	13,8 ± 0,3	36,8	8	240	170	0,355
SPM04500C	SPM 45 C		45	62 ± 0,1	75	19 ± 0,4	53,5	10	400	280	0,990
SPM01200SS	SPM 12 SS	housing, internal parts and balls made of stainless steel AISI 420	12	22 ± 0,08	27	8 ± 0,2	16,75	5	15	10	0,035
SPM01500SS	SPM 15 SS		15	24 ± 0,08	31	9,5 ± 0,2	21	5,5	40	25	0,060
SPM02200SS	SPM 22 SS		22	36 ± 0,08	45	9,8 ± 0,2	30,5	4,5	130	90	0,185
SPM03000SS	SPM 30 SS		30	45 ± 0,08	55	13,8 ± 0,3	36,8	8	240	170	0,355
SPM04500SS	SPM 45 SS		45	62 ± 0,1	75	19 ± 0,4	53,5	10	400	280	0,990