

BALL TRANSFER UNITS

PAGE

"SPS" SERIES - LIGHT DUTY TYPE

18-19



Zinc plated pressed metal sheet metal housing and cover*, inner shell in hardened pressed steel*, felt seal**. Balls in chrome steel, AISI420 stainless steel, plastic material.

* Available completely in stainless steel version.

** Except SPS 15 and versions with plastic ball.

"SPP" SERIES - ALL PLASTIC MATERIAL

20-21



Housing and cover in POM (acetal resin) turned from solid, no felt seal to ensure better smoothness, drain hole on the bottom. Plastic or AISI316 stainless steel balls.



All products shown in this catalogue are MADE IN ITALY

“SPS” SERIES – LIGHT DUTY TYPE WITH MAIN PLASTIC BALL

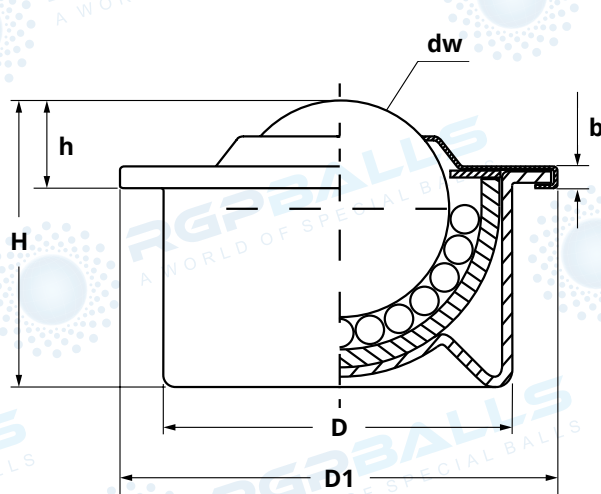

SPS 15

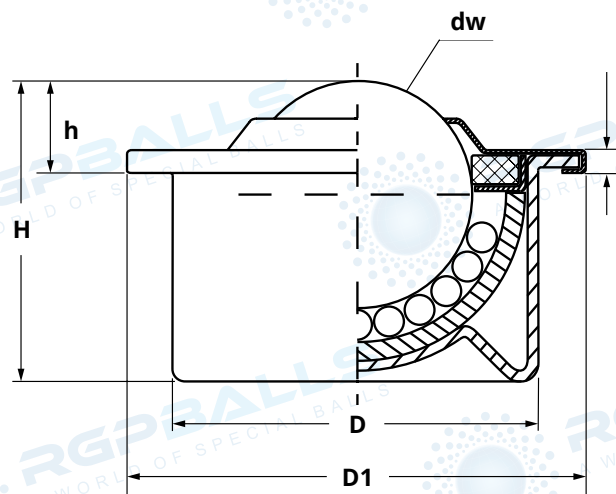

SPS 22/30/45

- Dimensionally interchangeable with the SPM version, they guarantee good smoothness and greater lightness at low costs.
- Housing and cover in pressed metal sheet.
- Inner shell in hardened pressed steel.
- Versions with main plastic ball:
 - Best choice for handling particularly delicate surfaces such as sheets of glass or crystal, wooden panels, painted or satin sheet plates, and so on*
 - No felt seal to ensure better smoothness even with low loads*
 - Usually not to be used turned upside down*
 - Working temperature 0°/60°*

| ITEM | TYPE | VERSION | DIMENSIONS | | | | | | LOAD (Kg) | | WEIGHT (Kg) |
|--------------|-----------|--|------------|-----------|----|------------|------|-----|-----------|---|-------------|
| | | | dw | D | D1 | h | H | b | | | |
| SPS01500BD | SPS 15 BD | Zinc plated steel housing, inner shell in hardened steel, main plastic ball*, small balls in chrome steel | 15 | 24 ± 0,08 | 31 | 9,5 ± 0,2 | 21 | 3 | 13 | - | 0,026 |
| SPS02200BD | SPS 22 BD | | 22 | 36 ± 0,08 | 45 | 9,8 ± 0,2 | 29,5 | 3,5 | 20 | - | 0,084 |
| SPS03000BD | SPS 30 BD | | 30 | 45 ± 0,1 | 55 | 13,8 ± 0,3 | 37,8 | 4 | 25 | - | 0,155 |
| SPS04500BD | SPS 45 BD | | 45 | 62 ± 0,15 | 75 | 19 ± 0,4 | 53,5 | 6 | 25 | - | 0,335 |
| SPS01500CD | SPS 15 CD | Zinc plated steel housing, inner shell in hardened steel, main plastic ball*, small balls in stainless steel AISI 420 | 15 | 24 ± 0,08 | 31 | 9,5 ± 0,2 | 21 | 3 | 13 | - | 0,026 |
| SPS02200CD | SPS 22 CD | | 22 | 36 ± 0,08 | 45 | 9,8 ± 0,2 | 29,5 | 3,5 | 20 | - | 0,084 |
| SPS03000CD | SPS 30 CD | | 30 | 45 ± 0,1 | 55 | 13,8 ± 0,3 | 37,8 | 4 | 25 | - | 0,155 |
| SPS01500SSCD | SPS15SSCD | Housing in stainless steel pressed sheet, inner shell in hardened stainless steel, main plastic ball*, small balls in stainless steel AISI 420 | 15 | 24 ± 0,08 | 31 | 9,5 ± 0,2 | 21 | 3 | 13 | - | 0,026 |
| SPS0220SSCD | SPS22SSCD | | 22 | 36 ± 0,08 | 45 | 9,8 ± 0,2 | 29,5 | 3,5 | 20 | - | 0,084 |
| SPS03000SSCD | SPS30SSCD | | 30 | 45 ± 0,1 | 55 | 13,8 ± 0,3 | 37,8 | 4 | 25 | - | 0,155 |