

SETTLEMENT AGREEMENT

THIS SETTLEMENT AGREEMENT (hereinafter, the “Agreement”) is hereby made and entered into by and between **HALL COUNTY, GEORGIA** (“Hall County”) and **HABERSHAM PARTNERS, LLC** (hereinafter referred to collectively as “Owner”) for the purpose of resolving all issues related to Hall County’s acquisition of certain property in lieu of condemnation.

WITNESSETH

WHEREAS, on January 2, 2020, the location and design of the Sardis Road Connector Project (Federal Aid Project STP00-0003-00(626)) were approved by the Georgia Department of Transportation and consists of the widening, realignment, and reconstruction of existing roadways and the construction of new roadways to provide a connector roadway between Georgia State Route 53 to the South and Georgia State Route 60 to the North; and

WHEREAS, the Hall County Board of Commissioners (the “Board of Commissioners”) has determined that the Project is a public road purpose permitted by law; and

WHEREAS, the Board of Commissioners has further determined that in order to construct the Project it must acquire, by deed or by condemnation proceedings, certain rights of way and easements; and

WHEREAS, a portion of the properties necessary to be acquired is owned by the Owner; and

WHEREAS, descriptions of the entirety of the property owned by the Owner is reflected on the plans, attached hereto as **Attachment 1** and by reference made a part hereof (said property being hereinafter sometimes referred to as “Parcel 143” or “Subject Property”); and

WHEREAS, the property shown on **Attachment 1** is designated as tax map number 10104

000017C (Parcel 143) by the taxing authorities of Hall County; and

WHEREAS, Hall County has determined that the portions of Parcel 143 are necessary to be acquired in connection with the construction of the Project are as follows:

- (1) A right of way, on Parcel 143, for the purpose of acquiring, constructing, and maintaining a right of way along the portion of the Project, said right of way consisting of .143 acre, more or less. A metes and bounds description of said right of way is attached hereto as **Attachment 2**, and by reference made a part hereof;
- (2) A permanent easement, on Parcel 143, for the purpose of constructing and maintaining slopes and relocating utilities, consisting of 0.054 acre, more or less. A metes and bounds description of said easement is attached hereto as **Attachment 3**, and by reference made a part hereof; and
- (3) A permanent easement, on Parcel 143, for the purpose of constructing and maintaining slopes and relocating utilities, consisting of 0.008 acre, more or less. A metes and bounds description of said easement is attached hereto as **Attachment 4**, and by reference made a part hereof; and

WHEREAS, the parties have reached an Agreement with regard to the amount of just and adequate compensation to be received for all property rights to be acquired, as described above, and, in exchange for the receipt of such funds and certain right of way plan revisions, the Owner has agreed to forever release, settle, dismiss and waive their claims related to or arising out of any Condemnation action; and

WHEREAS, before a condemnation action was filed, Hall County and the Owner agreed during negotiations that the total sum of \$890,000.00, for the right of way and permanent easements, along with fixtures, business loss, income, and any site improvements that would be directly impacted by the Project, is just and adequate compensation for the acquired interests and improvements thereon; and

WHEREAS, the parties now desire to settle all claims and avoid any litigation related to Hall County's acquisition of the rights of way and easements required;

NOW, THEREFORE, for and in consideration of the covenants and Agreements herein contained and other good and valuable consideration, the receipt, adequacy and sufficiency of which are hereby expressly acknowledged by the parties hereto, Hall County and Owner, intending to be legally bound hereby, do covenant and agree as follows:

1.

Hall County shall pay the Owner \$890,000.00, said sum being agreed by all parties to be just and adequate compensation for the acquired interests, described above, as well as any consequential, impact, or other damages resulting from Hall County's acquisition of said interests.

2.

The Owner has represented and Hall County has confirmed that these entities do not have an interest in the settlement set forth herein. Specifically, Jay's Food Mart/Chevron Convenience Store and Petrofast Food Stores, Inc. (improperly identified as Olympic Petroleum) have executed waivers of interest in property and the Air Vac machine was previously removed from the property by its owner.

3.

Pursuant to the terms of this Agreement following approval by the Hall County Board of Commissioners, the parties will close on the purchase and sale of the acquired interests at the offices of Stewart, Melvin & Frost, LLP, at a time to be mutually agreed upon by the parties, but in no event later than September 29, 2023.

4.

The parties have read all the terms hereof and understand and voluntarily accept and agree to all the terms hereof, and that they have been adequately represented and advised by their own legal counsel. Further, the parties enter into this Agreement voluntarily and have not assigned to any

other person or party all or any portion of their claims which are the subject of this Agreement, and the parties confirm that no other person or party is subrogated to any of their rights in this matter. Except as otherwise provided for herein, neither this Agreement nor any right, remedy, obligation or liability arising hereunder or by reason hereof, shall be assignable by any party, without prior written consent of the other party. The terms and conditions of this Agreement shall be binding upon and inure to the benefit of the Owner and its heirs, successors, assigns, and transferees.

5.

This Agreement was negotiated and is being delivered, executed, and intended to be performed in the State of Georgia, and its terms and conditions shall be construed and enforced in accordance with the laws of this state. The Superior Court of Hall County, Georgia shall have jurisdiction to resolve any disputes, breaches, or other issues that may arise in association with this Agreement.

6.

The parties shall execute, deliver, acknowledge or supply such further documents, instruments and assurances as shall be reasonably necessary or appropriate to carry out the full intent and purposes of this Agreement.

7.

The Agreement shall be constructed as if the Parties jointly prepared the same and any uncertainty or ambiguity shall not be construed or interpreted against the drafter.

8.

No representations as to tax consequences, if any, have been made in the provisions of this Agreement.

IN WITNESS WHEREOF, the parties have hereunto affixed their hands and seals on the date set forth hereinabove.

Sworn to and subscribed before me this

Sam Bangee, Partner
HABERSHAM PARTNERS, LLC

_____ day of _____, 2023.

Notary Public

**HALL COUNTY BOARD OF
COMMISSIONERS**

Richard Higgins, Chairman

ATTEST:
Jennifer Rivera, County Clerk

Approved as to form:

Hall County Attorney
William J. Linkous, III

Attachment 1

(Legal Description of the Entirety of Owner's Property)

STATE OF GEORGIA PROJECT #:STP00-0003-00(626)

COUNTY OF HALL P.I. #: 0003626

PARCEL 143 OWNER: Habersham Partners LLC
3585 Thompson Bridge Rd

TAX ID # 10104 000017C

All that tract or parcel of land lying and being in Land Lot 104, 10th Land District, Hall County, Georgia as shown on a plat prepared by Patton Land Surveying, LLC, for Habersham Partners, LLC, First American Title Insurance Company & Calloway Title & Escrow, LLC, dated March 7th, 2022 and being more particularly described as follows:

Commencing at a calculated point located at the centerline baseline intersection of State Route 60 (Thompson Bridge Road) (varying width right-of-way) & State Route 283 (Mt. Vernon Road) per the Georgia Department of Transportation right-of-way map, project number FR-198-1 (11), Sheet 23 of 32, last revised January 16th, 1991 and located at Georgia State Plane Coordinate Northing 1590181.84, Easting 2386120.53, Georgia West Zone, North American Datum of 1983/2007 adjustment, THENCE South 04 degrees 37 minutes 28 seconds East for a distance of 95.86 feet to a 1/2" rebar pin found at the intersection of the Westerly right-of-way line of said State Route 60 with the Southerly line of that certain Tract of land as described in Deed Book 627, Page 42, Hall County, Georgia deed records and said point being the TRUE POINT OF BEGINNING.

Thence leaving said State Route 60 and following said Southerly parcel line the following course:

Thence South 85 degrees 16 minutes 41 seconds West for a distance of 161.16 feet to a 1/2" rebar pin set at the intersection of said Southerly parcel line with the Southerly line of Tract 2, as described in Deed Book 7278, Pages 96 & 97, Hall County, Georgia deed records, said line also being the Southerly line as shown on Plat Book 45, Page 246, Hall County, Georgia plat records;

Thence leaving said Southerly line of said Deed Book 627, Page 42 and following the Southerly line of said Tract 2 and the Southerly line of said Plat Book 45, Page 246 the following course:

Thence South 78 degrees 38 minutes 07 seconds West for a distance of 348.01 feet to a 1/2" rebar pin found at the Southwest corner of Tract 3, as described in Deed Book 7278, Pages 96 & 97 and the Southwest corner of Tract 1, as shown on Plat Book 120, Page 194;

Thence following the Southerly line of said Tract 1 the following course:

Thence North 52 degrees 55 minutes 09 seconds East for a distance of 461.94 feet to a 1/2" rebar pin set on the Westerly right-of-way line of said State Route 60;

Thence leaving the Southerly line of said Tract 1 and following the Westerly right-of-way line of said State Route 60 the following courses:

Thence South 34 degrees 07 minutes 21 seconds East for a distance of 166.74 feet to a PK Nail set; Thence South 55 degrees 16 minutes 12 seconds West for a distance of 12.46 feet to a PK Nail set; Thence South 34 degrees 43 minutes 48 seconds East for a distance of 43.00 feet to a point; Thence North 55 degrees 15 minutes 30 seconds East for a distance of 12.00 feet to a right-of-way concrete monument found; Thence South 34 degrees 07 minutes 21 seconds East for a distance of 27.84 feet to a 1/2" rebar pin found and said point being the POINT OF BEGINNING.

Said property contains 1.17 acres more or less.

ATTACHMENT 2

STATE OF GEORGIA PROJECT #:STP00-0003-00(626)

COUNTY OF HALL P.I. #: 0003626

PARCEL 143 OWNER: Habersham Partners LLC
3585 Thompson Bridge Rd

TAX ID # 10104 000017C

Granted is additional, required right of way, in Fee Simple, based on the plans mentioned herein and more particularly described below.

All that tract or parcel of land lying and being in Land Lot 104 of the 10th District, Hall County, Georgia and being more particularly described as follows:

BEGINNING at point lying 49.00 feet left of station 190+74.86 per right of way plans prepared by WSP USA, Inc. for Georgia Department of Transportation, Sardis Road Connector, approved January 2, 2020 and having a latest revision date of 05/19/2022.

thence proceeding thru the property now or formerly of Habersham Partners LLC, the following courses and distances North 31°16'00" East, 41.14 feet to a point lying 49.00 feet left of station 191+16.00;

thence North 01°10'41" East, 62.61 feet to a point lying 80.39 feet left of station 191+70.17;

thence North 55°42'52" East, 26.46 feet to a point lying 69.43 feet left of station 191+94.26;

thence along the existing right of way of Thompson Bridge Road (right of way varies) the following courses and distances South 34°16'52" East, 119.67 feet to a point lying 39.50 feet right of station 191+44.72;

thence South 83°13'18" West, 14.06 feet to a point lying 28.43 feet right of station 191+36.06;

thence along the property now or formerly of Habersham Partners LLC, the following courses and distances South 83°11'48" West, 11.31 feet to a point 19.53 feet right of station 191+29.09;

thence South 83°11'49" West, 39.56 feet to a point 11.62 feet left of station 191+04.69;

thence South 82°40'29" West, 47.83 feet to the POINT OF BEGINNING.

Said tract contains 6,237.28 square feet or 0.143 acre per the aforementioned right of way plans.

The part described above is to match the plans. In the event of conflict between this page and the plans, the overall description in the plans governs the part taken.

ATTACHMENT 3

STATE OF GEORGIA PROJECT #:STP00-0003-00(626)

COUNTY OF HALL P.I. #: 0003626

PARCEL 143 OWNER: Habersham Partners LLC
3585 Thompson Bridge Rd

TAX ID # 10104 000017C

Granted is permanent easement for the construction & maintenance of slopes and utility relocation, based on the plans mentioned herein and more particularly described below.

All that tract or parcel of land lying and being in Land Lot 104 of the 10th District, Hall County, Georgia and being more particularly described as follows:

BEGINNING at point lying 87.12 feet left of station 190+44.55 per right of way plans prepared by WSP USA, Inc. for Georgia Department of Transportation, Sardis Road Connector, approved January 2, 2020 and having a latest revision date of 05/19/2022;

thence proceeding thru the property now or formerly of Habersham Partners LLC, the following courses and distances North 14°06'05" East, 4.71 feet to a point lying 88.51 feet left of station 190+49.05;

thence North 38°15'43" East, 53.70 feet to a point lying 81.97 feet left of station 191+02.35;

thence North 50°38'38" East, 46.54 feet to a point lying 66.53 feet left of station 191+46.25;

thence South 01°10'27" West, 34.96 feet to a point lying 49.00 feet left of station 191+16.00;

thence South 31°16'00" West, 41.14 feet to a point lying 49.00 feet left of station 190+74.86;

thence along the property now or formerly of Habersham Partners LLC, South 82°46'40" West, 48.70 feet to the POINT OF BEGINNING.

Said tract contains 2,371.88 square feet or 0.054 acre per the aforementioned right of way plans.

The part described above is to match the plans. In the event of conflict between this page and the plans, the overall description in the plans governs the part taken.

ATTACHMENT 4

STATE OF GEORGIA PROJECT #:STP00-0003-00(626)

COUNTY OF HALL P.I. #: 0003626

PARCEL 143 OWNER: Habersham Partners LLC
3585 Thompson Bridge Rd

TAX ID # 10104 000017C

Granted is permanent easement for the construction & maintenance of slopes and utility relocation, based on the plans mentioned herein and more particularly described below.

All that tract or parcel of land lying and being in Land Lot 104 of the 10th District, Hall County, Georgia and being more particularly described as follows:

BEGINNING at point lying 74.91 feet left of station 191+82.21 per right of way plans prepared by WSP USA, Inc. for Georgia Department of Transportation, Sardis Road Connector, approved January 2, 2020 and having a latest revision date of 05/19/2022;

thence proceeding thru the property now or formerly of Habersham Partners LLC, the following courses and distances North 27°11'10" West, 29.70 feet to a point lying 100.22 feet left of station 191+97.75;

thence North 55°32'56" East, 9.12 feet to a point lying 96.47 feet left of station 192+06.06;

thence along the exiting right of way of Thompson Bridge Road (right of way varies) South 35°09'11" East, 29.50 feet to a point lying 69.43 feet left of station 191+94.26;

thence proceeding thru the property now or formerly of Habersham Partners LLC, South 55°42'11" West, 13.24 feet to the POINT OF BEGINNING.

Said tract contains 329.59 square feet or 0.008 acre per the aforementioned right of way plans.

The part described above is to match the plans. In the event of conflict between this page and the plans, the overall description in the plans governs the part taken.

ATTACHMENT 5

DEPARTMENT OF TRANSPORTATION STATE OF GEORGIA

RIGHT OF WAY OF PROPOSED SARDIS ROAD CONNECTOR FROM EAST OF CHESTATEE ROAD TO WEST OF S.R. 60, ALONG S.R. 283

HALL COUNTY
FEDERAL AID PROJECT
STP00-0003-00(626)

FEDERAL ROUTE No. N.A.
STATE ROUTE No. 283, 60
P.L. No. 0003036

CONVENTIONAL SIGNS	
STATE OR COUNTY LINE	-----
CITY LIMIT LINE	-----
LAND LOT LINE	-----
PROPERTY LINE	-----
SURVEY OR BASE LINE	-----
RIGHT OF WAY LINE	-----
EXISTING	-----
REQUIRED	-----
LIMIT OF ACCESS	-----
ROAD R/W & LIMIT OF ACCESS	-----
R/W MARKERS	-----
FENCE	-----
RAILROAD	-----
POWER LINE	-----
TELEPHONE LINE	-----
POWER POLES	-----
TELEPHONE OR TELEGRAPH POLES	-----

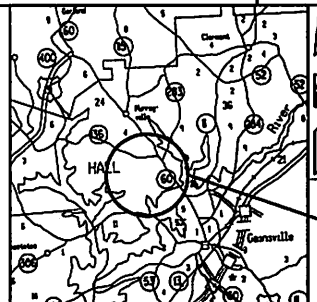

LOCATION SKETCH

NOTE: THE CO-ORDINATES LISTED ARE WEST ZONE
GRID CO-ORDINATES BASED ON THE GA STATE PLANE
CO-ORDINATE SYSTEM OF 1984.
HORIZONTAL DATUM 1983/84 NAD83
VERTICAL DATUM 1985

FUNCTIONAL CLASS:
URBAN COLLECTOR

THIS PROJECT IS 100% IN
HALL COUNTY AND IS
100% IN CORG. DIST. NO. 9.

PROJECT DESIGNATION: EXEMPT
DESIGNED IN ENGLISH UNITS.

ATTACHMENT 5

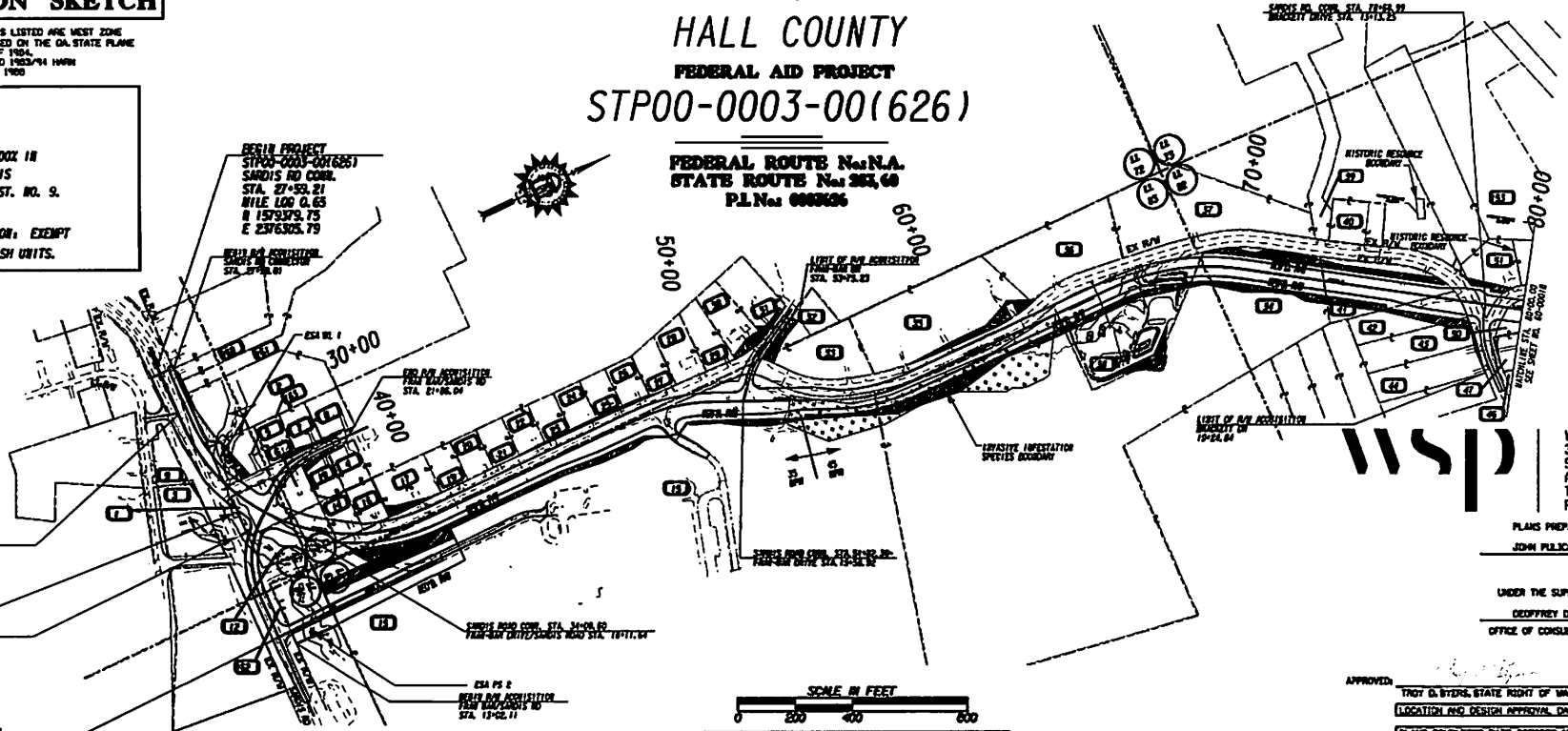

MID-POINT COORDINATES
STA. 117+84.23
N 1585505.52
E 2381387.71



LENGTH OF RIGHT OF WAY PROJECT	HALL COUNTY P.O. 039
NET LENGTH OF RIGHT OF WAY	3.44
NET LENGTH OF BRIDGES	0.000
NET LENGTH OF EXCEPTORS	0.000
GROSS LENGTH OF RIGHT OF WAY	3.44

THIS PROJECT IS LOCATED 100% IN HALL COUNTY,
LAND DISTRICTS 9 & 16 AND CNO 078

WSP
WSP USA Inc.
3048 PEACHTREE RD NE
SUITE 2428, TOWER PLACE 138
ATLANTA, GA 30326
TEL: 404-237-2015
FAX: 404-237-3815

PLANS PREPARED BY
JOHN PULLICORE, EIT

UNDER THE SUPERVISION OF
GEOFFREY DONALD, PE
OFFICE OF CONSULTANT DESIGN

APPROVED: *[Signature]* T. BRYAN, STATE RIGHT OF WAY ADMINISTRATOR DATE: 07/20/2020

REVISIONS	DATE
1	07/22/2020
2	08/24/2020
3	09/22/2020
4	10/13/2020
5	10/13/2020
6	10/13/2020
7	10/13/2020
8	10/13/2020
9	10/13/2020
10	10/13/2020
11	10/13/2020
12	10/13/2020
13	10/13/2020
14	10/13/2020
15	10/13/2020
16	10/13/2020
17	10/13/2020
18	10/13/2020
19	10/13/2020
20	10/13/2020
21	10/13/2020
22	10/13/2020
23	10/13/2020
24	10/13/2020
25	10/13/2020
26	10/13/2020
27	10/13/2020
28	10/13/2020
29	10/13/2020
30	10/13/2020
31	10/13/2020
32	10/13/2020
33	10/13/2020
34	10/13/2020
35	10/13/2020
36	10/13/2020
37	10/13/2020
38	10/13/2020
39	10/13/2020
40	10/13/2020
41	10/13/2020
42	10/13/2020
43	10/13/2020
44	10/13/2020
45	10/13/2020
46	10/13/2020
47	10/13/2020
48	10/13/2020
49	10/13/2020
50	10/13/2020

STP00-0003-00(626)
HALL COUNTY

DEPARTMENT OF TRANSPORTATION STATE OF GEORGIA

RIGHT OF WAY OF PROPOSED SARDIS ROAD CONNECTOR FROM EAST OF CHESTATEE ROAD TO WEST OF S.R. 60, ALONG S.R. 283

HALL COUNTY
 FEDERAL AID PROJECT
 STP00-0003-00(626)

FEDERAL ROUTE N.A. 11
 STATE ROUTE N.A. 283
 P.L.N. 000326

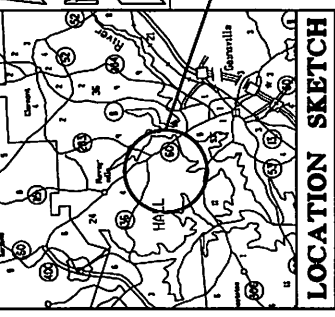

NOTES: THE CO-ORDINATES LISTED ARE WEST ZONE
 GRID CO-ORDINATES BASED ON THE GA. STATE PLANE
 HORIZONTAL DATUM 1983 AND 1985-94 HORIZ.
 VERTICAL DATUM 1985.

FUNCTIONAL CLASS:
 URBAN COLLECTOR
**THIS PROJECT IS 100% IN
 HALL COUNTY AND IS
 100% IN CONG. DIST. NO. 9.**
**PROJECT DESIGNATION: EXEMPT
 DESIGNATED IN ENGLISH UNITS.**

CONVENTIONAL SIGNS

STATE OF GEORGIA LINE	1
CITY LIMIT LINE	2
LAND LOT LINE	3
PROPERTY LINE	4
RIGHT OF WAY LINE	5
EXISTING ROAD	6
PROPOSED ROAD	7
RIGHT OF WAY LINE	8
ROAD DRAINAGE	9
EXISTING POWER LINES	10
PROPOSED POWER LINES	11
EXISTING TELEPHONE LINES	12
PROPOSED TELEPHONE LINES	13
EXISTING TELEPHONE POLES	14
PROPOSED TELEPHONE POLES	15

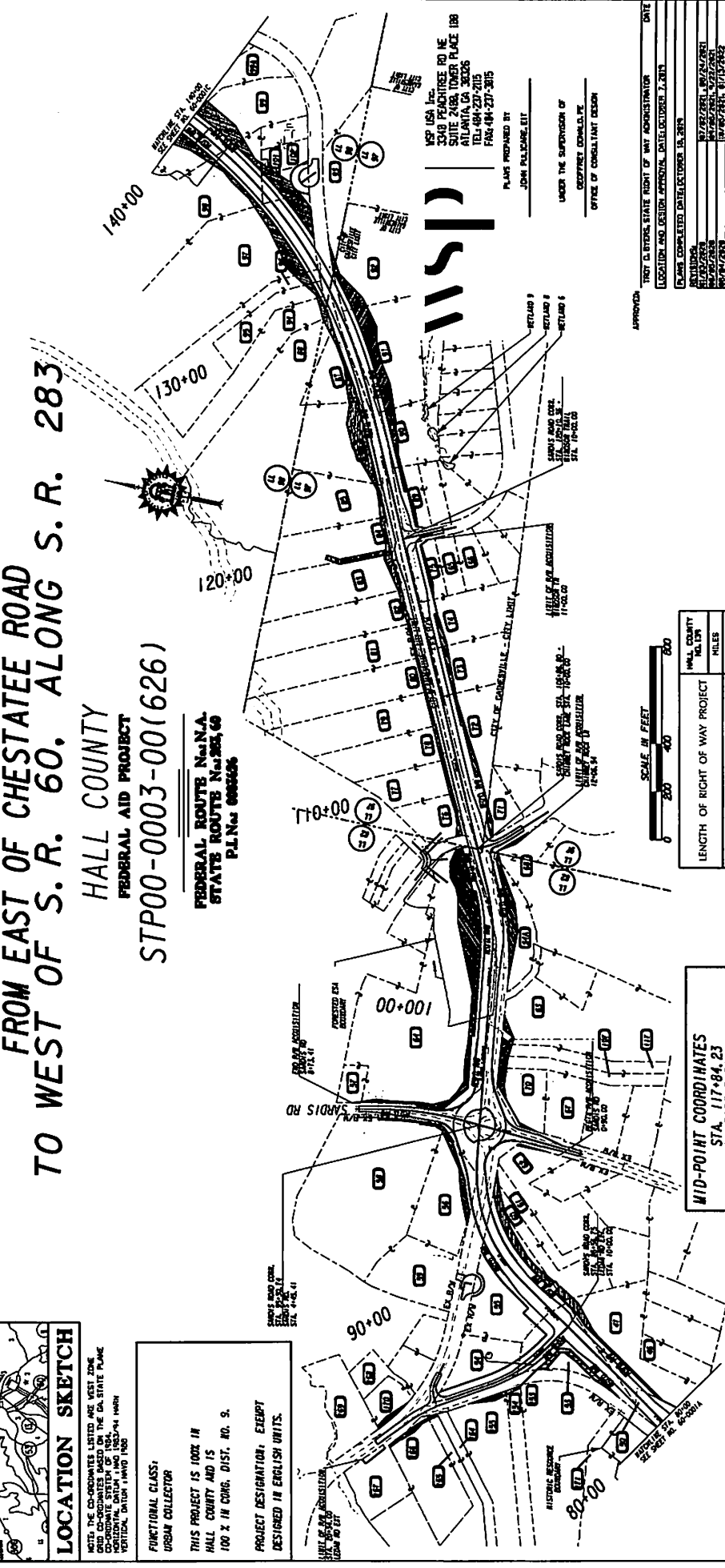

H&S USA, INC.
 1000 W. WILSON BLVD.
 SUITE 200
 ATLANTA, GA 30336
 TEL: 404-237-2015
 FAX: 404-237-3015
 PLANS PREPARED BY:
 JOHN PULSIFANT, EIT

UNDER THE SUPERVISION OF
 GEORGETE CONLEY, P.E.
 OFFICE OF CONSULTANT DESIGN

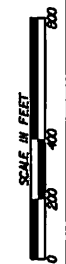

LENGTH OF RIGHT OF WAY PROJECT	3,414
NET LENGTH OF RIGHT OF WAY	8,888
NET LENGTH OF BRIDGES	8,888
NET LENGTH OF TRENCHES	8,888
GROSS LENGTH OF RIGHT OF WAY	3,414

MID-POINT COORDINATES
 STA. 117+84.23
 N 1585505.52
 E 2381387.71

STP00-0003-00(626)
 HALL COUNTY

APPROVED:

DATE	
LOCATION AND LENGTH APPROVAL DATE	OCTOBER 7, 2011
PLANS COMPLETED DATE	OCTOBER 18, 2011
DESIGNER	H&S USA, INC.
ENGINEER	JOHN PULSIFANT, EIT
DATE	10/20/2011
SCALE	AS SHOWN
PROJECT NO.	STP00-0003-00(626)
SHEET NO.	100011
TOTAL SHEETS	30

THIS PROJECT IS LOCATED IN HALL COUNTY,
 LAND DISTRICTS 9 & 10 AND 100 DTL

12/21/2022
WSP/awm/ld

Jw/awm
KT:spalborder-VBT-PG.101

003626MOTIC.dwg
DWGCON

STATE
GA

PROJECT NUMBER
STP00-0003-00(626)

SHEET NO.
60-0001C

TOTAL SHEETS
59

DEPARTMENT OF TRANSPORTATION STATE OF GEORGIA

RIGHT OF WAY OF PROPOSED SARDIS ROAD CONNECTOR FROM EAST OF CHESTATEE ROAD TO WEST OF S.R. 60, ALONG S.R. 283

HALL COUNTY

FEDERAL AID PROJECT
STP00-0003-00(626)

FEDERAL ROUTE No. N.A.
STATE ROUTE No. 283, 60
P.L. No. 0003626

CONVENTIONAL SIGNS	
STATE OR COUNTY LINE	-----
CITY LIMIT LINE	-----
LAND LOT LINE	-----
PROPERTY LINE	-----
SURVEY OR BASE LINE	-----
RIGHT OF WAY LINE	EXISTING
	REQUIRED
	LIMIT OF ACCESS
	REDO R/W & LIMIT OF ACCESS R/W MARKERS
FENCE	-----
RAILROAD	-----
POWER LINE	-----
TELEPHONE LINE	-----
POWER POLES	-----
TELEPHONE OR TELEGRAPH POLES	-----



WSP USA Inc.
3340 PEACHTREE RD NE
SUITE 2408, TOWER PLACE 108
ATLANTA, GA 30326
TEL: 404-237-2115
FAX: 404-237-3815

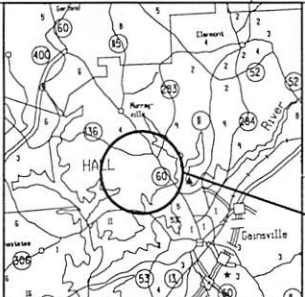

LOCATION SKETCH

NOTE: THE CO-ORDINATES LISTED ARE WEST ZONE
GRID CO-ORDINATES BASED ON THE GA STATE PLANE
CO-ORDINATE SYSTEM OF 1984.
HORIZONTAL DATUM: NAD 1983/84 NADN
VERTICAL DATUM: NAVD 1988

FUNCTIONAL CLASS:
URBAN COLLECTOR

THIS PROJECT IS 100% IN
HALL COUNTY AND IS
100% IN CONG. DIST. NO. 9.

PROJECT DESIGNATION: EXEMPT
DESIGNED IN ENGLISH UNITS.

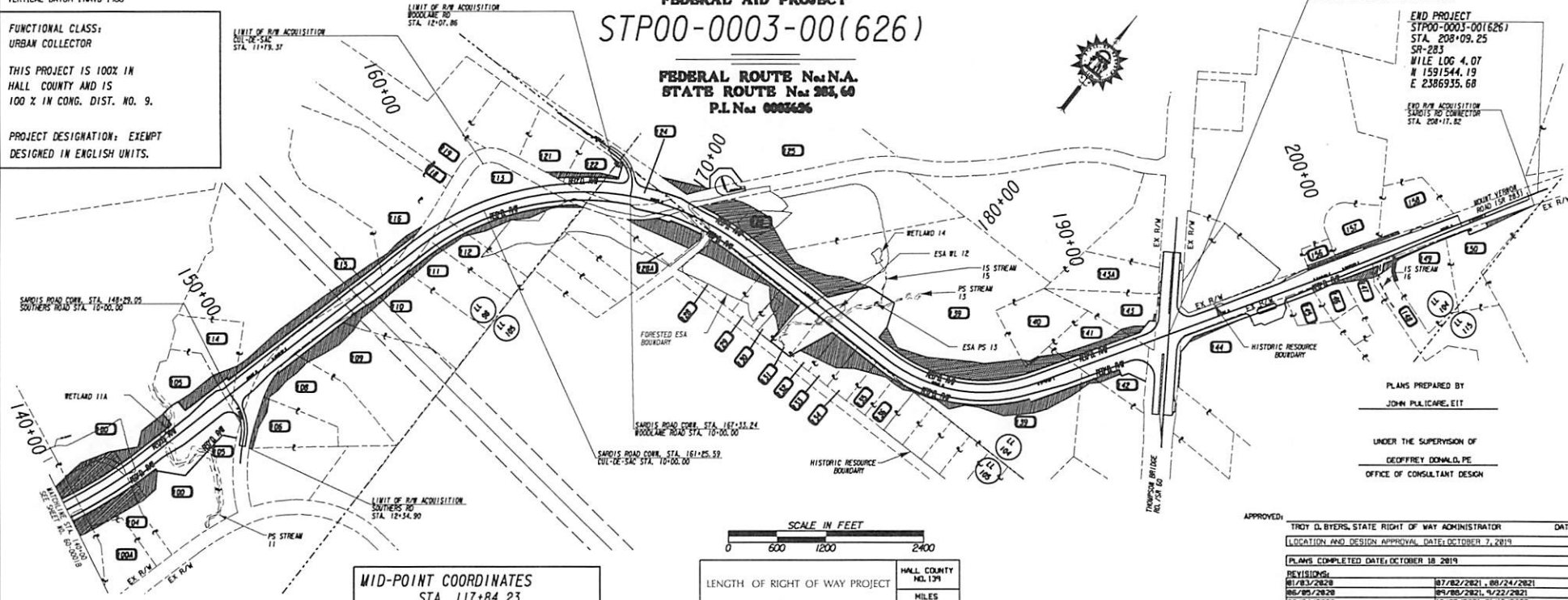

SARDIS ROAD CORN. STA. 148+29.25
SOUTHERS RD STA. 10+00.00

WETLAND 11A

PS STREAM 11

WETLAND 14

ESA RI 12

IS STREAM 15

PS STREAM 13

ESA PS 13

WETLAND 14

THOMPSON BRIDGE
R/L STA 60

SARDIS ROAD CORN. STA. 167+13.24
WOODLAKE ROAD STA. 10+00.00

SARDIS ROAD CORN. STA. 161+25.57
101+26+34.2 STA. 10+00.00

LIMIT OF R/W ACQUISITION
SOUTHERS RD
STA. 12+34.90

LIMIT OF R/W ACQUISITION
WOODLAKE RD
STA. 12+07.86

LIMIT OF R/W ACQUISITION
DILLON ST
STA. 11+76.37

END PROJECT
STP00-0003-00(626)
STA. 208+09.25
SR-283
WILE LOG 4.07
N 1591544.19
E 2386935.68

END R/W ACQUISITION
SARDIS RD CONNECTOR
STA. 208+17.82

PLANS PREPARED BY
JOHN PULICANE, EIT

UNDER THE SUPERVISION OF
GEORGE DONALD PE
OFFICE OF CONSULTANT DESIGN

APPROVED: TROY D. BYERS, STATE RIGHT OF WAY ADMINISTRATOR

LOCATION AND DESIGN APPROVAL DATE: OCTOBER 7, 2019

PLANS COMPLETED DATE: OCTOBER 18, 2019

REVISIONS:

01/23/2020

02/18/2021

07/22/2021

08/24/2021

09/23/2021

10/13/2022

02/15/2022

03/16/2022

05/11/2022

01/07/2021

03/26/2021

05/12/2021

06/07/2021

06/23/2021

06/23/2021

06/23/2021

SH. BIC OF 59

SCALE IN FEET

0 600 1200 2400

LENGTH OF RIGHT OF WAY PROJECT	HALL COUNTY NO. 139
	MILES
NET LENGTH OF RIGHT OF WAY	3.414
NET LENGTH OF BRIDGES	0.000
NET LENGTH OF EXCEPTIONS	0.000
GROSS LENGTH OF RIGHT OF WAY	3.414

THIS PROJECT IS LOCATED 100% IN HALL COUNTY,
LAND DISTRICTS 9 & 16 AND CND 078.

MID-POINT COORDINATES
STA. 117+84.23
N 1585505.52
E 2381387.71

STP00-0003-00(626)
HALL COUNTY

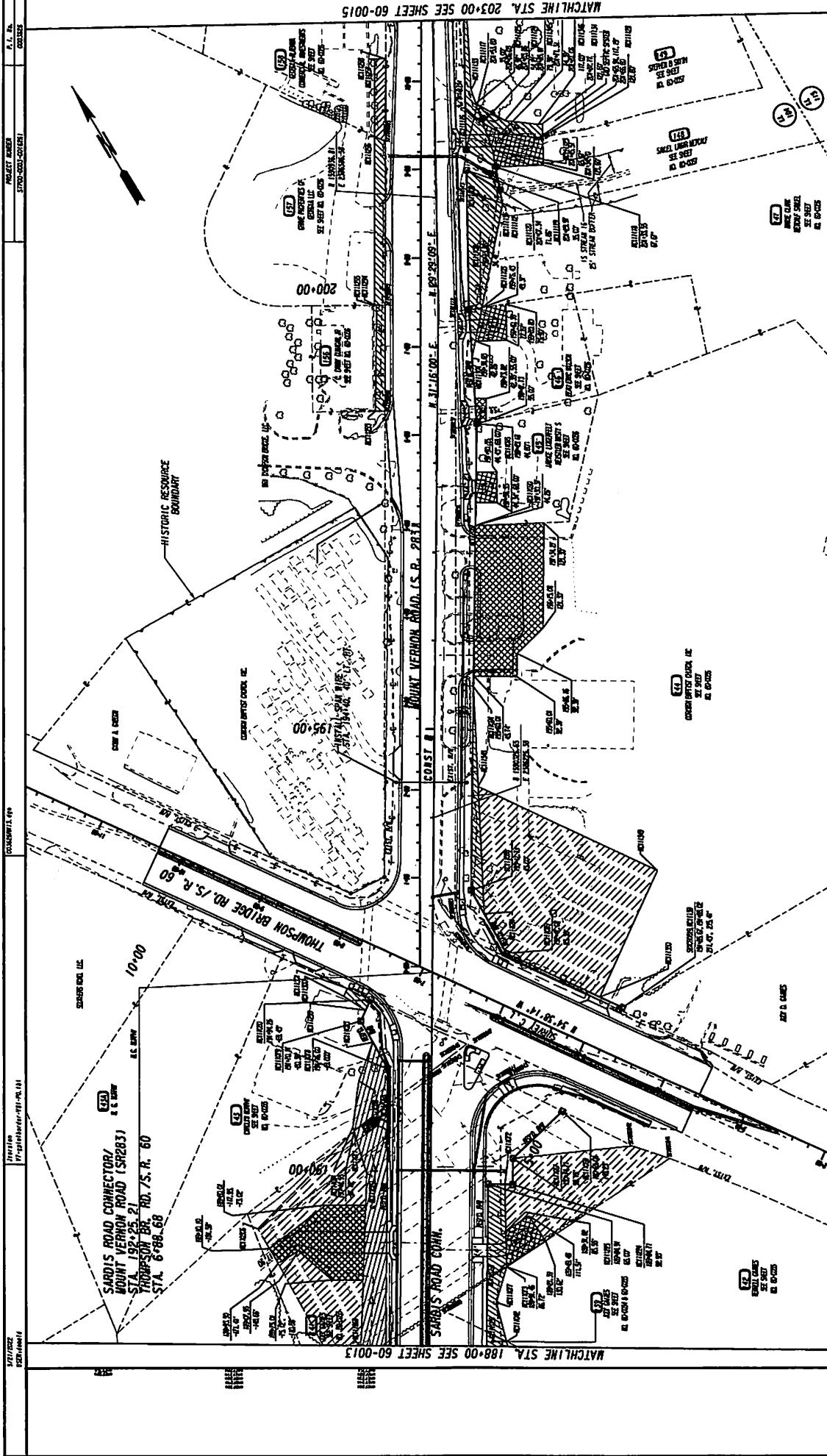

PROPERTY AND EXISTING ROW LINE REQUIRED ROW LINE CONSTRUCTION LIMITS EASEMENT FOR CONSTR & MAINTENANCE OF SLOPES & UTILITY RELOCATION EASEMENT FOR CONSTR OF SLOPES EASEMENT FOR CONSTR OF DRAVES		LEGH LIMIT OF ACCESS.....RLA LIMIT OF ACCESS.....ELA ROW AND LIMIT OF ACCESS EXISTING ROW LINE		DATE REVISIONS 11/20/2020 ALL PHASES FOR UP LEVELS IN 08/17/2022 FROM 141, 142, 143, 144, 145, 146, 147, 148, 149 REVISED EXIST'S 08/17/2022 FROM 141 REVISED EXIST'S 08/17/2022 FROM 144 REVISED ROAD & ROAD EXIST 08/17/2022 COUNDED FROM 150 TO 151 TOP DRING EASEMENT 08/17/2022 ADDED SHEET 143A		DATE REVISIONS 08/17/2022 ADDED MET WALL FOR 143 RED EXIST 08/17/2022 ADDED AND SPLIT 575 WALL		STATE OF GEORGIA DEPARTMENT OF TRANSPORTATION RIGHT OF WAY MAP PROJECT NO. 6033636 COUNTY, HALL LAND LOT NO. 1, 104 LAND DISTRICT, 10 DATE: 08/17/2022 SHEET 14 OF 59	
1151p				SCALE IN FEET 0 50 100 200					

60-0014

