

PASS DRIVE AND BISCAYNE BOULEVARD - RIGHT-OF-WAY ABANDONMENT

Petition from Mr. Tomas Villeda to abandon the right-of-way of Pass Drive and Biscayne Boulevard (approx. 0.695 +/- acres).

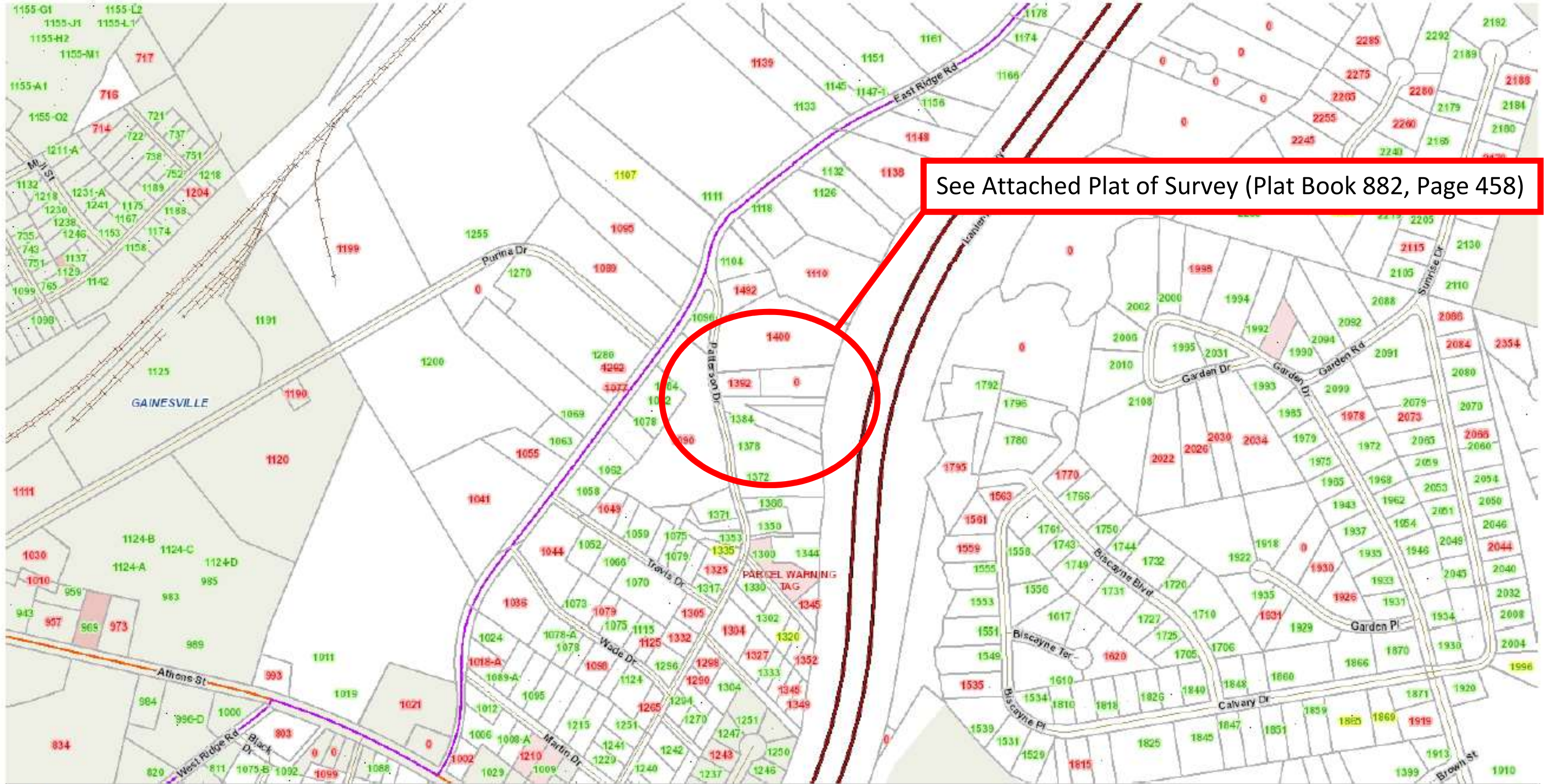

See Attached Plat of Survey (Plat Book 882, Page 458)

Map Printed On 2023-06-06 14:24

COMMENTS All of Pass Drive from the east right-of-way of Patterson Road to the west right-of-way of Lanier Parkway a.k.a. I-985 (390 +/- feet). All of Biscayne Boulevard from the east right-of-way of Patterson Road to the west right-of-way of Lanier Parkway a.k.a. I-985 (400 +/- feet).