

After recording, return to:
WHITNEY S. BROWN
STEWART, MELVIN & FROST, LLP
P. O. BOX 3280
GAINESVILLE, GEORGIA 30503

QUIT-CLAIM DEED

STATE OF GEORGIA
COUNTY OF HALL

THIS INDENTURE, made the 20th day of December in the year Two Thousand and Twenty-Three, between **ANGELA CHRISTINA HIERS A/K/A ANGELA HIERS, AS EXECUTOR OF THE ESTATE OF DOROTHY L. ALLISON**, as party or parties of the first part, hereinafter called Grantor, and **HALL COUNTY, GEORGIA**, as party or parties of the second part, hereinafter called Grantee (the words "Grantor" and "Grantee" to include their respective heirs, successors and assigns where the context requires or permits).

WITNESSETH: That Grantor for and in consideration of the sum of ONE AND NO/100 DOLLAR (\$1.00), cash in hand paid, the receipt of which is hereby acknowledged, has bargained, sold, and does by these presents bargain, sell, remise, release and forever quit-claim to Grantee all the right, title, interest, claim or demand which the Grantor has or may have had in and to the following described real property, to wit:

All that tract or parcel of land lying and being more particularly described on Exhibit "A" and Exhibit "B" attached hereto and made a part hereof.

with all the rights, members and appurtenances to the said described premises in anywise appertaining or belonging.

TO HAVE AND TO HOLD the said described premises unto the Grantee, so that neither the said Grantor, nor any other person or persons claiming under Grantor shall at any time claim or demand any right, title or interest to the aforesaid described premises or its appurtenances.

IN WITNESS WHEREOF, the Grantor has signed and sealed this deed the day and year above written.

Signed, sealed and delivered in presence of:

 (SEAL)
Witness

ANGELA CHRISTINA HIERS A/K/A ANGELA HIERS, AS
EXECUTOR OF THE ESTATE OF DOROTHY L. ALLISON

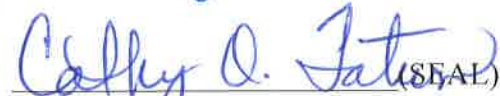
 (SEAL)
Notary Public

My Commission Expires _____

(Affix Notary Seal)



WSB 65245-59R

EXHIBIT "A"

STATE OF GEORGIA
COUNTY OF HALL

PROJECT #:STP00-0003-00(626)
P.I. #: 0003626, PARCEL 059R

All that tract or parcel of land lying and being in Land Lot 82 of the 10th District, Hall County, Georgia and being more particularly described as follows:

Beginning at a point on the northern right of way of Ledan Extension Road, said right of way being 80 feet in width, said point also lying 114.29 feet left of station 90+78.05 per right of way plans prepared by WSP USA, Inc. for Georgia Department of Transportation, Sardis Road Connector, approved January 2, 2020 and having a latest revision date of 12/08/2022;

Thence North 67°15'19.2" East a distance of 18.69 feet to a point 110.53 feet left of station 90+93.63;

Thence South 85°28'56.8" East a distance of 100.02 feet to a point 54.13 feet left of station 91+66.95;

Thence North 89°35'15.8" West a distance of 117.03 feet to the POINT OF BEGINNING.

Said tract contains 418.98 square feet or 0.010 acre per the aforementioned right of way plans, also attached hereto as "EXHIBIT B".

EXHIBIT "B"

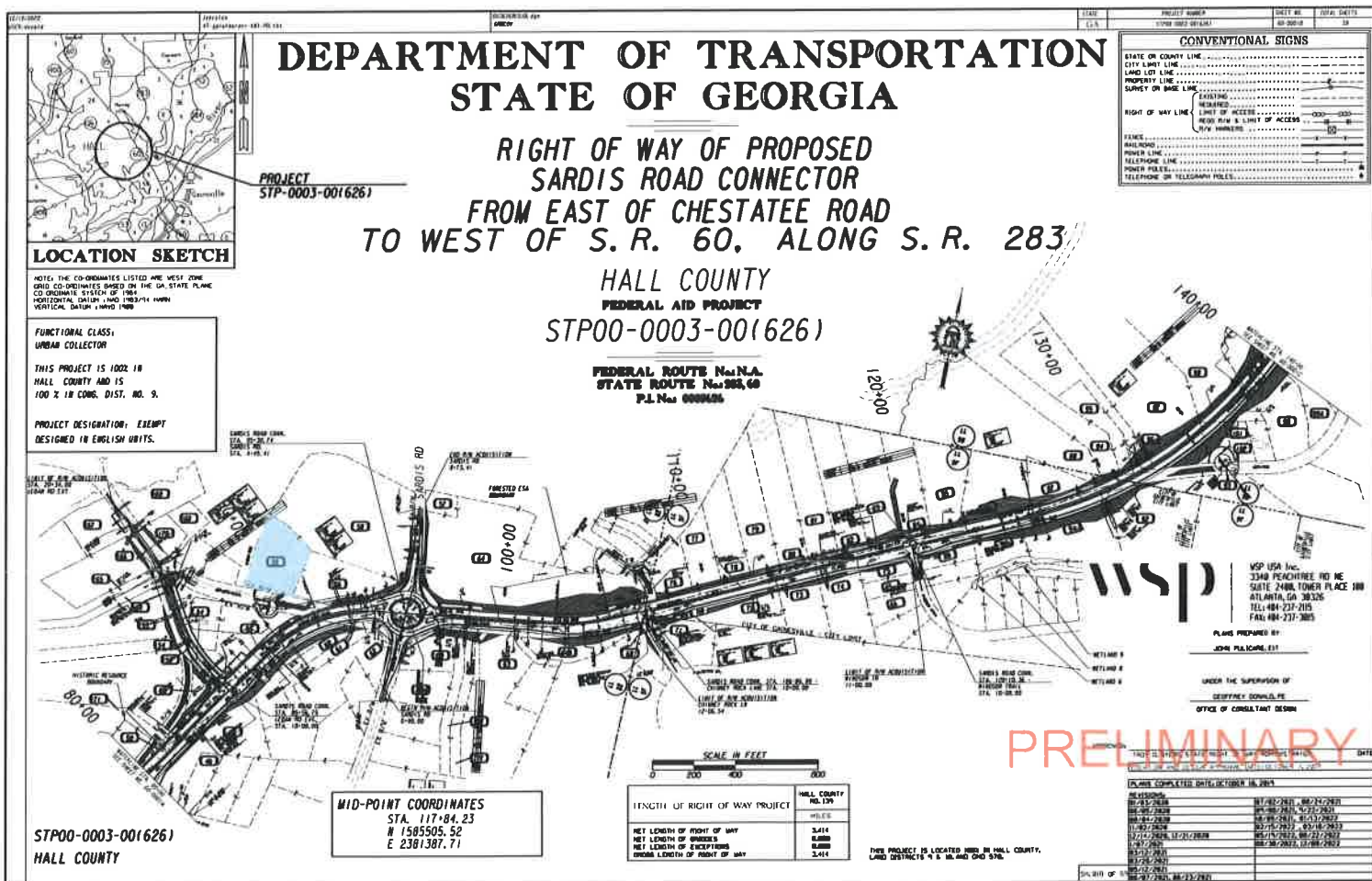

DEPARTMENT OF TRANSPORTATION STATE OF GEORGIA

**RIGHT OF WAY OF PROPOSED
SARDIS ROAD CONNECTOR
FROM EAST OF CHESTATEE ROAD
TO WEST OF S. R. 60, ALONG S. R. 283**

**HALL COUNTY
FEDERAL AID PROJECT
STP00-0003-00(626)**

**FEDERAL ROUTE No. N/A
STATE ROUTE No. 283, 60
P.L. No. 000000**

CONVENTIONAL SIGNS	
STATE OR COUNTY LINE
CITY LIMIT LINE
LAND LOT LINE
PROPERTY LINE
SURVEY OR BASE LINE
RIGHT OF WAY LINE
LIMIT OF ACCESS
NEW PLAN & LIMIT OF ACCESS
NEW NUMBER
FENCE
RAILROAD
POWER LINE
TELEPHONE LINE
POWER POLES
TELEPHONE OR TELEGRAPH POLES

LOCATION SKETCH

NOTE: THE CO-ORDINATES LISTED ARE WEST ZONE GRID CO-ORDINATES BASED ON THE GA STATE PLANE CO-ORDINATE SYSTEM OF 1983. HORIZONTAL DATUM: NAD 1983/74 NAD83. VERTICAL DATUM: NAVD 1983.

FUNCTIONAL CLASS:
URBAN COLLECTOR

THIS PROJECT IS 100% IN HALL COUNTY AND IS 100% IN COMB. DIST. NO. 9.

PROJECT DESIGNATION: EXEMPT
DESIGNED IN ENGLISH UNITS.

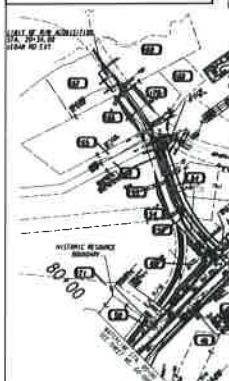

MID-POINT COORDINATES
STA. 117+84.23
N 1585505.52
E 2381387.71

SCALE IN FEET

	HALL COUNTY POL 139
LENGTH OF RIGHT OF WAY PROJECT	0.615
NET LENGTH OF RIGHT OF WAY	3.414
NET LENGTH OF BRIDGES	0.000
NET LENGTH OF ENCLOSURES	0.000
URBAN LENGTH OF RIGHT OF WAY	3.414

THIS PROJECT IS LOCATED 100% IN HALL COUNTY, LAND DISTRICTS 4 & 5, 16 AND 576.

PRELIMINARY

VSP USA Inc.
3340 PEACHTREE RIDGE
SUITE 1400, TOWER PLACE INN
ATLANTA, GA 30326
TEL: 404-237-2015
FAX: 404-237-3025

PLANS PREPARED BY:
JOHN PULICANI, EIT

UNDER THE SUPERVISION OF:
COURTNEY DONALD, PE
OFFICE OF CONSULTANT DESIGN

PLANS COMPLETED DATE: OCTOBER 16, 2014

REVISION	DATE	BY
01	10/16/2014	JP
02	10/16/2014	JP
03	10/16/2014	JP
04	10/16/2014	JP
05	10/16/2014	JP
06	10/16/2014	JP
07	10/16/2014	JP
08	10/16/2014	JP
09	10/16/2014	JP
10	10/16/2014	JP
11	10/16/2014	JP
12	10/16/2014	JP
13	10/16/2014	JP
14	10/16/2014	JP
15	10/16/2014	JP
16	10/16/2014	JP
17	10/16/2014	JP
18	10/16/2014	JP
19	10/16/2014	JP
20	10/16/2014	JP
21	10/16/2014	JP
22	10/16/2014	JP
23	10/16/2014	JP
24	10/16/2014	JP
25	10/16/2014	JP
26	10/16/2014	JP
27	10/16/2014	JP
28	10/16/2014	JP
29	10/16/2014	JP
30	10/16/2014	JP
31	10/16/2014	JP
32	10/16/2014	JP
33	10/16/2014	JP
34	10/16/2014	JP
35	10/16/2014	JP
36	10/16/2014	JP
37	10/16/2014	JP
38	10/16/2014	JP
39	10/16/2014	JP
40	10/16/2014	JP
41	10/16/2014	JP
42	10/16/2014	JP
43	10/16/2014	JP
44	10/16/2014	JP
45	10/16/2014	JP
46	10/16/2014	JP
47	10/16/2014	JP
48	10/16/2014	JP
49	10/16/2014	JP
50	10/16/2014	JP
51	10/16/2014	JP
52	10/16/2014	JP
53	10/16/2014	JP
54	10/16/2014	JP
55	10/16/2014	JP
56	10/16/2014	JP
57	10/16/2014	JP
58	10/16/2014	JP
59	10/16/2014	JP
60	10/16/2014	JP
61	10/16/2014	JP
62	10/16/2014	JP
63	10/16/2014	JP
64	10/16/2014	JP
65	10/16/2014	JP
66	10/16/2014	JP
67	10/16/2014	JP
68	10/16/2014	JP
69	10/16/2014	JP
70	10/16/2014	JP
71	10/16/2014	JP
72	10/16/2014	JP
73	10/16/2014	JP
74	10/16/2014	JP
75	10/16/2014	JP
76	10/16/2014	JP
77	10/16/2014	JP
78	10/16/2014	JP
79	10/16/2014	JP
80	10/16/2014	JP
81	10/16/2014	JP
82	10/16/2014	JP
83	10/16/2014	JP
84	10/16/2014	JP
85	10/16/2014	JP
86	10/16/2014	JP
87	10/16/2014	JP
88	10/16/2014	JP
89	10/16/2014	JP
90	10/16/2014	JP
91	10/16/2014	JP
92	10/16/2014	JP
93	10/16/2014	JP
94	10/16/2014	JP
95	10/16/2014	JP
96	10/16/2014	JP
97	10/16/2014	JP
98	10/16/2014	JP
99	10/16/2014	JP
100	10/16/2014	JP

STP00-0003-00(626)
HALL COUNTY

EXHIBIT "B"

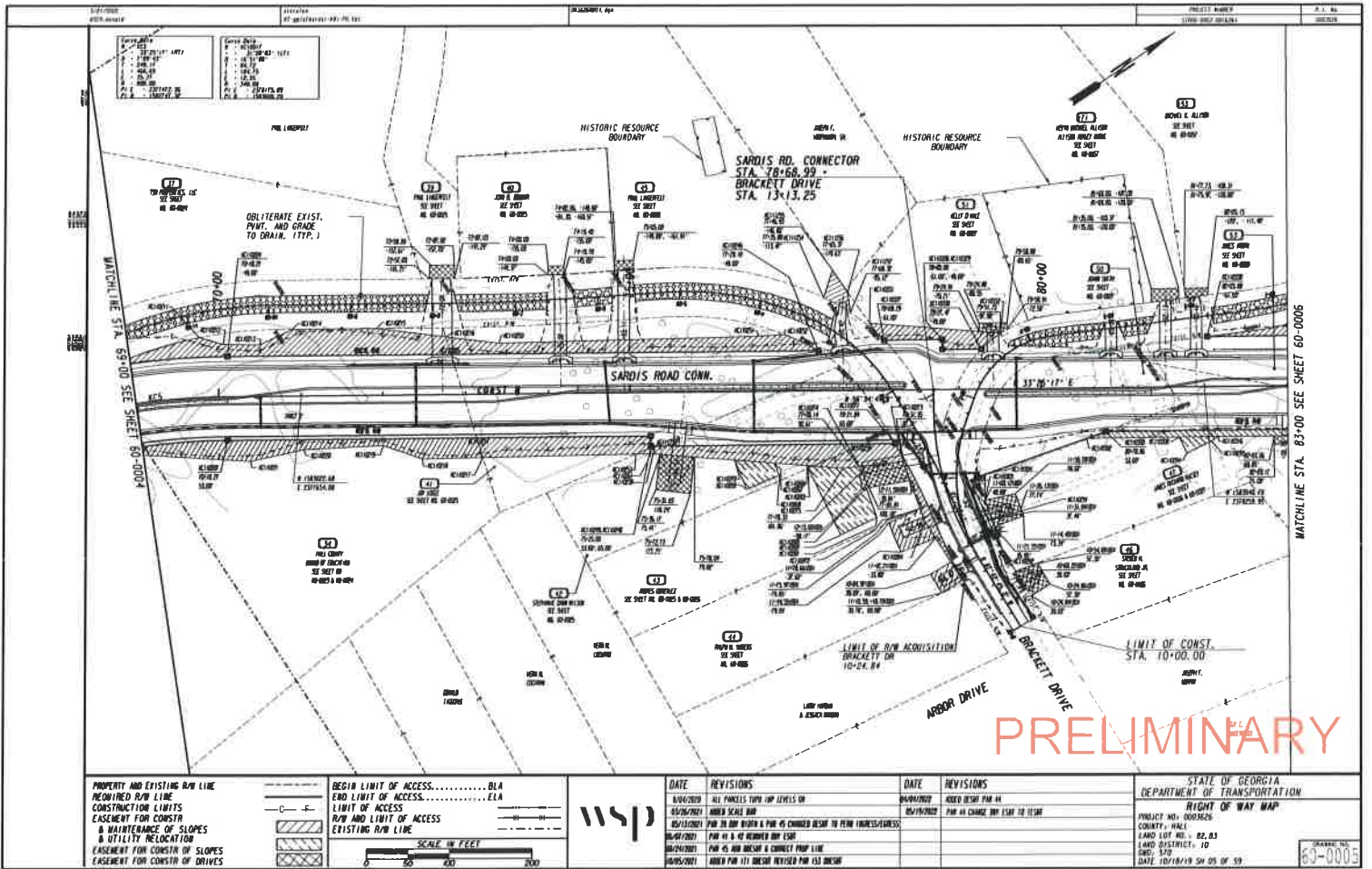

PROPERTY AND EXISTING R/W LINE	--- ---
REQUIRED R/W LINE	— — — —
CONSTRUCTION LIMITS	— — — —
EASEMENT FOR CONSTR	— — — —
& MAINTENANCE OF SLOPES	— — — —
& UTILITY RELOCATION	— — — —
EASEMENT FOR CONSTR OF SLOPES	— — — —
EASEMENT FOR CONSTR OF DRIVES	— — — —

BEGIN LIMIT OF ACCESS..... BIA	— — — —
END LIMIT OF ACCESS..... EIA	— — — —
LIMIT OF ACCESS	— — — —
R/W AND LIMIT OF ACCESS	— — — —
EXISTING R/W LINE	— — — —



DATE	REVISIONS
8/26/2019	ALL PARCELS TYPED UP LEVELS OF
8/26/2019	ADDED SCALE BAR
8/26/2019	PAR TO NEW DESIGN & PAR IS CHANGED DESIG TO PERM (IMPROVEMENTS)
8/26/2019	PAR 45 & 46 REDESIGN & CORRECT PROP LINE
8/26/2019	ADDED PAR 121 DESIGN REVISION PAR 123 DESIGN

DATE	REVISIONS
8/26/2019	ADDED DESIGN PAR 41
8/26/2019	PAR 41 CHANGE DPT EASE TO 10' EASE

STATE OF GEORGIA	
DEPARTMENT OF TRANSPORTATION	
RIGHT OF WAY MAP	
PROJECT NO.:	0005626
COUNTY:	WALKER
LAND LOT NO.:	82, 83
LAND DISTRICT:	10
SHEET:	1508
DATE:	10/18/19 5:41:05 PM '19

60-005

EXHIBIT "B"

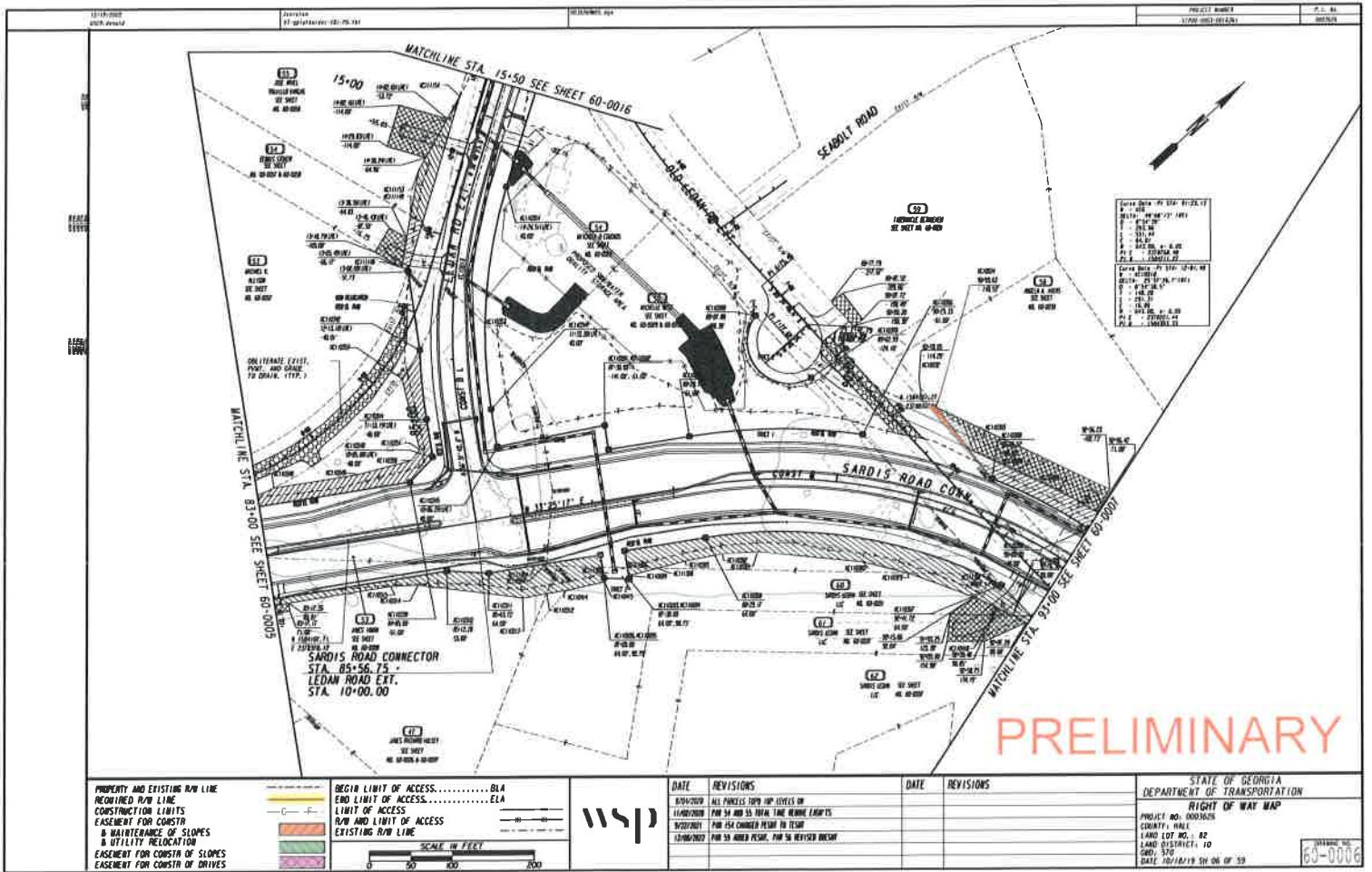

Curve Data for STA. 81+24.71
Station: 81+24.71
Radius: 100.00'
Delta: 90.00°
Chord: 141.42'
Chord BE: 141.42'
Chord CE: 141.42'
Chord DE: 141.42'
Chord FE: 141.42'
Chord GE: 141.42'
Chord HE: 141.42'
Chord IE: 141.42'
Chord JE: 141.42'
Chord KE: 141.42'
Chord LE: 141.42'
Chord ME: 141.42'
Chord NE: 141.42'
Chord OE: 141.42'
Chord PE: 141.42'
Chord QE: 141.42'
Chord RE: 141.42'
Chord SE: 141.42'
Chord TE: 141.42'
Chord UE: 141.42'
Chord VE: 141.42'
Chord WE: 141.42'
Chord XE: 141.42'
Chord YE: 141.42'
Chord ZE: 141.42'

PROPERTY AND EXISTING R/W LINE	—
REQUIRED R/W LINE	—
CONSTRUCTION LIMITS	—
EASEMENT FOR CONSTR	—
& MAINTENANCE OF SLOPES	—
& UTILITY RELOCATION	—
EASEMENT FOR CONSTR OF SLOPES	—
EASEMENT FOR CONSTR OF DRIVES	—

BEGIN LIMIT OF ACCESS.....BLA	—
END LIMIT OF ACCESS.....ELA	—
LIMIT OF ACCESS	—
R/W AND LIMIT OF ACCESS	—
EXISTING R/W LINE	—

DATE	REVISIONS	DATE	REVISIONS
08/04/2009	ALL PAGES TO BE REVISED BY		
10/02/2010	FOR 5% AND 10% TIME REMEASUREMENT		
02/20/2011	FOR 15% CHANGED PERMIT TO DESIGN		
12/06/2012	FOR 5% AND 10% PERMITS, FOR 5% REVISED DESIGN		

STATE OF GEORGIA
DEPARTMENT OF TRANSPORTATION
RIGHT OF WAY MAP
PROJECT NO. 0003625
COUNTY: WALKER
LAND LOT NO.: 82
LAND DISTRICT: 10
DATE: 10/18/19 5H 06 OF 39

SCALE IN FEET	0 50 100 200
WSP	
60-0006	

EXHIBIT "B"

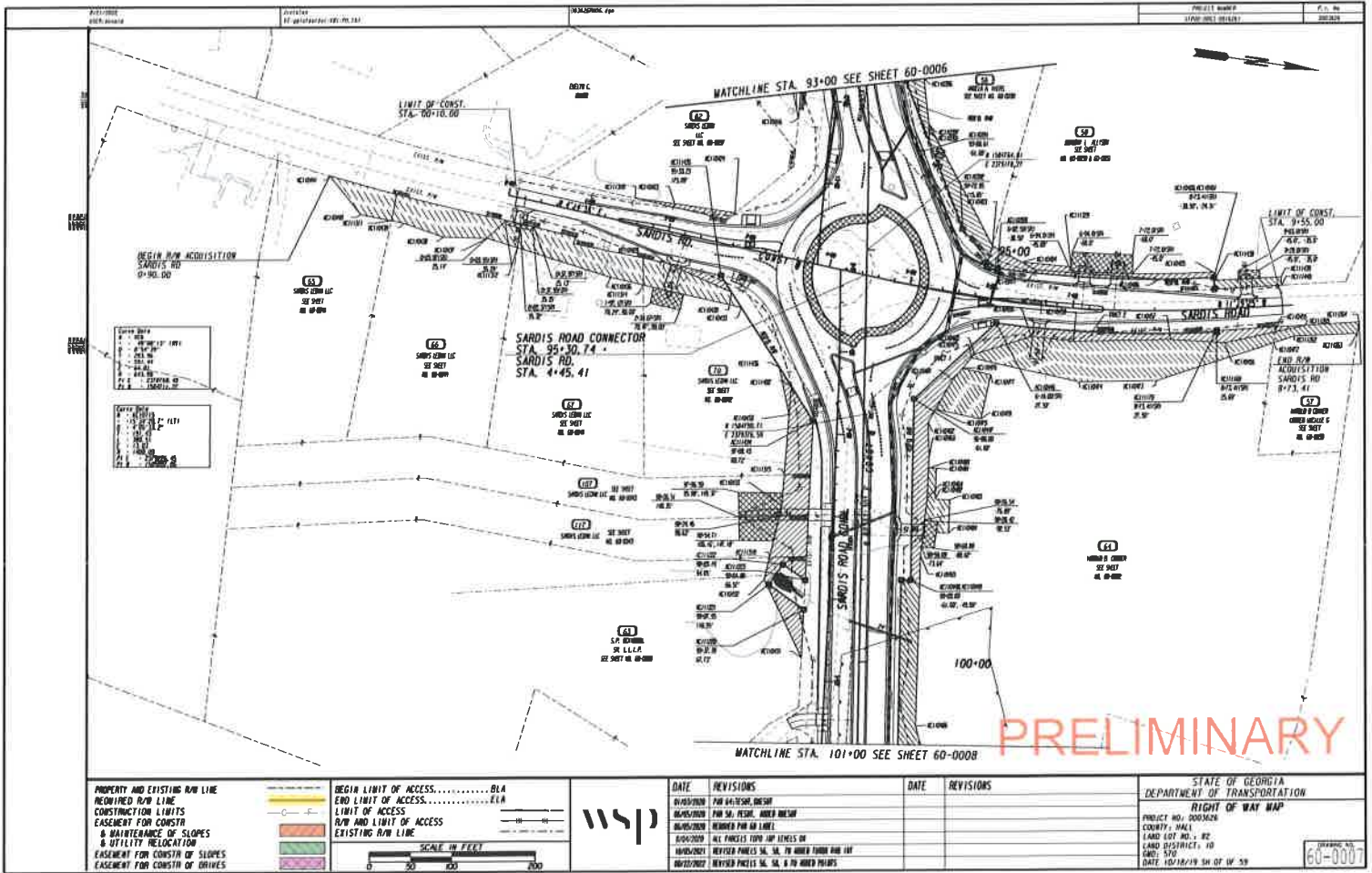

PROPERTY AND EXISTING R/W LINE
 REDEFINED R/W LINE
 CONSTRUCTION LIMITS
 EASEMENT FOR CONSTR
 & MAINTENANCE OF SLOPES
 & UTILITY RELOCATION
 EASEMENT FOR CONSTR OF SLOPES
 EASEMENT FOR CONSTR OF DRIVES



DATE	REVISIONS	DATE	REVISIONS
10/10/2019	FOR PRELIMINARY REVIEW		
10/10/2019	FOR SA. REVIEW, UNDER REVIEW		
10/10/2019	RENDERED FOR SA. REVIEW		
10/10/2019	ALL FINALS FOR MAP LAYOUT		
10/10/2019	RENDERED FOR SA. SA. FOR UNDER REVIEW FOR FIN		
10/10/2019	RENDERED FOR SA. SA. & FOR UNDER REVIEW		

DATE	REVISIONS

STATE OF GEORGIA
 DEPARTMENT OF TRANSPORTATION
 RIGHT OF WAY MAP
 PROJECT NO.: 00000000
 COUNTY: WALKER
 LAND LOT NO.: 82
 LAND DISTRICT: 10
 DATE: 10/10/19 10 OF 59

60-0007

EXHIBIT "B"

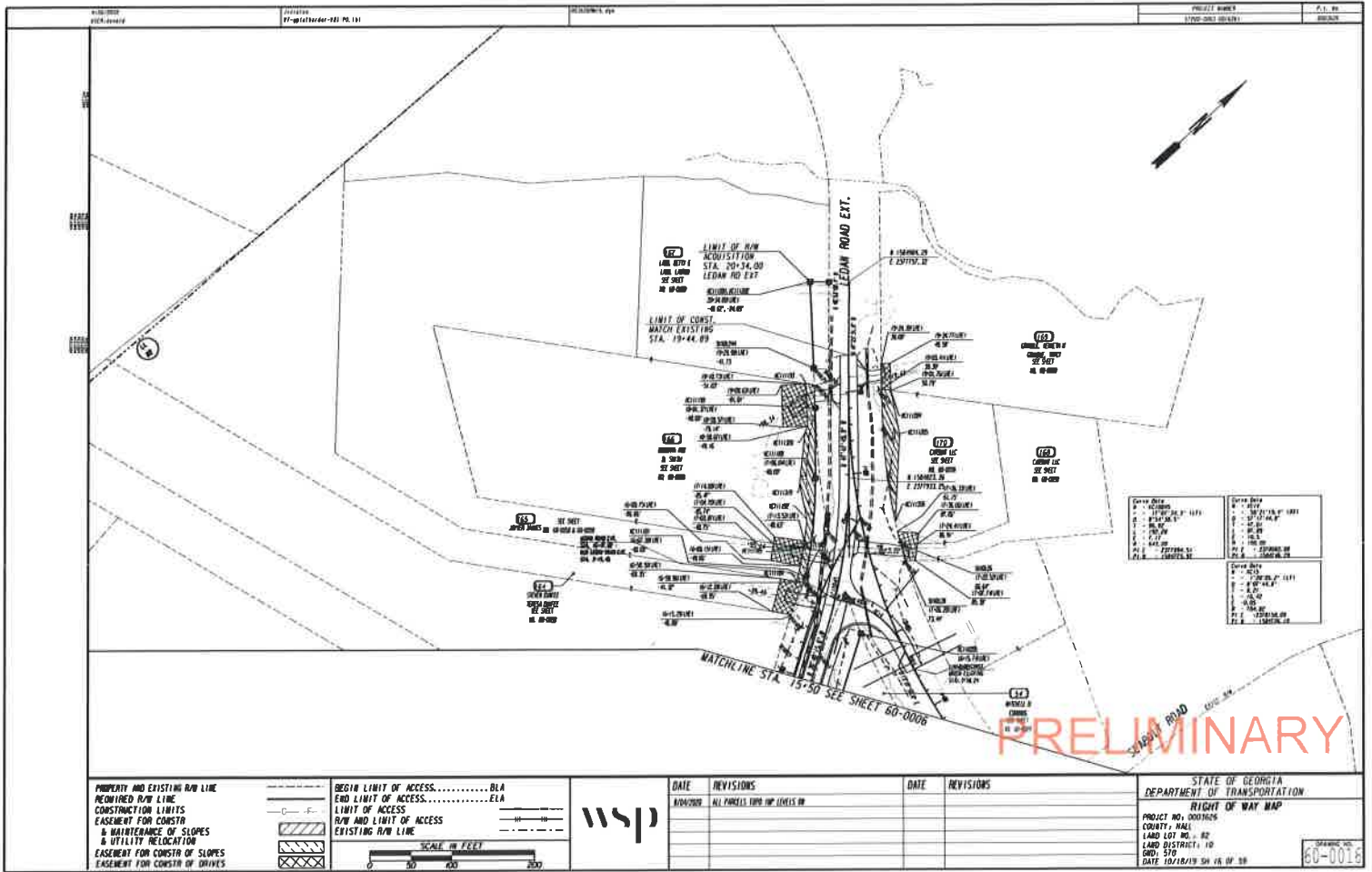

PROPERTY AND EXISTING R/W LINE	---
REQUIRED R/W LINE	---
CONSTRUCTION LIMITS	---
EASEMENT FOR CONSTR	---
& MAINTENANCE OF SLOPES	---
& UTILITY RELOCATION	---
EASEMENT FOR CONSTR OF SLOPES	---
EASEMENT FOR CONSTR OF DRIVES	---

BEGIN LIMIT OF ACCESS.....DLA	---
END LIMIT OF ACCESS.....ELA	---
LIMIT OF ACCESS	---
R/W AND LIMIT OF ACCESS	---
EXISTING R/W LINE	---

wsp

DATE	REVISIONS	DATE	REVISIONS
8/24/2017	ALL PAGES TOP UP LINES IN		

DATE	REVISIONS

STATE OF GEORGIA DEPARTMENT OF TRANSPORTATION RIGHT OF WAY MAP
PROJECT NO.: 0007026 COUNTY: HALL LAND LOT NO.: 82 LAND DISTRICT: 10 SHEET: 578 DATE 10/18/19 10:16 AM '19

60-0016

EXHIBIT "B"

