

- GENERAL NOTES:**
1. APPLICANT: PADEN M DUNAGAN
C/O LANNY DUNAGAN WELDING
1205 INDUSTRIAL BLVD
GAINESVILLE, GA 30501
678-536-0571
 2. ENGINEERING CONTACT: JAMES RIVIN @ 706-776-0067
 3. SITE AREA: 59.80 ACRES
 4. TAX PARCEL #15031400001 & 15031400002
 5. EXISTING ZONING: L-11
 6. NO PARKING IS PROPOSED FOR THIS PROPERTY AT THIS TIME.
 7. NO SIGNS ARE PROPOSED FOR THIS SITE AT THIS TIME.
 8. WATER WILL BE PROVIDED BY CITY OF GAINESVILLE.
 9. ON-SITE SEWER MANAGEMENT WILL BE PROVIDED ON EACH LOT AND MUST BE APPROVED BY THE HALL COUNTY ENVIRONMENTAL HEALTH DEPARTMENT AT TIME OF DEVELOPMENT.

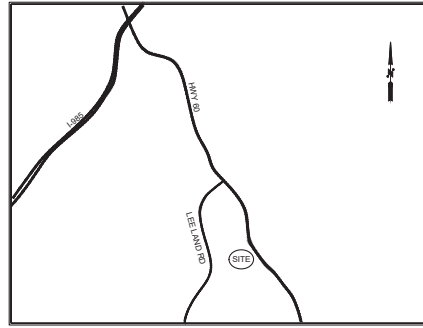

OWNER DEVELOPER:
**PADEN M DUNAGAN
C/O LANNY DUNAGAN WELDING**
1205 INDUSTRIAL BLVD
GAINESVILLE, GA 30501

SITE PLAN
**DUNAGAN
INDUSTRIAL PARK**
2010 CANDLER ROAD
GMD 1385
HALL COUNTY, GA

POINTS 'A' TO 'B' CALLS ALONG CA CREEK

LINE BEARING	DISTANCE
L1	N 82°50'00" E 26.50'
L2	N 35°10'45" W 26.50'
L3	N 31°50'04" E 30.88'
L4	N 73°51'17" E 23.04'
L5	N 41°11'00" W 23.22'
L6	N 30°12'18" E 30.20'
L7	N 81°50'00" E 33.00'
L8	N 54°12'34" E 20.33'
L9	N 31°10'00" W 44.42'
L10	N 38°32'30" W 39.84'
L11	N 82°44'30" W 35.86'
L12	N 52°21'10" W 19.45'
L13	N 18°32'30" W 32.80'
L14	N 59°42'30" W 32.30'
L15	N 82°44'30" W 35.86'
L16	N 42°44'30" E 33.89'
L17	N 30°22'30" W 45.11'
L18	N 52°31'12" W 36.30'
L19	N 52°30'00" E 33.00'
L20	N 07°21'00" W 46.89'
L21	N 38°50'00" W 39.34'
L22	N 40°17'54" W 73.35'
L23	N 41°45'41" W 65.20'
L24	N 33°37'30" W 50.37'
L25	N 06°00'00" W 44.45'
L26	N 48°00'00" W 31.14'
L27	N 12°00'00" E 33.60'
L28	N 57°40'24" W 20.25'
L29	N 10°00'00" E 43.86'
L30	N 07°33'41" E 62.50'
L31	N 01°00'00" W 43.21'
L32	N 50°10'00" E 41.48'
L33	N 48°00'00" W 20.25'
L34	N 21°18'00" W 30.75'
L35	N 34°56'14" W 44.25'
L36	N 30°00'00" W 43.87'
L37	N 20°10'48" W 30.75'
L38	N 02°12'12" W 26.18'
L39	N 37°07'40" E 11.03'
L40	N 01°00'00" W 43.21'
L41	N 44°12'30" E 26.51'
L42	N 28°00'00" W 35.87'

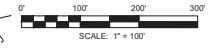

NO.	DESCRIPTION	DATE



DATE: AUGUST 30, 2021
SCALE: 1" = 100'
SHEET: C1
JOB #21062