

IMPROVEMENTS AND PROPERTY LINES SHOWN HEREON ARE BASED ON COUNTY GIS RECORDS AND GIS IMAGERY. EXHIBITS SHOWN HEREON SHALL NOT BE USED TO CONVEY PROPERTY AND SHALL NOT BE USED AS A SURVEY.



**PID # 08169 003011
CONTAINS
746,618 SQ. FT.
17.14 ACRES**

N/F
ANDREW CHONG
PID # 08169 003010
PB 116 PG 170

N/F
PAMELA B JONES
PID # 08169 003020
DB 2348 PG 23

N/F
KEITH D BELL
& BELL REGINA D.
PID # 08169 003019
DB 6161 PG 319

N/F
CHARLES D. BELL
PID # 08169 003011
DB 8942 PG 451

N/F
BONNIE N PRUETT &
PRUETT MARY ALICE
PID # 08169 003013
NO SALES HISTORY

N/F
CHARLES BELL
PID # 08169 003012
PB 22 PG 36

N/F
CHARLES BELL FAMILY L.P.
PID # 08169 003024
PB 22 PG 36

NORFOLK SOUTHERN RAILROAD
(APPARENT 400' RIGHT-OF-WAY)

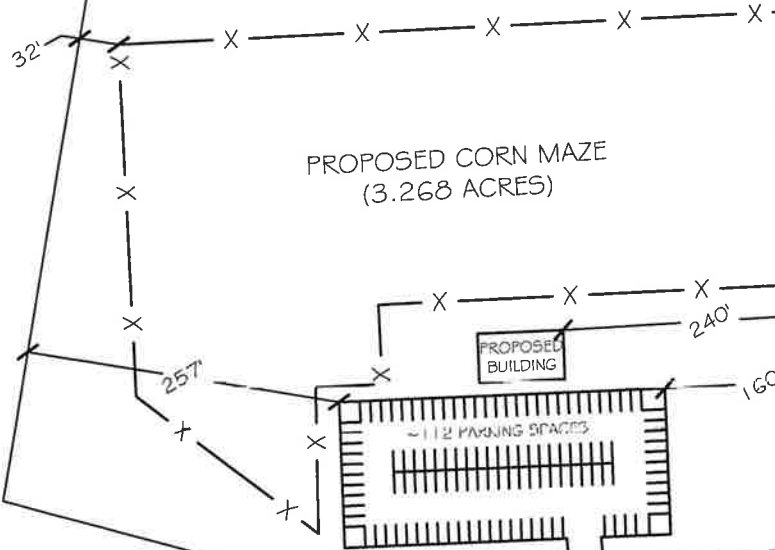

EXISTING 30' GEORGIA POWER EASEMENT

LANIER ISLANDS PARKWAY
(A.K.A. S.R. 347)
(VARIABLE RIGHT-OF-WAY)
SPEED LIMIT: 45 MPH

~CITY OF BUFORD~

N/F
STORYBROOK
ACADEMY REAL
ESTATE LLLP
PID # 08169 003022
DB 7706 PG 769

CONCEPT PLAN FOR:
C B FAMILY FARMS
CORN MAZE
LAND LOT: 169
8TH DISTRICT
HALL COUNTY, GEORGIA



GRAPHIC SCALE - FEET
SCALE: 1" = 150'

PROJECT #: 23010
DATE: 01/31/2022
DRAWN BY:RG
CHECKED BY:MCB



L.S.F. 1322
4525 SOUTH LEE STREET
BUFORD, GEORGIA 30518
678.828.9424 | www.ALLIANCECO.com

SHEET
1 OF 1