



Hall County Government

FINANCIAL SERVICES
PURCHASING DIVISION

Task Order #2026-022

September 30, 2025

POST OFFICE DRAWER 1435
GAINESVILLE, GA 30503

t: 770.535.8270 | f: 770.531.6711

FINANCIAL SERVICES DIRECTOR
Taylor Samples, CPA

ASSISTANT FINANCE DIRECTOR
Elizabeth White

PURCHASING MANAGER
Andy Youngblood

For the provision of

Sheriff's Firing Range Improvements

Demand Services for On-Call Public Works Contractors Contract #44-004

PROJECT DESCRIPTION

Hall County, Georgia Sheriff's Office is issuing this Task Order #2026-022 to Demand Services On-Call Public Works Contractors to reorientate and improve the Sheriff's Firing Range located at 2684 Allen Creek Rd, Gainesville, GA 30507.

SCHEDULE OF EVENTS

Issue Date: Friday, September 30, 2025

Mandatory Pre-bid Site Visit: Tuesday, October 7, 2025, at 9:00am EST.

Bidder Questions Due Date: Wednesday, October 15, 2025

Response to Bidder Questions Due Date: Friday, October 17, 2025

Bid Due Date: Thursday, October 23, 2025, by 2:00pm

Bidding Process: Bidders must respond with their Task Order proposals via e-mail to andrew.youngblood@hallcounty.org by 2:00pm EST Thursday, October 23, 2025.

Mandatory Pre-Bid Meeting Address: The pre-bid meeting will start promptly at 9:00am EST on Tuesday, October 7, 2025, located at 2684 Allen Creek Rd, Gainesville, GA 30507.

Questions: All communications must be directed solely to Andy Youngblood, Issuing Officer, at andrew.youngblood@hallcounty.org for questions or clarifications of the TO requirements.

Bid Response: Complete the information below and return it to the Issuing Officer via email, by the date and time specified above. Electronic signatures are acceptable.

Taxes: The County is exempt from State of Georgia Local Sales and Use Tax. The Bidder understands and acknowledges that it is responsible for any sales and use taxes it may incur. The Bidder will not charge or invoice the County any sales and use tax as a separate line item. The Contractor may request a copy of the County's Georgia Sales and Use Tax Exemption Certificate.

Bonds: Not required for this solicitation.

SCOPE OF WORK:

Please refer to the attached illustrations.

The Hall County Sheriff's Firing Range is presently orientated for live fire exercises for live ammunition to impact an earthen berm located on the southwest boundary of the firing range. The Sheriff's Office desires to reorientate the firing range for live ammunition to impact the southeast boundary of the firing range.

The awarded contractor will be responsible for all utility locates and field verifying dimensions.

- Remove and dispose of existing block wall that bisects the firing range. (Refer to black Xs on the attached illustration.)
- Relocate existing covered structures on the northeast boundary of the firing range to the northwest boundary of the firing range. (Refer to red lines on attached illustration.)
- Furnish and install precast concrete bin blocks measuring 2' x 2' x 6' along the northeastern boundary of the firing range.
 - Overall height of bin blocks shall be equal to the height of the existing bisecting block wall, approximately 12'.
 - Overall length of bin blocks shall be 75 yards at a minimum.
 - Awarded contractor is responsible for field verifying wall dimensions.
- Furnish and install precast concrete bin blocks measuring 2' x 2' x 6' in the middle of the range, parallel to the newly installed block wall along the northeastern boundary of the range. This center wall will bisect the firing range thus creating two firing ranges.
 - Overall height of bin blocks shall be equal to the height of the existing bisecting block wall, approximately 12'.
 - Overall length of bin blocks shall be 75 yards at a minimum.
 - Awarded contractor is responsible for field verifying wall dimensions.
- Relocate targets from existing berm on the southwest boundary to new berm on the southeast boundary.

New Berm

- Remove and dispose of existing light fixture along the southeast boundary of the firing range.
 - Cap and abandon electrical conduit.
- Furnish and install earthen materials to construct a new berm along the southeast boundary of the firing range. (Refer to green line on attached illustration.)
 - Furnish and install proper vegetation and/or pervious materials to control erosion and prevent stormwater runoff from the newly constructed berm.
 - Hall County will relocate targets.

Option 1

- Remove and dispose of rock from bisected area of firing range. (Refer to black Xs on the attached illustration.)
- Furnish and install sod.

Option 2

- Furnish and install concrete pad spanning the length of the bisected area of the firing range.

- The awarded contractor shall use his/her discretion regarding the removal and disposal of existing rock.

Option 3

- Clear scrub vegetation and trim trees around sniper target area.

Simpson Trucking & Grading, Inc.

(Full Legal Corporate Name)

By: 

Title: Chief Estimator

Print Name: David S. Hammond

Sworn to and subscribed before me this

22nd Day of October, 2025.

Notary Public: 

Notary commission expires:

4/7/2028

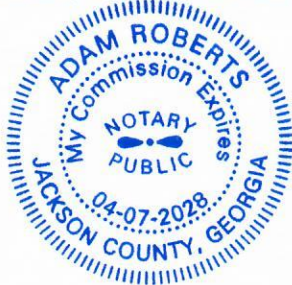

HALL COUNTY, GEORGIA

By: _____

David Gibbs, Chairman

Hall County Board of Commissioners

Date: _____

Attestation: _____

Commission Clerk



Hall County Government

FINANCIAL SERVICES
PURCHASING DIVISION

Cost Proposal Worksheet TO #2026-022 Sheriff's Firing Range Improvements

POST OFFICE DRAWER 1435
GAINESVILLE, GA 30503

t: 770.535.8270 | f: 770.531.6711

FINANCIAL SERVICES DIRECTOR
Taylor Samples, CPA

ASSISTANT FINANCE DIRECTOR
Elizabeth White

PURCHASING MANAGER
Andy Youngblood

Company Name: _____

Bidder's Name: _____

Bidder's Signature: _____

Date: _____

Instructions: Complete each cost section below.

	Cost
Earthwork *SEE NOTE BELOW	
Erosion control	
Electrical	
Remove & dispose of block wall	
Relocate covered structures	
Furnish and install 2' x 2' x 6' precast bin blocks	
Total	
Option 1	
Option 2	
Option 3	

Estimated time to completion: _____

** Excluding weather delays. Bin Blocks could push out to 25 weeks from NTP due to fabrication / procurement time.

* Earthwork price includes: Earthwork, import dirt, french drain, general conditions, and WALL ALONG THE REAR OF THE BERM. Berm cannot be constructed within space provided without inclusion of this wall. The berm as drawn on the plans with 1.25:1 slopes above the wall and wall height suggested on plans can't be realistically constructed. We have included in our price a taller structural wall along with adjusted berm slope to a more constructible gradient.

- LEGEND
- AIF - ANGLE IRON FOUND
 - AKA - ALSO KNOWN AS
 - BC - BACK OF CURB
 - BL - BUILDING SETBACK LINE
 - BWF - BARB WIRE FENCE
 - C&G - CURB & GUTTER
 - C/T - CRIMP TOP PIPE
 - CI - CURB INLET
 - CL - CENTER LINE
 - CLF - CHAIN LINK FENCE
 - CMF - CONCRETE MONUMENT FOUND
 - CMP - CORRUGATED METAL PIPE
 - CO - CLEAN OUT
 - CONC - CONCRETE
 - CORPS - US ARMY CORPS OF ENGINEERS
 - DB PG - DEED BOOK, PAGE
 - DI - DROP INLET
 - DIP - DUCTILE IRON PIPE
 - DS - DOWN SPOUT
 - DWCB - DOUBLE WING CATCH BASIN
 - EP - EDGE OF PAVEMENT
 - FFE - FINISH FLOOR ELEVATION
 - FH - FIRE HYDRANT
 - G- - GAS LINE
 - GM - GAS METER
 - GP - GUY POLE
 - GV - GAS VALVE
 - GW - GUY WIRE
 - HC - HANDICAP
 - HW - HEADWALL
 - HWF - HOG WIRE FENCE
 - IE - INVERT ELEVATION
 - IPF - IRON PIN FOUND
 - IPS - IRON PIN SET
 - JB - JUNCTION BOX
 - LL - LAND LOT
 - LLL - LAND LOT LINE
 - LP - LIGHT POLE
 - MH - MANHOLE
 - MON - MONUMENT
 - NF - NOW OR FORMERLY
 - O/T - OPEN TOP PIPE
 - PBX - POWER BOX / TRANSFORMER
 - P- - OVERHEAD POWER LINE
 - P/T- - OVERHEAD POWER & TELEPHONE LINE
 - PL - PROPERTY LINE
 - PM - POWER METER
 - PB - POINT OF BEGINNING
 - PP - POWER POLE
 - PTP - POWER & TELEPHONE POLE
 - PVC - POLYVINYLCHLORIDE PIPE
 - R/B - REINFORCING IRON BAR
 - RCP - REINFORCED CONCRETE PIPE
 - R/W - RIGHT OF WAY
 - SS- - SANITARY SEWER LINE
 - SSE - SANITARY SEWER EASEMENT
 - S/W - SIDEWALK
 - SWCB - SINGLE WING CATCH BASIN
 - TBM - TEMPORARY BENCHMARK
 - TBX - TELEPHONE BOX
 - TF - TRANSFORMER
 - TMH - TELEPHONE MANHOLE
 - TP - TELEPHONE POLE
 - TPOB - TRUE POINT OF BEGINNING
 - T- - OVERHEAD TELEPHONE LINE
 - UP - UNDERGROUND POWER
 - UT - UNDERGROUND TELEPHONE
 - WI - WEIR INLET
 - W- - WATER LINE
 - WM - WATER METER
 - WMH - WATER MANHOLE
 - WV - WATER VALVE

N/F
OF GAINESVILLE
I: 15023-000167

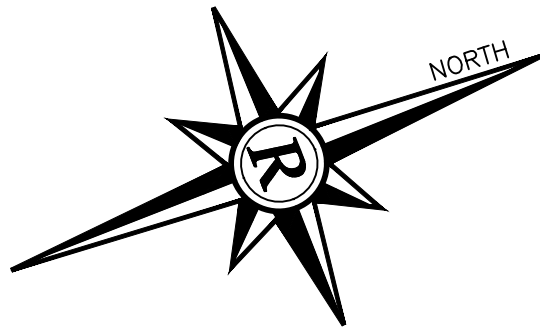
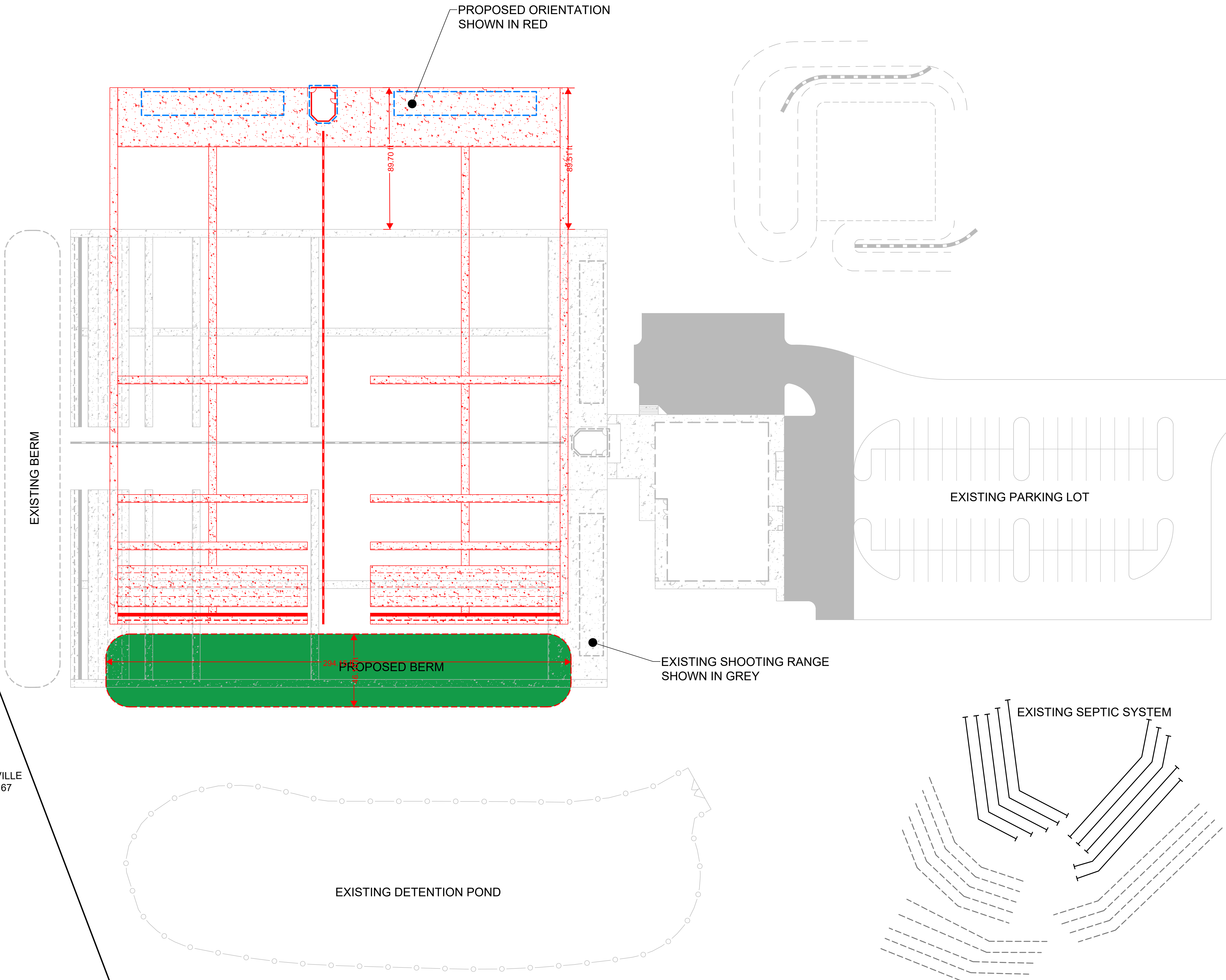

Rochester

Rochester & Associates, LLC
425 Oak St NW, Gainesville, GA 30501
770.718.0600 | rochester.dccm.com

CONCEPTUAL SITE PLAN
FOR:
**HALL COUNTY
SHERIFF'S DEPARTMENT GUN RANGE**
LOCATED IN
G.M.D. 268
HALL COUNTY, GEORGIA

ANY CHANGES OR ALTERATIONS MADE TO
THIS DRAWING SHALL BE THE RESPONSIBILITY
OF THE USER. THE USER SHALL MAINTAIN
THE WRITTEN APPROVAL OF ROCHESTER &
ASSOCIATES, LLC. ORIGINAL DRAWINGS
AND REVISIONS ARE KEPT ON FILE FOR
VERIFICATION OF ANY CHANGES.

GRAPHIC SCALE
15' 0' 30' 60'

SHEET

1

OF

1

DATE: 9/29/2025
SCALE: 1"=30'
JOB NO: 2505076-P02
DRAWN BY: SSM/awg
CHECKED BY: ATW

