



patterson·pope

SPACE MADE SIMPLE.

900 Circle 75 Parkway
Suite 1750
Atlanta, GA 30339

Georgia State Contract #
99999-001-SPD0000198-0024

Quote #: Q-78630-1
Drawing Ver: 347733 2C GA State
Date: 3/2/2026
Expires On: 5/27/2026

Install To
East Hall Library
3911 P Davidson Road
Gainesville, GA 30507

Bill To
East Hall Library

SALESPERSON	EMAIL	DELIVERY METHOD	PAYMENT METHOD
Steve Goldsmith	sgoldsmith@pattersonpope.com		NET 30

Group Name	Description	Net Total
Library Shelving	Includes all materials as illustrated in attached drawing with Acrylic End Panels	\$252,523.94
Installation & Services -	Freight, Inside Delivery, Turnkey installation and Trash Removal Included. Install to take place during Normal Business Hours: M-F 8a-5p	Included
	shelf color - cottonwood	

Sub Total:	\$252,523.94
Estimated Total Tax:	
Grand Total:	\$252,523.94

Important Proposal Notes: Georgia State Contract Procurement Requirement: Contract # 99999-001-SPD0000198-0024

Purchase Order must be made out to Spacesaver Storage Systems C/O Patterson Pope 1450 Janesville Ave Ft Atkinson, WI 53538 Email Purchase Order to Bob Tyler for processing at btyler@pattersonpope.com

Spacesaver holds the Georgia State Contract and Patterson Pope is the exclusive local area contractor for Spacesaver in the state of Georgia.

Spacesaver payment information: Spacesaver prefers US Dollar payments via ACH or wire transfer. Please use the following information and email your remittance to accountsreceivable@spacesaver.com. Payment of invoices should be sent via one of the following options.

ACH Payment: Bank Routing Number 124001545. Account Number 888905558.

Wire Transfers: JP Morgan Chase New York, NY 10017. Bank Routing 021000021 Account Number 888905558. Swift Code CHASUS33.

Physical Check Mailing Address: Spacesaver Corporation 1450 Janesville Ave. Ft Atkinson, WI 53538

Signature:  Effective Date: 3 / 3 / 2026

Name (Print): Lisa Mackinney Title: Director

Please sign and email to Steve Goldsmith at sgoldsmith@pattersonpope.com.

90"H SHELVING - 7-LEVELS

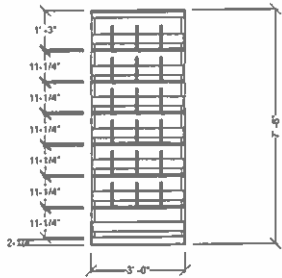

66" HIGH SHELVING - 5-LEVELS

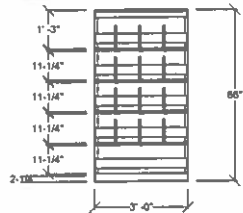

42"H SHELVING - 3-LEVELS

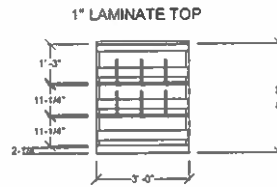

CANTILEVER SHELVING CHARACTERISTICS	
TYPE	CANTILEVER SHELVING
BASE SUPPORT	NORMAL
UNIT TYPE	SINGLE FACED / DOUBLE FACED
STANDARD FRAME HEIGHT	42" - 66" - 84"
CUT FRAME HEIGHT	NOT APPLICABLE
TOP	CANOPY TOPS ON TALL
KICKPLATES	STANDARD 3"
STANDARD SHELF	ALL PLAIN
SPECIALTY SHELF	NA
STOPS	SLOTTED BACKS
DIVIDERS	3-CLIP IN PER SHELF
LEVEL KITS	INCLUDED
OTHER ACCESSORIES	ACRYLIC END PANELS, LAMINATE TOPS

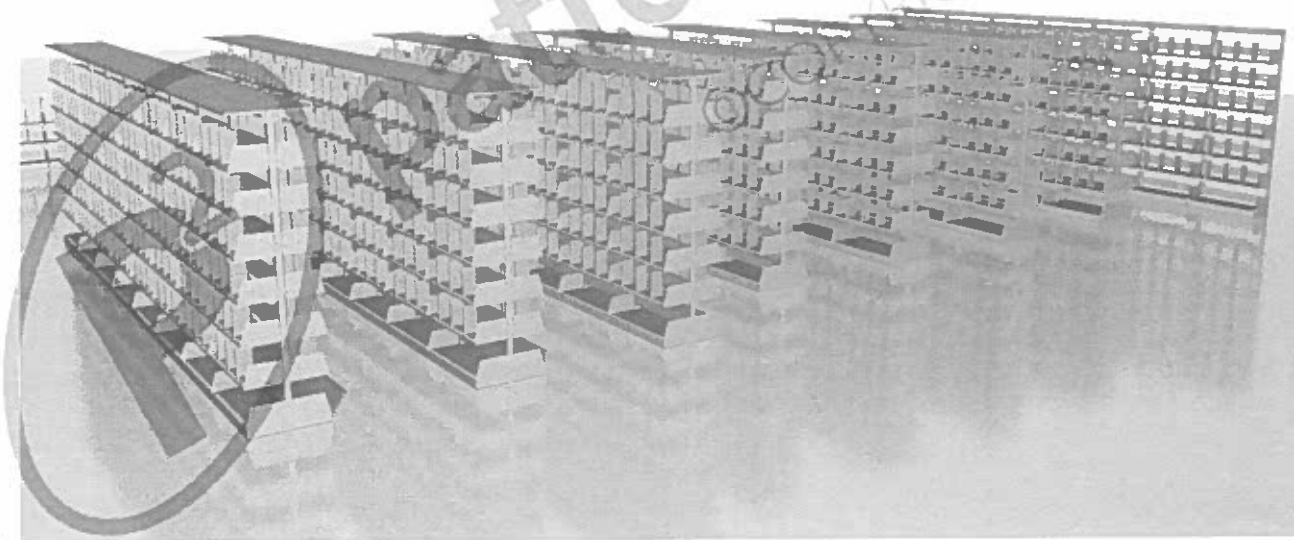

Project name:
HALL COUNTY LIBRARY - EAST HALL

Salesperson:
GOLDSMITH, STEVE

SSC PRODUCT CURRENT LEAD TIME FROM ORDER DATE
10 Weeks

ADD 1-2 WEEKS FOR DELIVERY LEAD TIME SUBJECT TO CHANGE

Rev. level:
1C

Project #:
347733
Drawn by:
K. CROWDER
Date printed:
2/26/2026

APPROVAL
This drawing is approved by:

DATE: _____



STUFF MADE **SIMPLE.**

PROPOSAL

Copyright ©2025 Patterson Pope, Inc. This material is proprietary and confidential, and the disclosure reproduction by photography, film, blueprint or otherwise or incorporation into any information retrieval system without first receiving written approval from Patterson Pope, Inc. is expressly prohibited by law.

