

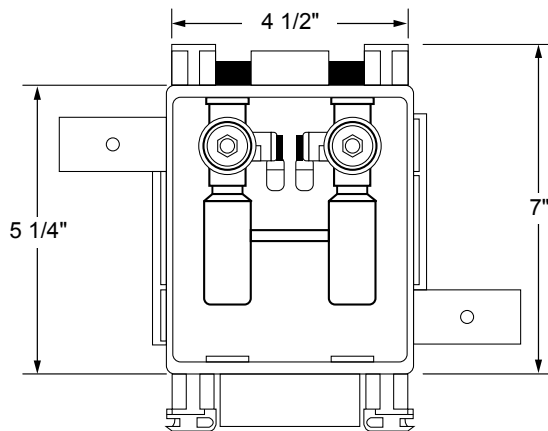

FR MultiBox™ Washing Machine Outlet Box System with Quarter Turn Valves and Hammer Arresters



Specifications: Furnish and install fire-rated MultiBox Single Washing Machine Outlet Box. Unit shall be Water-Tite product code checked below, as manufactured by IPS Corporation.

Box/Frame Material: PVC & Intumescent Pad attached

Valves: Qtr. Turn Arrester Valves with Sweat, CPVC, PEX, Wirsbo, Viega, or REHAU EVERLOC+™ connection as checked below. Valves comply with ASME A112.18.1/CSA B125.1-05. Arresters comply with ASSE 1010.

Available Accessories: 3 Universal Faceplates: Open, Solid and Louvered Stabilizer Bar

Box Certifications: Boxes have been certified with the following ratings: ASTM E814, 1 Hr (F), 41 Min (T) and 2 Hr (F), 101 Min (T)
CAN/ULC-S115-1 Hr (F/FH), 41 Min (FT/FTH) and 2 Hr (F/FH), 101 Min (FT/FTH)



Valve Certifications:

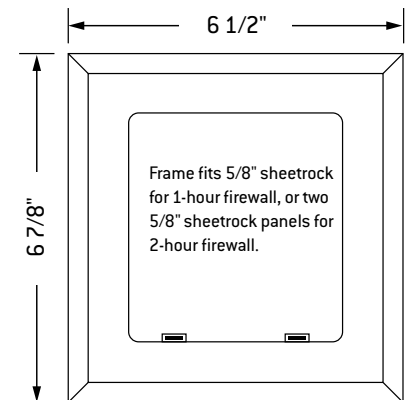
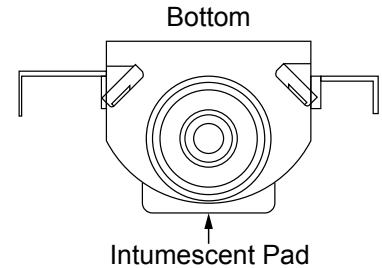
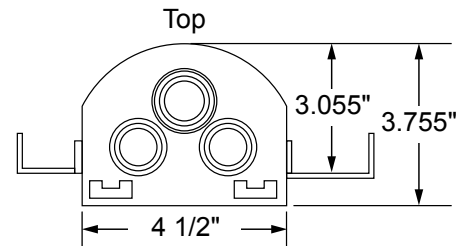

PRODUCT	DESCRIPTION	MODEL	UNITS/CASE
Hammer Arrester Standard Packs			
83044	Single Box System w/Hammer Arresters, 1/2" Sweat	MBFRS1200HA	10
83045	Single Box System w/Hammer Arresters, 1/2" CPVC	MBFRS1201HA	10
83046	Single Box System w/Hammer Arresters, 1/2" F1807	MBFRS1202HA	10
83372	Single Box System w/Hammer Arresters, 1/2" F3347	MBFRS1222HA	10
83047	Single Box System w/Hammer Arresters, 1/2" F1960	MBFRS1211HA	10
83328	Single Box System w/Hammer Arresters, 1/2" REHAU EVERLOC+™	MBFRS1205HA	10
Hammer Arrester Contractor Packs			
83048	Single Box System w/Hammer Arresters, 1/2" Sweat	MBFRS1200HACP	10
83049	Single Box System w/Hammer Arresters, 1/2" CPVC	MBFRS1201HACP	10
83050	Single Box System w/Hammer Arresters, 1/2" F1807	MBFRS1202HACP	10
83051	Single Box System w/Hammer Arresters, 1/2" F1960	MBFRS1211HACP	10
83329	Single Box System w/Hammer Arresters, 1/2" REHAU EVERLOC+™	MBFRS1205HACP	10
82938	Replacement Faceplate	MBS1200DB1	1
Less Frame			
83364	Single Box System w/Hammer Arresters, 1/2" CPVC, Less Frame	MBFRS1201HALF	10