

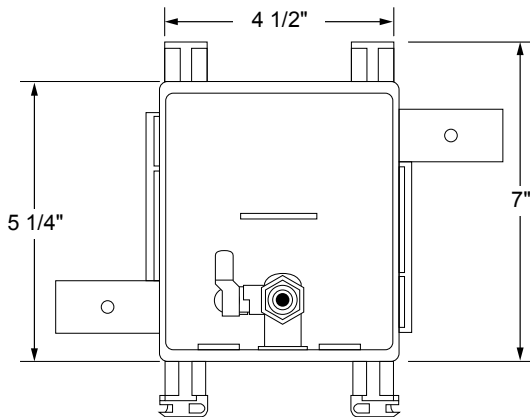

FR MultiBox™ Toilet Connection Outlet Box System with Quarter Turn Valves



Specifications: Furnish and install fire-rated MultiBox Toilet Connection Outlet Box. Unit shall be Water-Tite product code checked below, as manufactured by IPS Corporation.

Box Material: PVC & Intumescent Pad attached

Valve: Lead free Qtr. Turn Valves with 3/8" compression Outlet available with Sweat, CPVC, PEX or Wirsbo connection as checked below. Valve complies with ASME A112.18.1/CSA B125.1-05, NSF61-NSF/ANSI 372, and meets California No Lead Plumbing Law.

Available Accessories: 3 Universal Faceplates: Open, Solid and Louvered; Stabilizer Bar

Certifications:

Box

Boxes have been certified with the following ratings: ASTM E814, 1 Hr (F), 41 Min (T) and 2 Hr (F), 101 Min (T) CAN/ULC-S115-1 Hr (F/FH), 41 Min (FT/FTH) and 2 Hr (F/FH), 101 Min (FT/FTH)



Valves

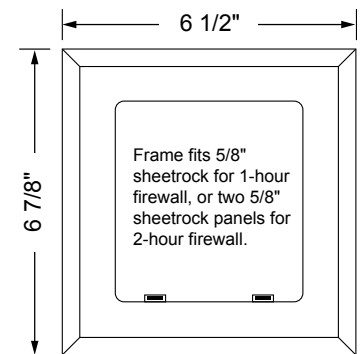
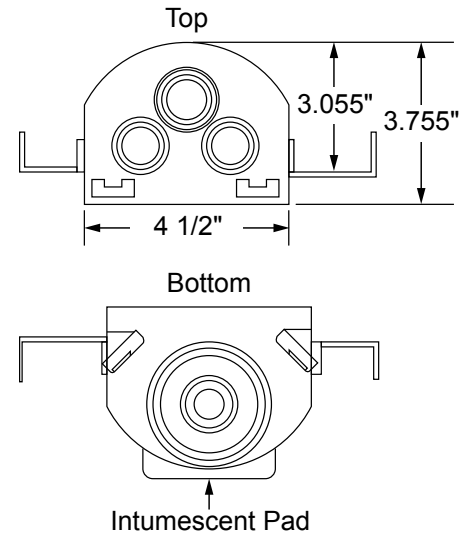
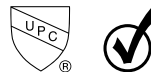

Item #	Model #	Product Description	Quantity
83088	FRTC1200	FR TCB, Qtr-turn Valves, 3/8" Sweat Connection	10
83089	FRTC1201	FR TCB, Qtr-turn Valves, 3/8" CPVC Connection	10
83090	FRTC1202	FR TCB, Qtr-turn Valves, 3/8" PEX Connection	10
83091	FRTC1211	FR TCB, Qtr-turn Valves, 3/8" Wirsbo Connection	10

