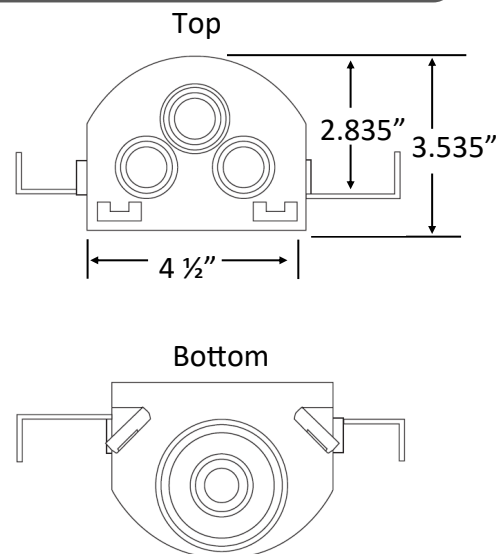
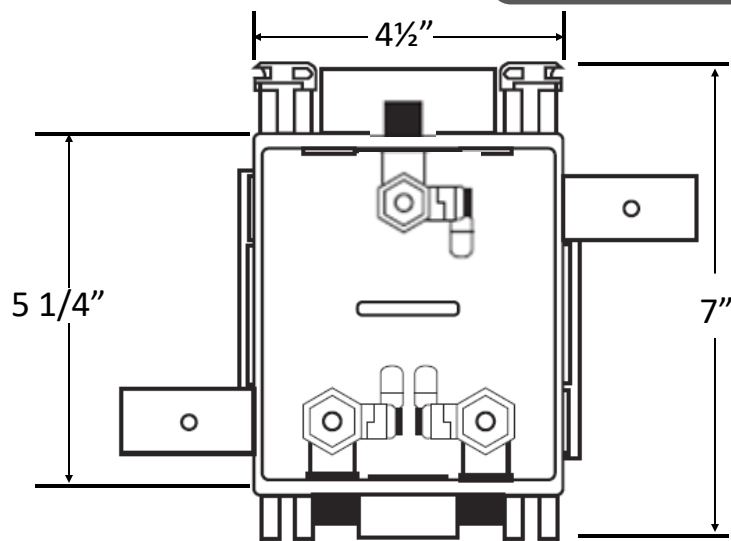

**WATER-TITE**  
 IPS CORPORATION

**MultiBox™, Kitchen Box w/Quarter Turn Valves**

**Specification:**

Furnish and install MultiBox Kitchen Box, combination dishwasher/commercial ice & angle stop with extra deep faceplate for custom fit to cabinetry. Unit shall be Water-Tite product code checked below, as manufactured by IPS Corporation.

**Box/Frame Material:**

Hi-Impact Resin

**Valves:**

Lead free Qtr. Turn Valves with 3/8" Compression Outlet available for Sweat, CPVC, PEX, Wirsbo or REHAU EVERLOC+™ connection as checked below. Valves comply with ASME A112.18.1/CSA B125.1-05, NSF61-NSF/ANSI 372, and meets No Lead Plumbing Law.

**Available Accessories:**

3 Universal Faceplates: Open, Solid and Louvered  
 Stabilizer Bar

**Certifications:**

Box   
 Valves 

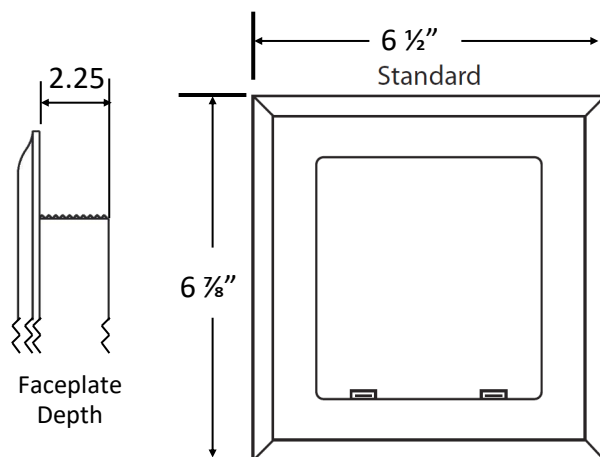

| ✓ | Product Code # | Model #  | Product Description                            | Units/Case |
|---|----------------|----------|--|------------|
|   | 83195          | ASDW1200 | Combination 3/8" AS & DW- 1/2" Sweat           | 10         |
|   | 83196          | ASDW1201 | Combination 3/8" AS & DW- 1/2" CPVC            | 10         |
|   | 83197          | ASDW1202 | Combination 3/8" AS & DW- 1/2" F1807           | 10         |
|   | 83198          | ASDW1211 | Combination 3/8" AS & DW- 1/2" F1960           | 10         |
|   | 83384          | ASDW1205 | Combination 3/8" AS & DW- 1/2" REHAU EVERLOC+™ | 10         |

**IPS**  
 CORPORATION

500 Distribution Parkway, Collierville, TN 38017 ■ 800-888-8312 ■ Fax: 901-853-5008 ■ [www.ipscorp.com](http://www.ipscorp.com)