

WATER-TITE
IPS CORPORATION

**MultiBox™, Toilet Connection Outlet Box System
with Quarter Turn Valve**

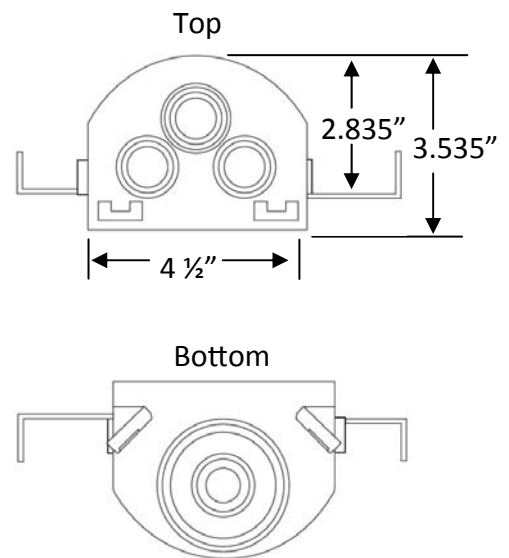
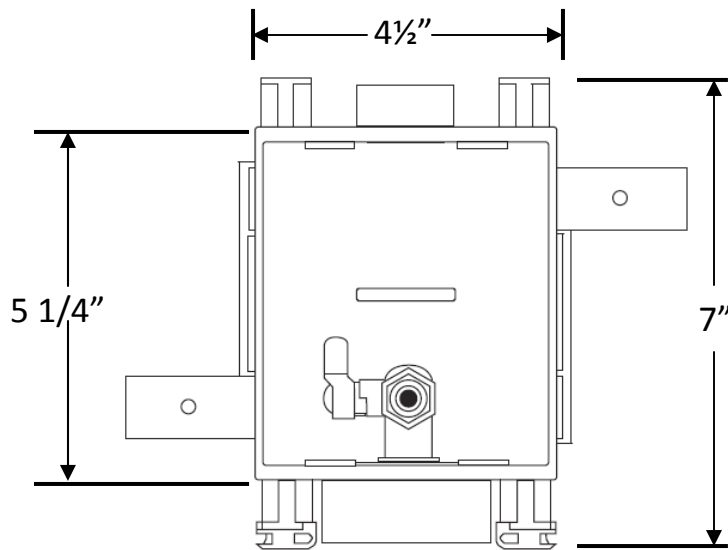

Specification:

Furnish and install MultiBox Toilet Connection Outlet Box. Unit shall be Water-Tite product code checked below, as manufactured by IPS Corporation.

Box/Frame Material:

Hi-Impact Resin

Valve:

Lead free Qtr. Turn Valve with 3/8" Compression Outlet available for Sweat, CPVC, PEX or Wirsbo connection as checked below.

Valve complies with ASME A112.18.1/CSA B125.1-05, NSF61-NSF/ANSI 372, and meets California No Lead Plumbing Law.

Available Accessories:

3 Universal Faceplates: Open, Solid and Louvered
Stabilizer Bar

Certifications:

Box 
Valve  

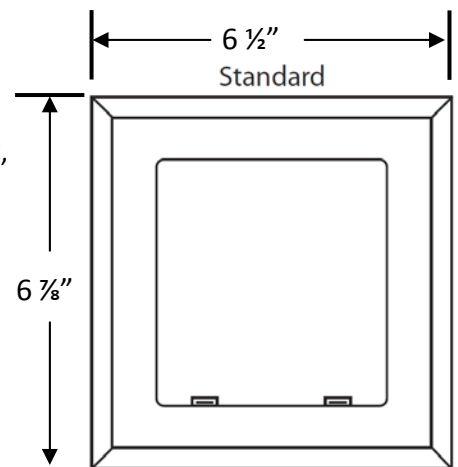

✓	Product Code #	Model #	Product Description	Units/ Case
	83183	TC1200	TCB, Qtr-turn Valve, 3/8" Sweat Connection	10
	83184	TC1201	TCB, Qtr-turn Valve, 3/8" CPVC Connection	10
	83185	TC1202	TCB, Qtr-turn Valve, 3/8" PEX Connection	10
	83186	TC1211	TCB, Qtr-turn Valve, 3/8" Wirsbo Connection	10

IPS
CORPORATION

500 Distribution Parkway, Collierville, TN 38017 ■ 800-888-8312 ■ Fax: 901-853-5008 ■ www.ipscorp.com