

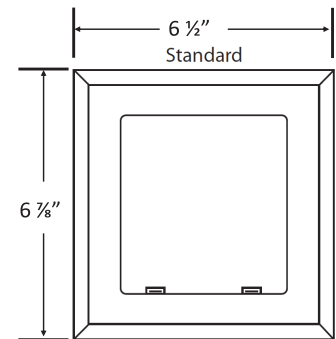

## MultiBox™, Washing Machine Outlet Box & Aux. Drain Box System with Quarter Turn Valves

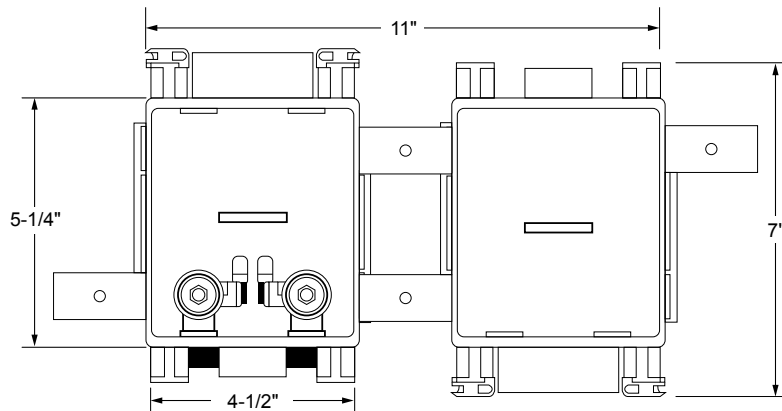

**Specifications:** Furnish and install MultiBox Washing Machine Outlet Box and Auxiliary Drain Box System. Boxes may be inter-connected or installed separately. Valve box includes DWV drain to capture hose leaks, while the drain box contains 2" drain with inte-grated knock-out for DWV testing. Unit shall be Water-Tite product code checked below, as manufactured by IPS Corporation.

**Box Material:** Hi-Impact Resin

**Valve:** Qtr. Turn Valves with Sweat, CPVC, PEX, Wirsbo or REHAU EVERLOC+™ connection as checked below. Valves comply with ASME A112.18.1/CSA B125.1-05.

**Available Accessories:** Water Softener Adapter; Condensate Adapter; 3 Universal Faceplates: Open, Solid and Louvered Stabilizer Bar

**Box Certification:**



**Valve Certification:**

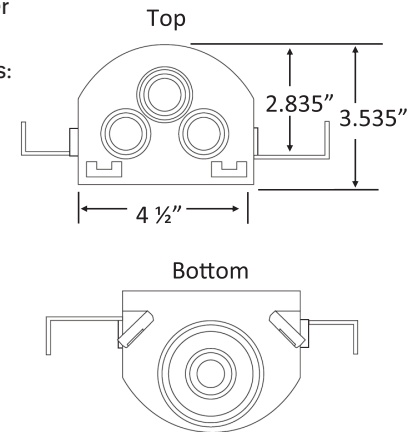

| PRODUCT                                 | DESCRIPTION   | MODEL    | UNITS/CASE |
|---|---|----------|------------|
| <b>Standard Packs</b>                   |   |          |            |
| 82906                                   | Two Box WMOB System, Qtr-turn Valves, 1/2" Sweat Conx.      | MB1200   | 10         |
| 82907                                   | Two Box WMOB System, Qtr-turn Valves, 1/2" CPVC Conx.       | MB1201   | 10         |
| 82908                                   | Two Box WMOB System, Qtr-turn Valves, 1/2" PEX Conx.        | MB1202   | 10         |
| 82909                                   | Two Box WMOB System, Qtr-turn Valves, 1/2" Wirsbo Conx.     | MB1211   | 10         |
| 83028                                   | Two Box WMOB System, Qtr-turn Valves, 1/2" F3347 Conx.      | MB1222   | 10         |
| 83172                                   | Two Box WMOB System, Qtr-turn Valves, REHAU EVERLOC+™ Conx. | MB1205   | 10         |
| <b>Hammer Arrester Contractor Packs</b> |   |          |            |
| 82910                                   | Two Box WMOB System, Qtr-turn Valves, 1/2" Sweat Conx.      | MB1200CP | 10         |
| 82911                                   | Two Box WMOB System, Qtr-turn Valves, 1/2" CPVC Conx.       | MB12001P | 10         |
| 82912                                   | Two Box WMOB System, Qtr-turn Valves, 1/2" PEX Conx.        | MB1202CP | 10         |
| 82913                                   | Two Box WMOB System, Qtr-turn Valves, 1/2" Wirsbo Conx.     | MB1211CP | 10         |
| 83173                                   | Two Box WMOB System, Qtr-turn Valves, REHAU EVERLOC+™ Conx. | MB1205CP | 10         |