

ACCESSORY SETUP INSTRUCTION

HDPE SKID PLATE ASSEMBLY -- PN 9AWV-804100-2000

VALID FOR: CF800AU-2A & CF1000AU "Overland"

BEFORE YOU BEGIN: Read and understand the instructions before starting any work. Make sure that all parts are ready and that you have all the tools required for assembly.

NOTE: CFMOTO shall not be liable for any damage caused by incorrect assembly. CFMOTO recommends that all original accessories be assembled by an authorized CFMOTO dealer.

Before assembly, park the vehicle on a flat surface, put the transmission gear into Park (P) and turn off the key switch.

Zhejiang CFMOTO Power Co., Ltd. All rights reserved. Reproduction of this document, even in part, as well as copying of all kinds, is permitted only with the express written permission of the copyright owner.

MEANING OF SYMBOLS



- Indicates information with more details or tips.



- Indicates information of warning or danger.

PARTS LIST:

ITEM	PART NAME	PART NUMBER	QTY.	REMARK
1	NUT M6	30202-060170	2	
2	WASHER 30X8	9AWV-804108-2000	20	
3	RETAINER	9AWV-804106-2000	22	
4	BOLT M6×16	30006-060016870	11	
5	BOLT M6x40	30006-060040870	14	
6	WASHER 30X4	9AWV-804109-2000	9	
7	LOCK NUT	9AWV-804107-2000	1	
8	BOLT M6×20	30006-060020870	1	
9	BRACKET, REAR SKID PLATE	9AWV-804170-2000	4	
10	FRONT SKID PLATE	9AWV-804101-2000	1	
11	MIDDLE SKID PLATE	9AWV-804102-2000	1	
12	REAR SKID PLATE	9AWV-804103-2000	1	
13	SIDE SKID PLATE	9AWV-804104-2000	2	
14	HDPE SKID PLATE ASSEMBLY	9AWV-804100-2000	1	

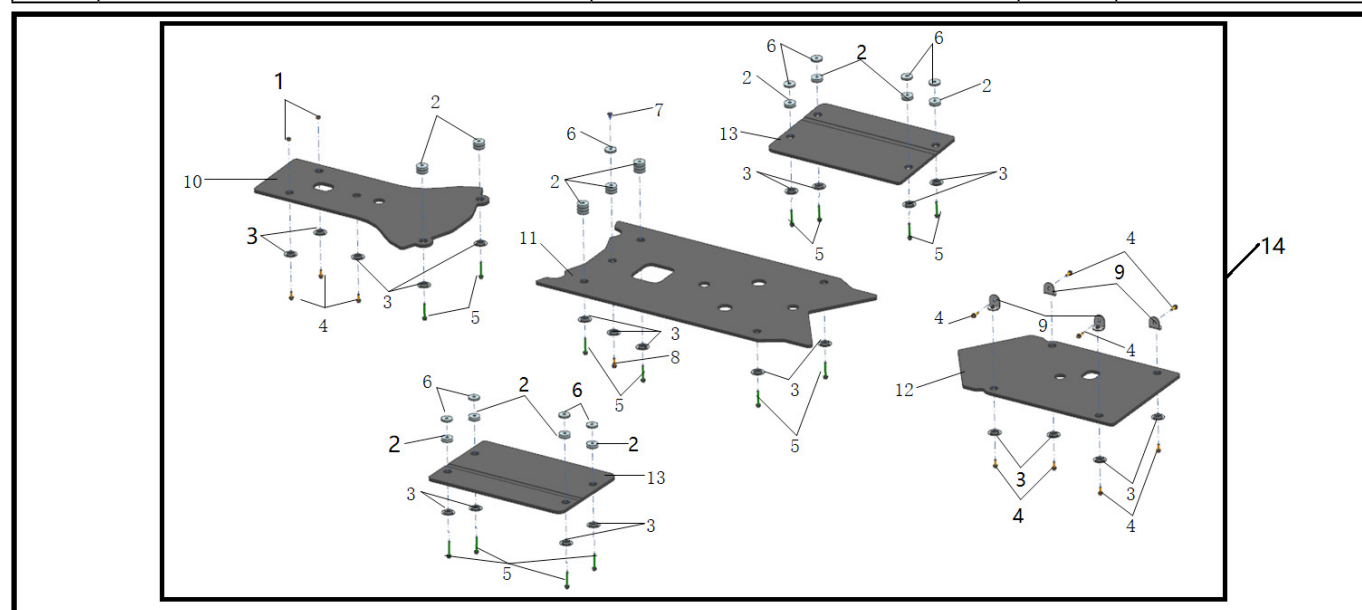

TOOL LIST:

ITEM	DESCRIPTION	QTY.	REMARK
1	10mm SOCKET	1	Recommended tools
2	PROTECTIVE GLOVES	1	

ASSEMBLY and INSTALLATION

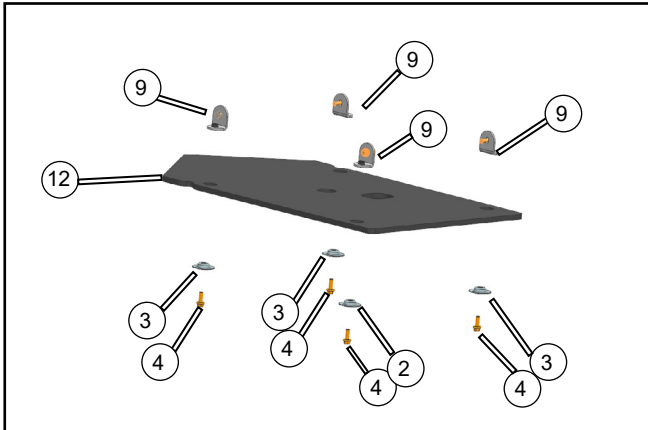

// Install the brackets (9) on the rear skid plate (12) with bolts (4) and retainers (3). Finger-tighten only.

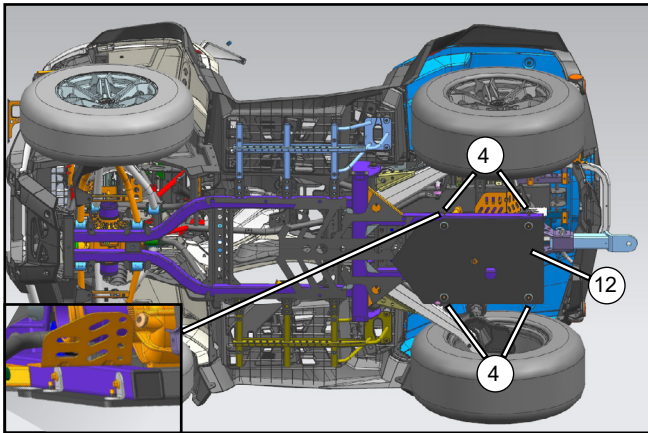

// Secure both sides of the assembled rear skid plate (12) to the rear vehicle frame with additional bolts (4), then tighten all bolts (4) evenly.

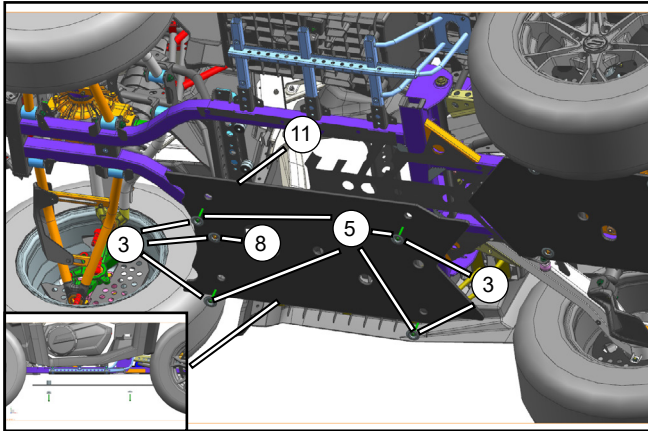

// Install the middle skid plate (11) to the corresponding position with bolts (5,8) and retainers (3), then tighten all bolts evenly.

i Before securing the middle skid plate, check to ensure washers (2,6) and lock nut (7) have not fallen off. If they fall off, they must be installed back on the middle skid plate.

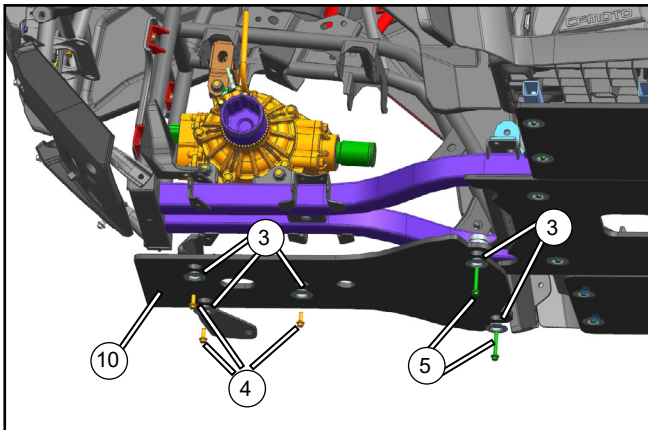

// Install the front skid plate (10) to the corresponding position with bolts (4,5) and retainers (3), then tighten all bolts evenly.

i Before securing the front skid plate, check to ensure the washers (2) and nut (1) have not fallen off. If they fall off, they must be installed back on the front skid plate.

ASSEMBLY and INSTALLATION

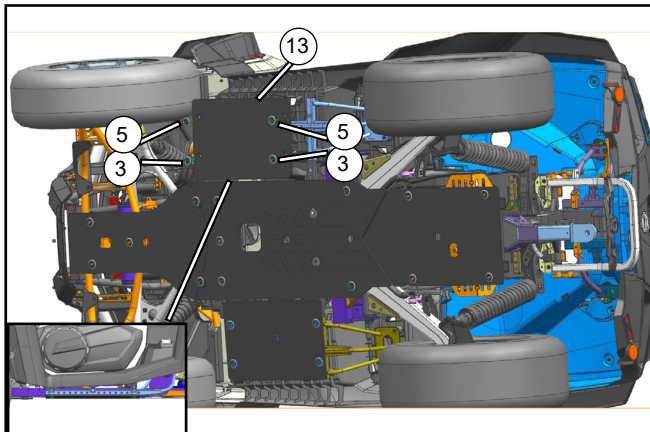

// Install the side skid plates (13) to the corresponding position with bolts (5) and retainers (3), then tighten all bolts evenly.

i Before securing the side skid plates, check to ensure the washers (2,6) have not fallen off. If they fall off, they must be installed back on the side skid plates.