



ACCESSORY SETUP INSTRUCTION

PASSENGER INFILL RACK -- PN 9DSV-803100-6000

VALID FOR: MY2020 and Newer CFORCE 600/800/1000 2-person ATVs

BEFORE YOU BEGIN: Read and understand the instructions before starting any work. Make sure that all parts are ready and that you have all the tools required for assembly.

NOTE: CFMOTO shall not be liable for any damage caused by incorrect assembly. CFMOTO recommends that all original accessories be assembled by an authorized CFMOTO dealer.

Before assembly, park the vehicle on a flat surface, put the transmission gear into Park (P) and turn off the key switch.

Zhejiang CFMOTO Power Co., Ltd. All rights reserved. Reproduction of this document, even in part, as well as copying of all kinds, is permitted only with the express written permission of the copyright owner.

MEANING OF SYMBOLS



- Indicates information with more details or tips.



- Indicates information of warning or danger.

PARTS LIST:

ITEM	PART NAME	PART NUMBER	QTY.	REMARK
1	PASSENGER INFILL RACK	9DSV-803100-6000	1	
2	PRESS PLATE, SEAT	9DSV-803101-6000	1	
3	FRAME ASSY	9DSV-803110-6000	1	
4	BRACKET, MIDDLE CARGO BOX	9AYV-801000-2A00	1	
5	BOLT M6×16	30006-060016870	6	
6	BOLT M6×40	30006-060040870	4	600 ATV
7	BOLT M6×60	9DSV-803100-6000-20	4	800/1000 ATVs
8	CUSHION MAT	9DSV-803102-6000	4	600 ATV
9	BUSHING	9AWV-803101-2000	4	800/1000 ATVs

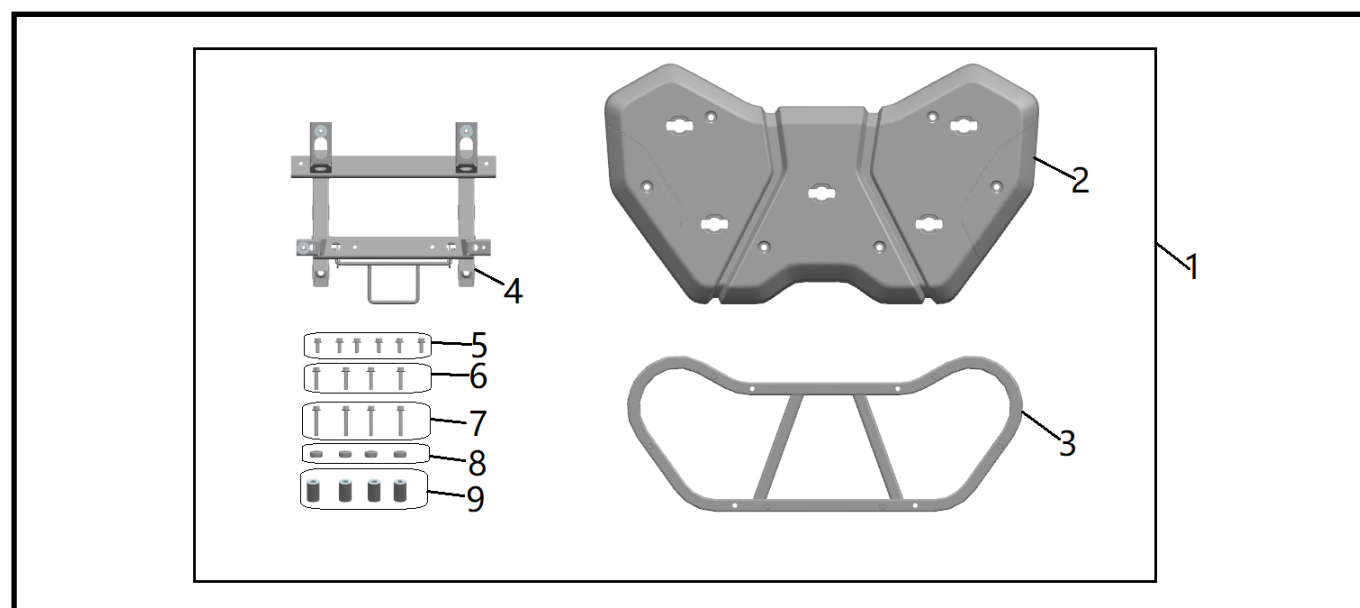

TOOL LIST:

ITEM	DESCRIPTION	QTY.	REMARK
1	PROTECTIVE GLOVES	1	Recommended Tools
2	10mm SOCKET	1	

ASSEMBLY and INSTALLATION

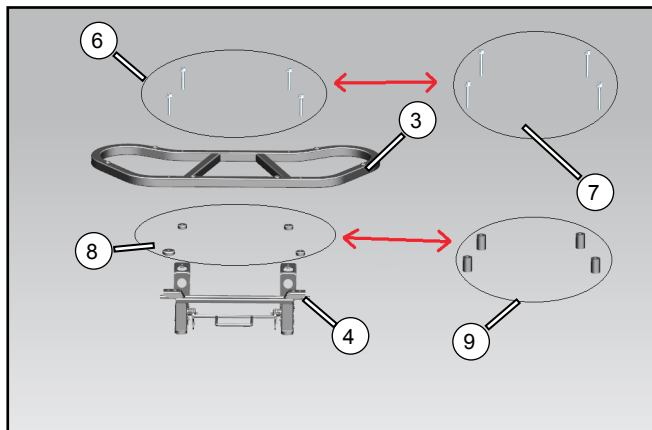

// Place the middle cargo box bracket (4) on a stable work surface, put the cushion mats (8) and frame assembly (3), then install the bolts (6) and tighten them.

i CFORCE 600 ATV extension rack assembly instruction listed. Install bolts (7) and bushings (9) in place of cushion mats (8) and bolts (6) if you have a CFORCE 800 or 1000 ATV.

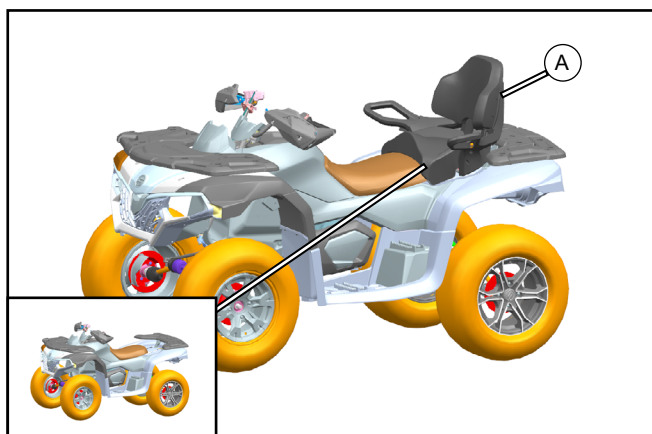

// Remove the passenger seat (A).

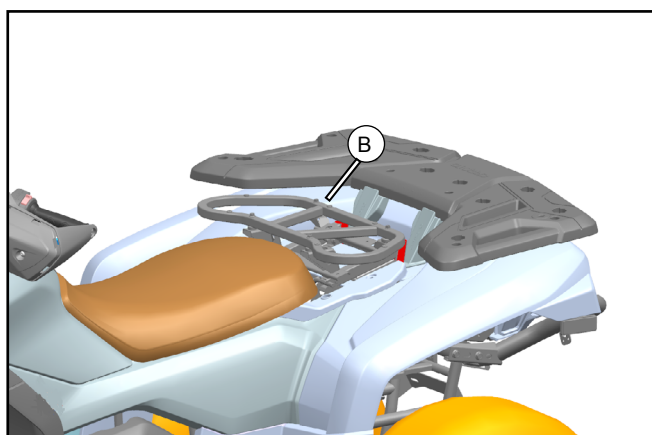

// Install the extension rack assembly (B) to the passenger seat position and lock it.

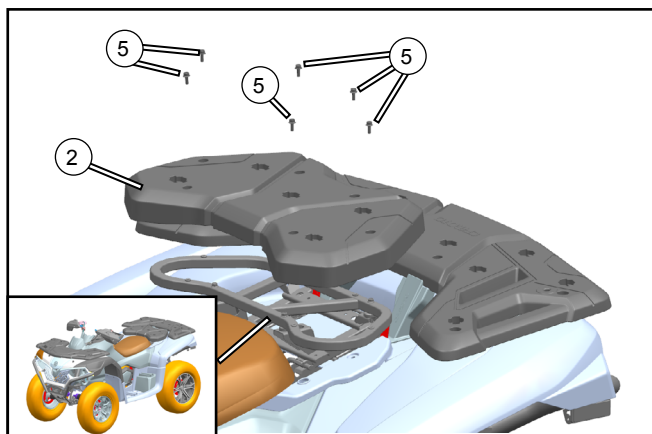

// Place the press plate (2) on the bracket, then install and tighten bolts (5).