

ACCESSORY SETUP INSTRUCTION

TAIL BOX ASSEMBLY -- PN 9AYV-806100-2A00

VALID FOR: CF800AU-2A & CF1000AU "Overland"

BEFORE YOU BEGIN: Read and understand the instructions before starting any work. Make sure that all parts are ready and that you have all the tools required for assembly.

NOTE: CFMOTO shall not be liable for any damage caused by incorrect assembly. CFMOTO recommends that all original accessories be assembled by an authorized CFMOTO dealer.

Before assembly, park the vehicle on a flat surface, put the transmission gear into Park (P) and turn off the key switch.

Zhejiang CFMOTO Power Co., Ltd. All rights reserved. Reproduction of this document, even in part, as well as copying of all kinds, is permitted only with the express written permission of the copyright owner.

MEANING OF SYMBOLS



- Indicates information with more details or tips.



- Indicates information of warning or danger.

PARTS LIST:

ITEM	PART NAME	PART NUMBER	QTY.	REMARK
1	TAIL BOX ASSY	9AYV-806100-2A00	1	
2	TAIL BOX	9AYV-806110-2A00	1	
3	CF CONNECT CLAMP	9DS#-809000-6000	4	
4	SEAL RING, TAIL BOX	9AYV-800104-2A00	4	

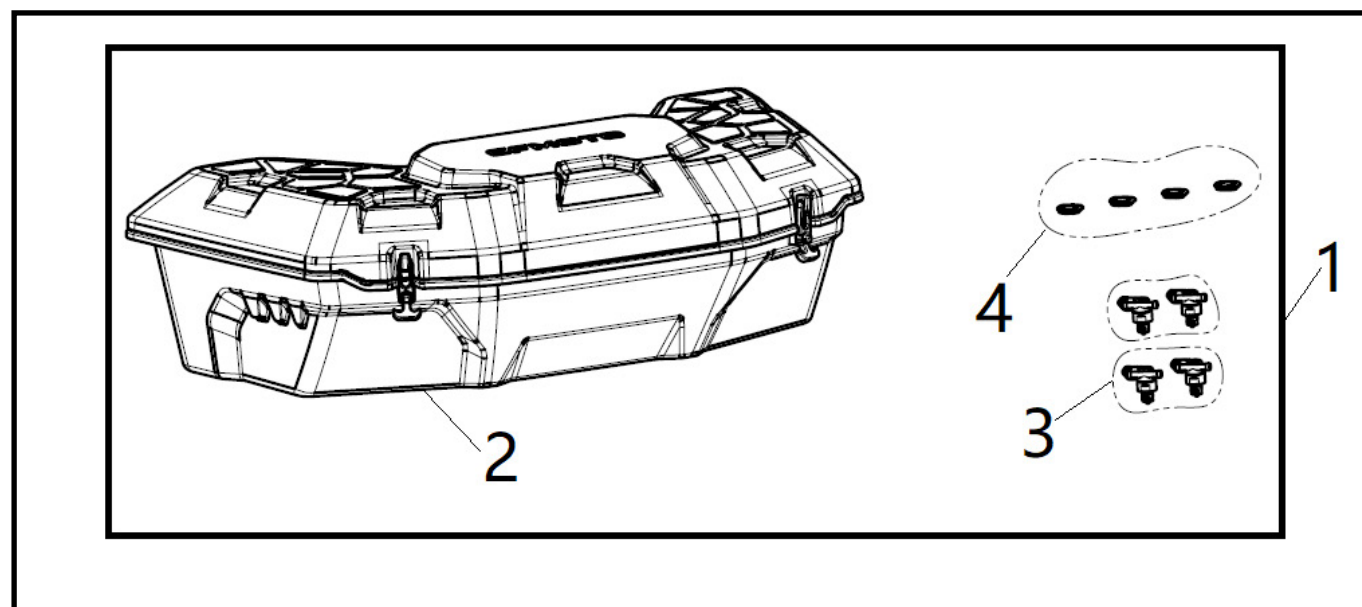

TOOL LIST:

ITEM	DESCRIPTION	QTY.	REMARK
1	4mm ALLEN WRENCH	1	Recommended tools

ASSEMBLY and INSTALLATION

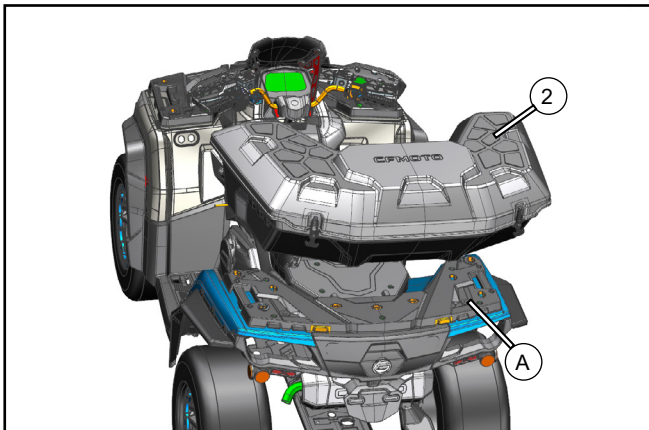

// Position the tail box (2) on the rear rack cover (A).

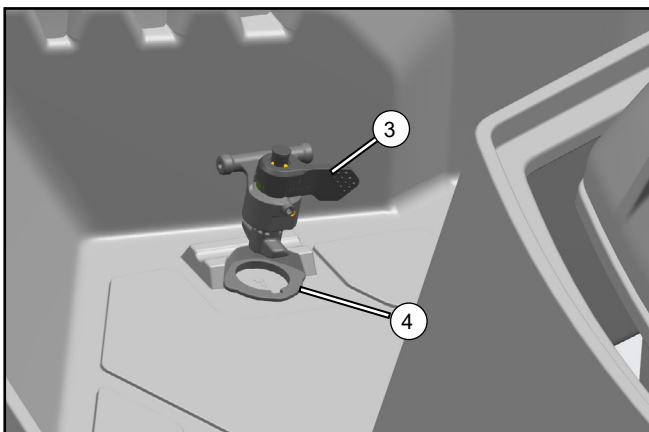

// Put the seal rings (4) and CF connect clamps (3) into the mounting hole of the tail box.

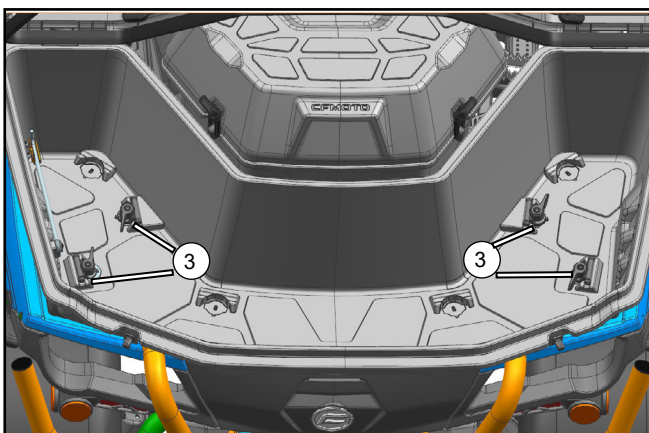

// As shown in the picture, install the four CF connect clamps (3) in the corresponding holes of the tail box, then secure the tail box by rotating the levers counter-clockwise.

i »The CF connect clamp can be adjusted by 4mm allen wrench.

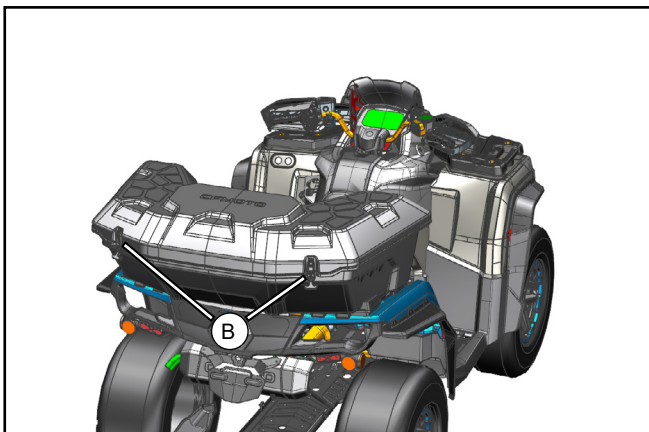

// Lock the latch (B).