



## ACCESSORY SETUP INSTRUCTION

### SNOW PLOW BRACKET ASSEMBLY -- PN 9AYV-804200-2000

VALID FOR: MY2021 CFORCE 800



**BEFORE YOU BEGIN:** Read and understand the instructions before starting any work. Make sure that all parts are ready and that you have all the tools required for assembly.

**NOTE:** CFMOTO shall not be liable for any damage caused by incorrect assembly. CFMOTO recommends that all original accessories be assembled by an authorized CFMOTO dealer.

Before assembly, park the vehicle on a flat surface, put the transmission gear into Park (P) and turn off the key switch.

**Zhejiang CFMOTO Power Co., Ltd.** All rights reserved. Reproduction of this document, even in part, as well as copying of all kinds, is permitted only with the express written permission of the copyright owner.

### MEANING OF SYMBOLS



- Indicates information with more details or tips.



- Indicates information of warning or danger.

### PARTS LIST:

ITEM	PART NAME	PART NUMBER	QTY.	REMARK
1	SNOW PLOW BRACKET ASSEMBLY	9AYV-804200-2000	1	
2	SNOW PLOW BRACKET	9AYV-804210-2000	1	
3	BOLT M10×30	9AYV-804200-2000-20	2	
4	BOLT M6×25	30006-060025870	2	

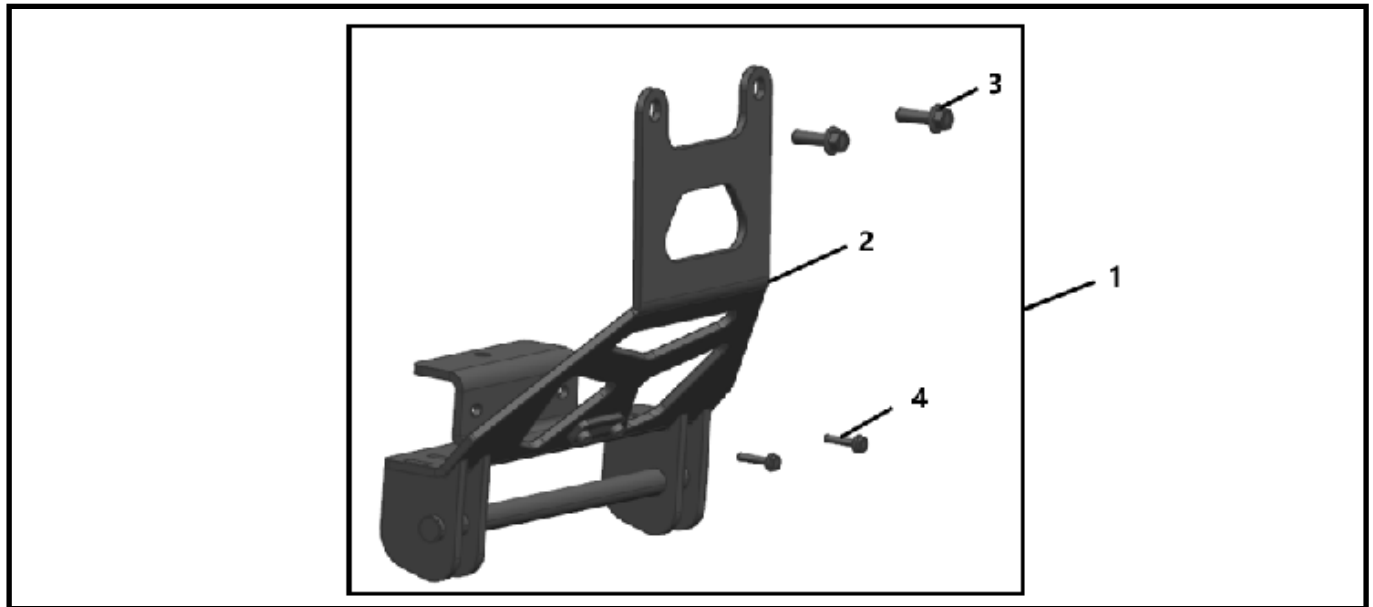

### TOOL LIST:

ITEM	DESCRIPTION	QTY.	REMARK
1	5s ALLEN WRENCH	1	Recommended tools
2	15mm SOCKET	1	
3	PEOTECTIVE GLOVES	1	

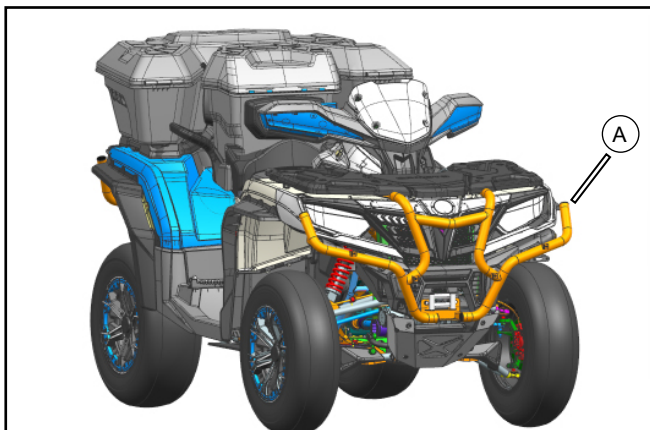

// Remove the front bumper (A).

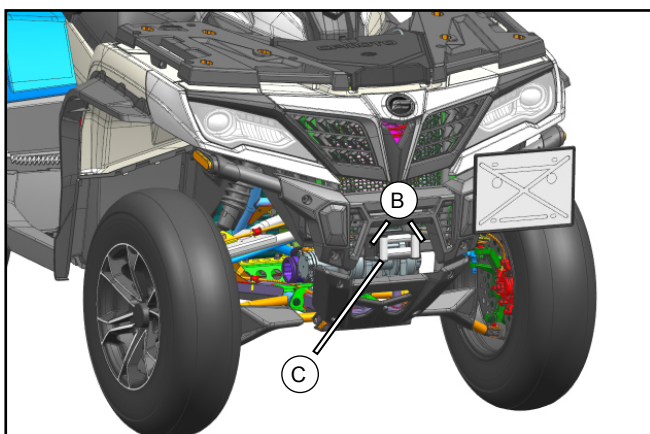

// Remove the bolts (B) and **tailer bracket (C)**.

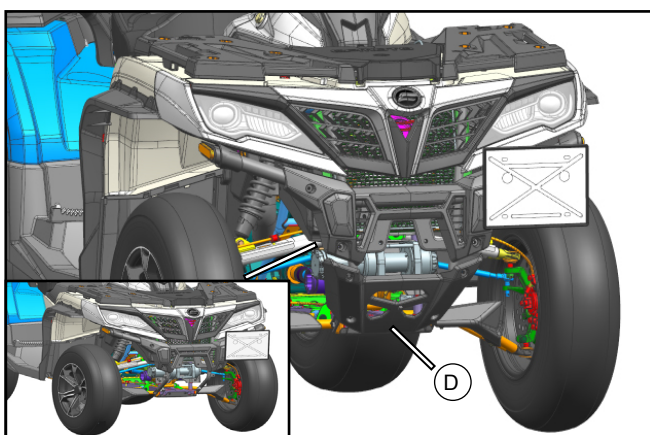

// After loosening the four screws, remove the front lower guard (D).

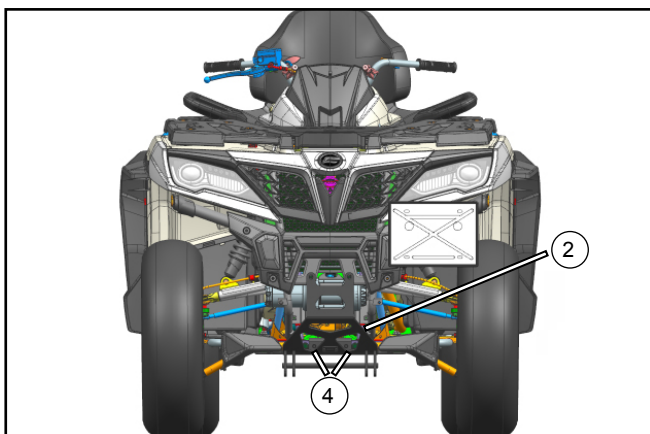

// **Place the snow plow bracket (4) at the fixing hole and fix it with the bolts (2).**

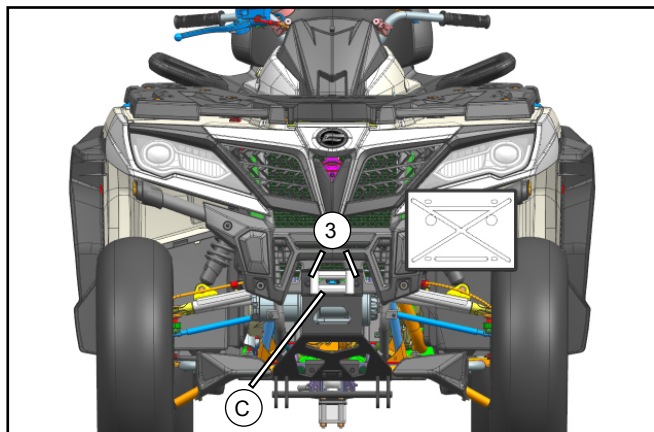

// Install the **tailer bracket (C)** and **fix it with bolts (3)**.

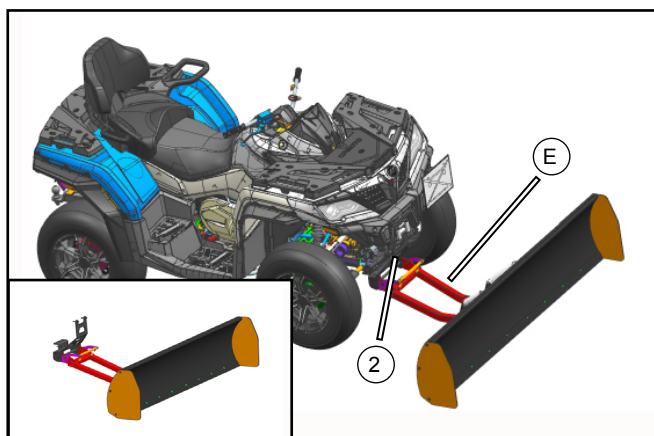

// Install the snow plow and push rod assembly (E) onto the snow plow bracket (2).