



ACCESSORY SETUP INSTRUCTION

CENTER MIRROR ASSY -- PN 5HY#-805600-1200

VALID FOR: MY2020 CF1000UU & CF1000UU-2

BEFORE YOU BEGIN: Read and understand the instructions before starting any work. Make sure that all parts are ready and that you have all the tools required for assembly.

NOTE: CFMOTO shall not be liable for any damage caused by incorrect assembly. CFMOTO recommends that all original accessories be assembled by an authorized CFMOTO dealer.

Before assembly, park the vehicle on a flat surface, put the transmission gear into Park (P) and turn off the key switch.

Zhejiang CFMOTO Power Co., Ltd. All rights reserved. Reproduction of this document, even in part, as well as copying of all kinds, is permitted only with the express written permission of the copyright owner.

MEANING OF SYMBOLS



- Indicates information with more details or tips.



- Indicates information of warning or danger.

PARTS LIST:

Item	PART NAME	PART NUMBER	QTY.	REMARK
1	CENTER MIRROR ASSY	5HY#-805600-1200	1	
2	CENTER MIRROR ASSY	5HY0-800600-10000	1	
3	SCREW M8x20	30102-080020810	2	
4	NUT M8	30204-080810	2	
5	RUBBER MAT	5HY0-800605	1	

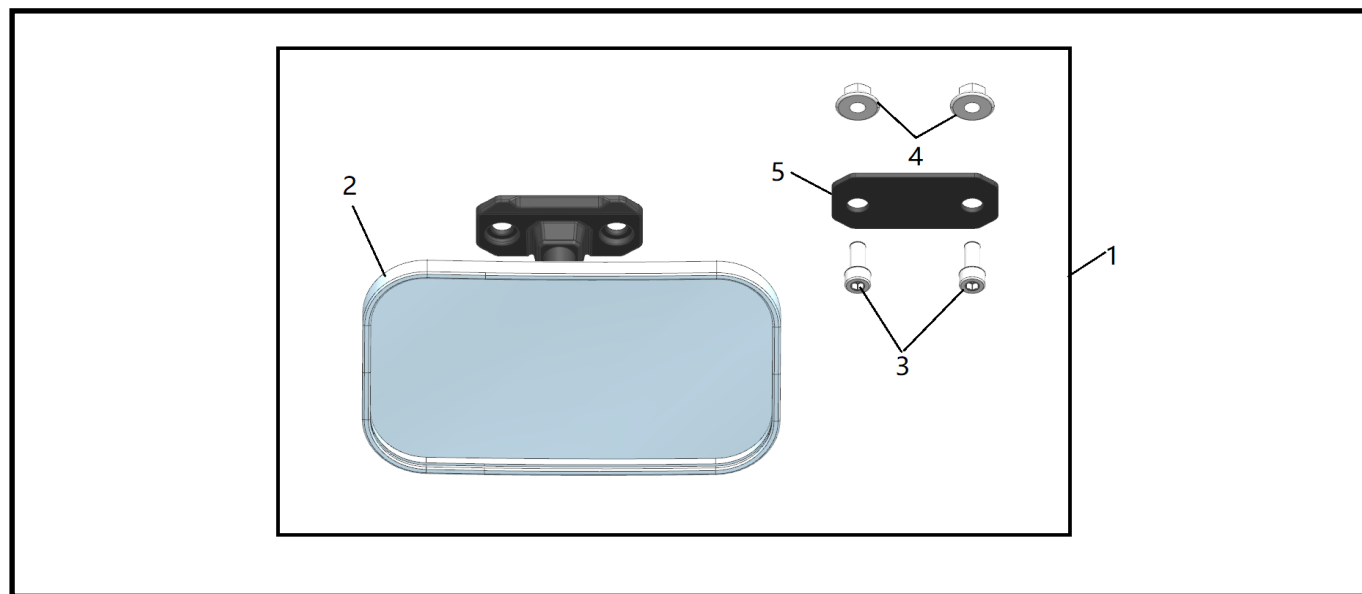

TOOL LIST:

ITEM	DESCRIPTION	QTY.	REMARK
1	13mm SOCKET	1	Recommended tools
2	5mm ALLEN WRENCH	1	
3	PROTECTIVE GLOVES	1	
4	PHILIPS SCREWDRIVER	1	



// Place the center mirror (2) in the assembly position with a rubber mat (5) at the bottom.

i » Pay attention to the direction of the mounting seat, and the part inside the red circle faces upward.



// Install the screws (3) and nuts (4).



// Torque the nuts (4) to specification.

NUT	M8	30204-080810	16-22N.m
-----	----	--------------	----------



// Adjust the visual angle of the center mirror.

i » There is a universal ball behind the center mirror. After adjustment, tighten the screw.